

# Tree Locations Plan

## Appendix G

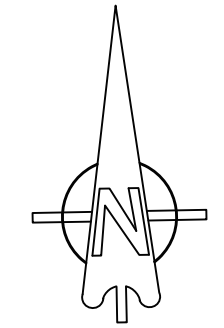

Commercial Grounds Care

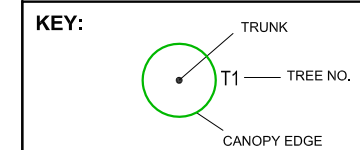

Client:	Epsom College Commercial Grounds Care Ltd
Site Address:	103 A, B, C & D College Road, Epsom, KT17 4HY
Title:	Tree Location Plan
Tree survey Ref:	00712-3-2023 - Appendix G
Based on:	OS plan
Date: 24-Sep-23	Drawn by: RG
Paper Size:	A3

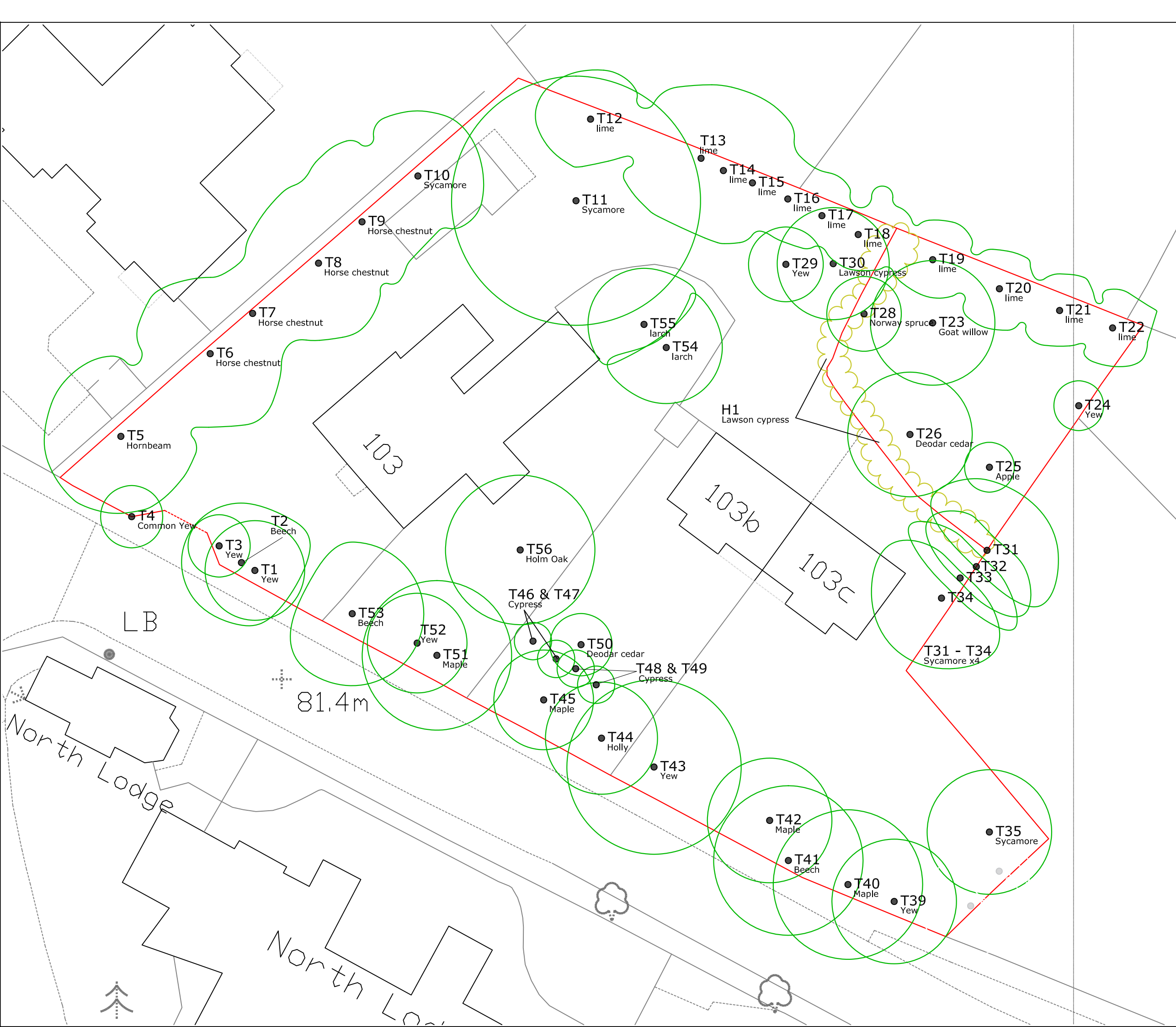

**APPENDIX G. – TREE SURVEY SCHEDULE** **Survey Site location: 103 (a, b, c, d) College Road, Epsom, KT17 4HY**

**Client Ref:** 00712-3-2023 **Tree Surveyor:** Rob Goode *Cert Arb RFS, Dip Arb L4* **Survey Date:** 4th – 7th September 2023

Tree ID	Species	Height Est(M)	Crown Spread Av(M)	Crown Clearance	Age class	Physiology	Structure	Observations	Works	Re-inspection	Work priority
T56	Holm Oak	22m	6m	2.5m	M	Good	Good	Tight unions, historic wounding at 0.5m on SE side historically removed limb at ground level on the west side; generally a tree of moderate condition	Overall crown reduction of 2.5m to reduce dominance over the rear garden	Sept 2024	6 months

