

EXISTING SCHOOL HOUSE ELEVATION FACING CHURCH ROAD ENTRANCE

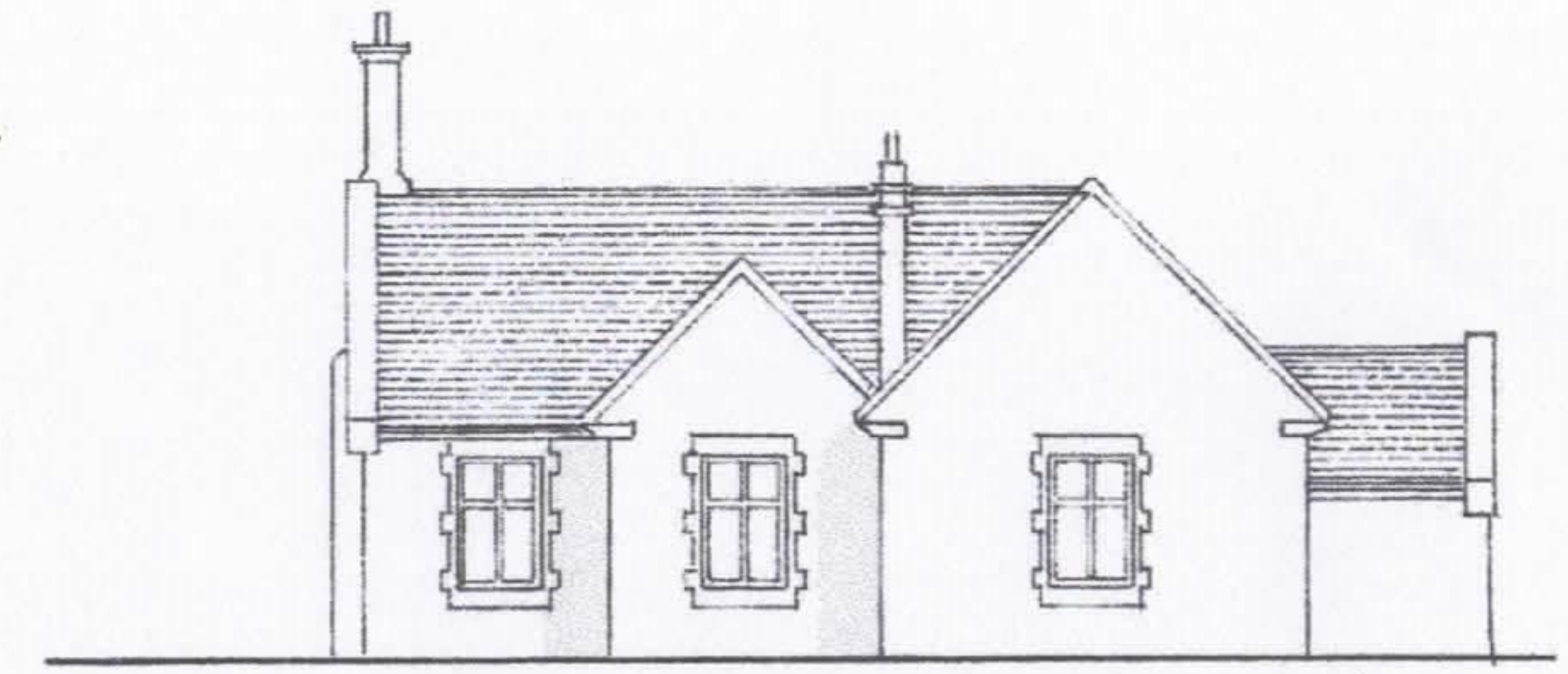

EXISTING SCHOOL HOUSE NORTH-FACING ELEVATION



EXISTING SCHOOL HOUSE WEST-FACING ELEVATION



EXISTING SCHOOL HOUSE ELEVATION FACING ASHFORD ROAD



PROPOSED SCHOOL HOUSE ELEVATION FACING CHURCH ROAD ENTRANCE

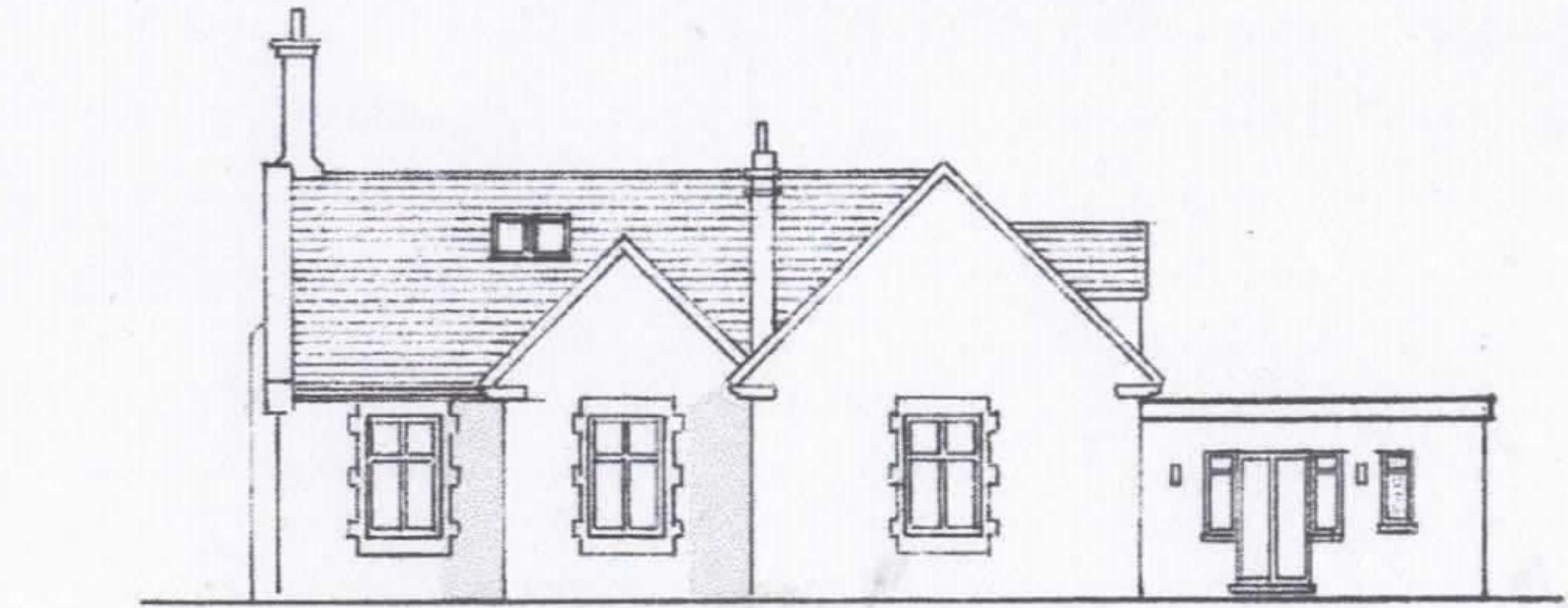

PROPOSED SCHOOL HOUSE NORTH-FACING ELEVATION

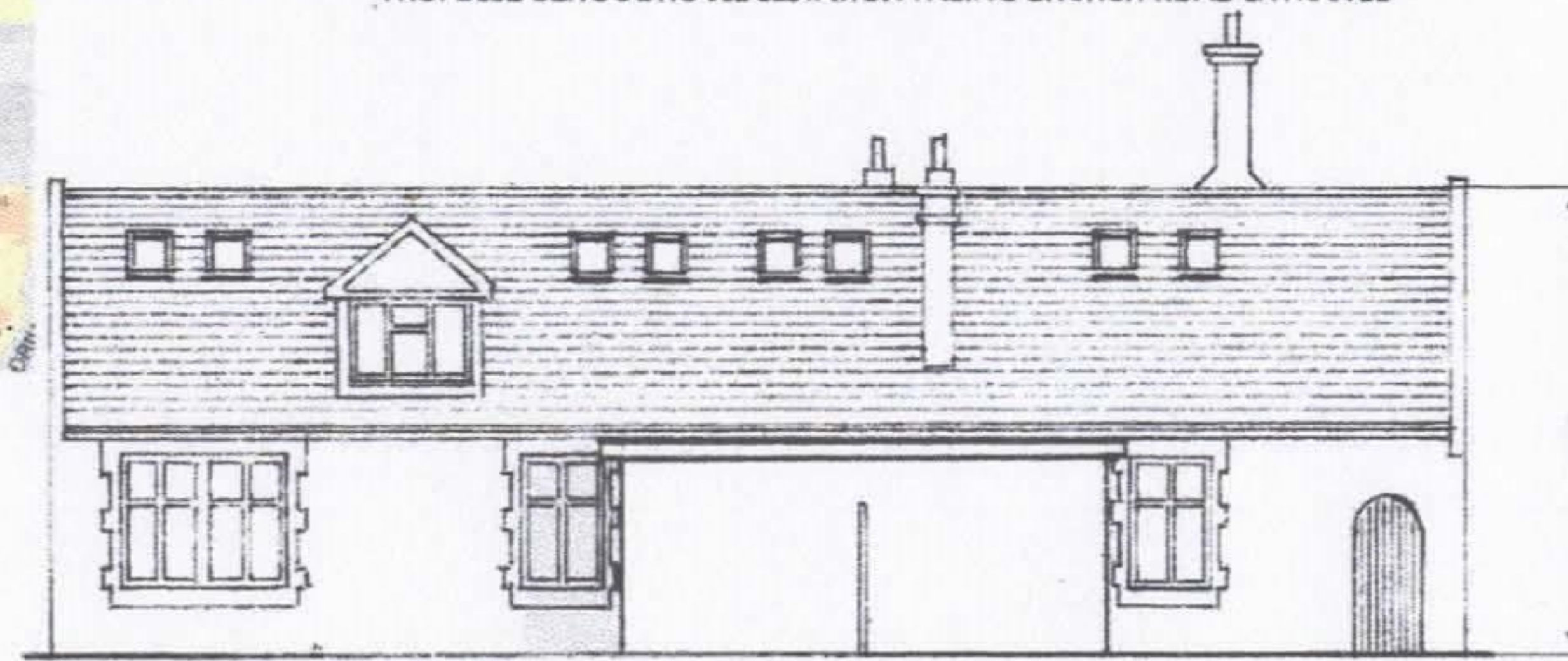

PROPOSED SCHOOL HOUSE WEST-FACING ELEVATION



PROPOSED SCHOOL HOUSE ELEVATION FACING ASHFORD ROAD



PLOT 3 ELEVATION FACING CHURCH ROAD

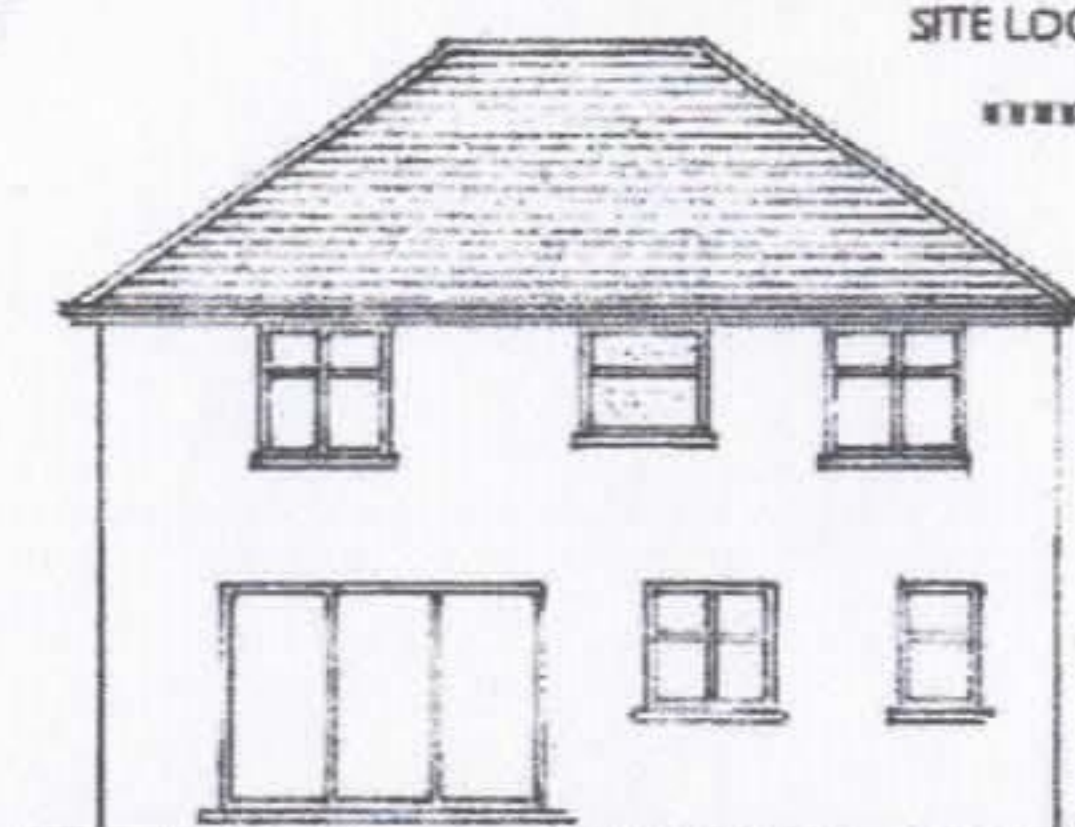

PLOT 3 WEST-FACING ELEVATION

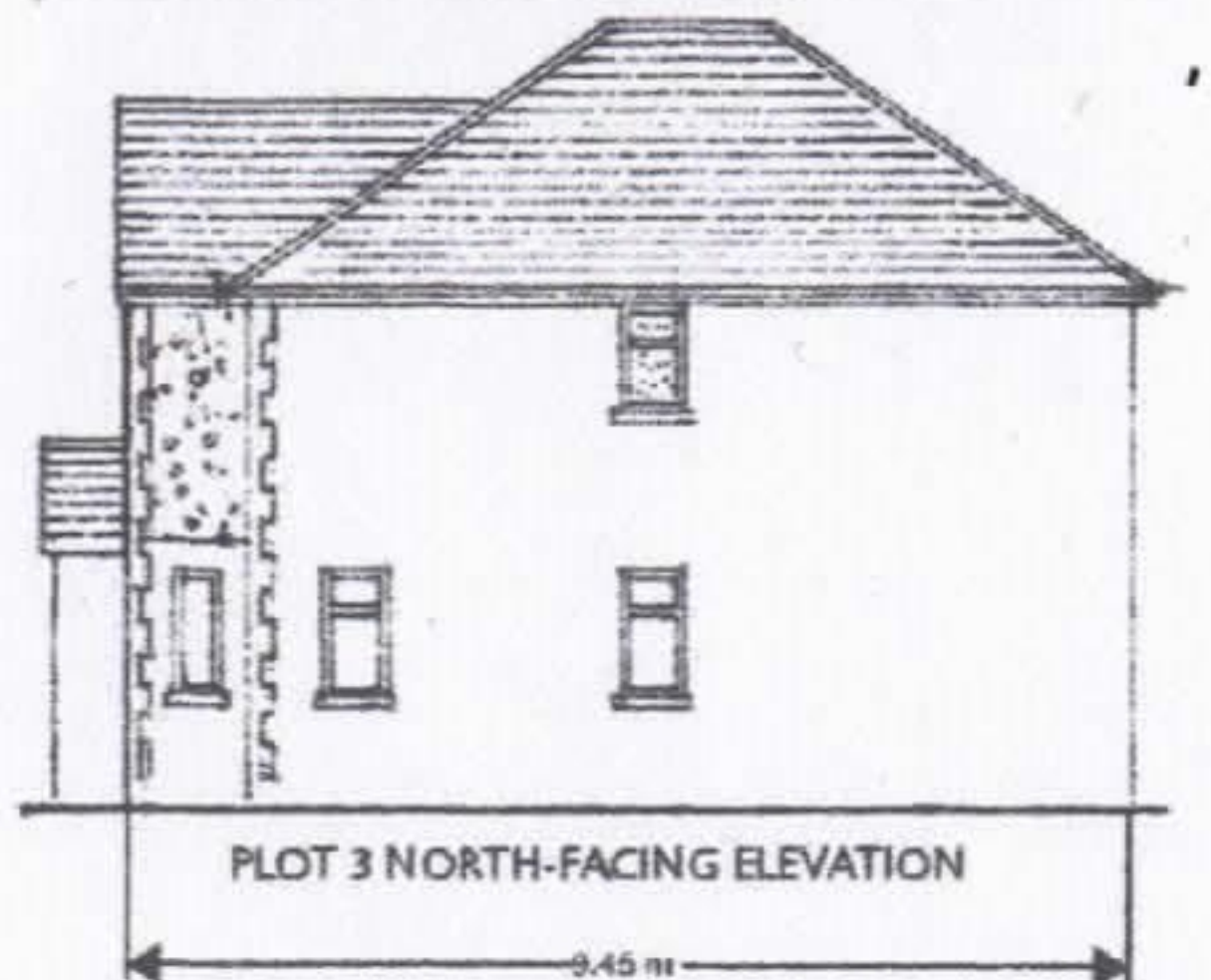

PLOT 3 NORTH-FACING ELEVATION

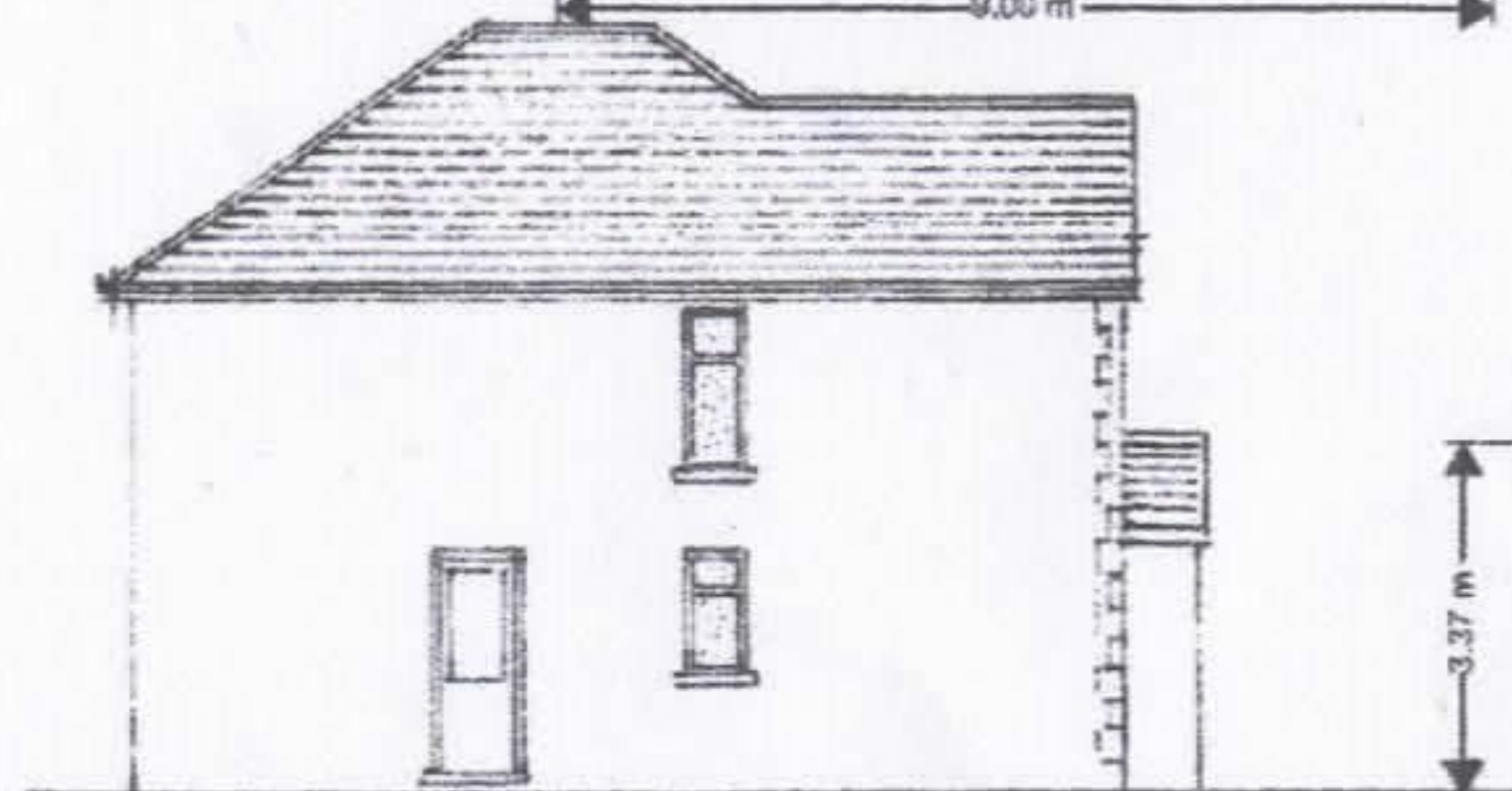

PLOT 3 SOUTH-FACING ELEVATION

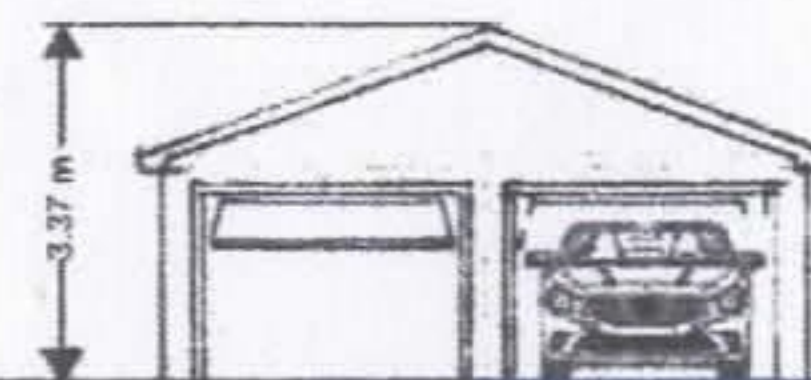

PLOT 3 DOUBLE GARAGE

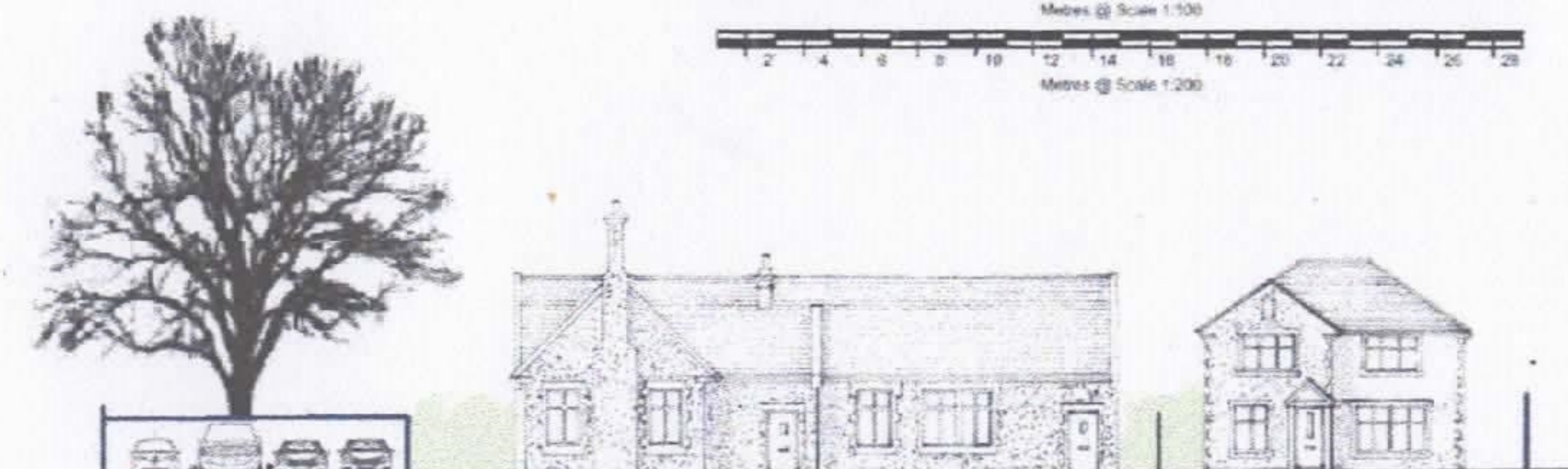

PROPOSED ELEVATIONS AS VIEWED FROM CHURCH ROAD @ 1:200

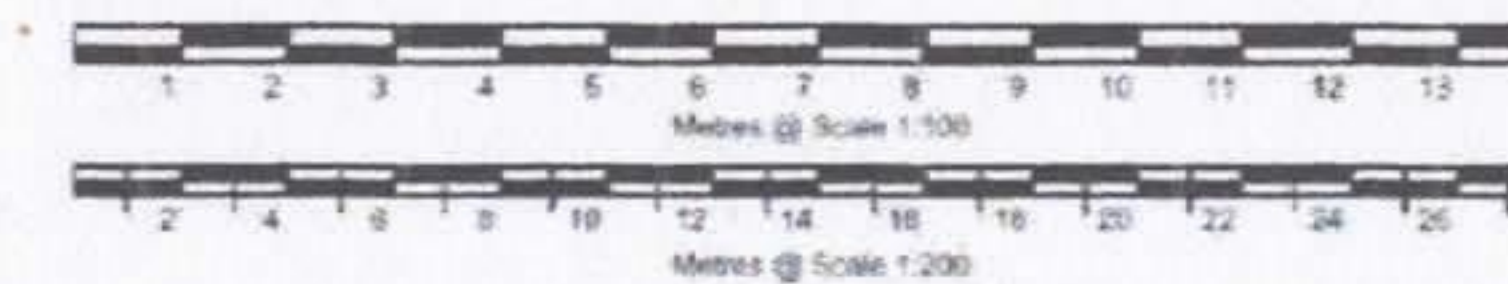

**REVISIONS:**

- B Planning scale bar added to location map existing opening indicated from Church Road

|   |   |
|---|---|
| <p><b>IDEA PLAN</b><br/>1 Ford Avenue, Bromley, Kent, BR1 3BU<br/>Tel: 0181 820 8164 Fax: 0181 820 8165<br/>www.dorplan.co.uk email: info@dorplan.co.uk</p> |   |
| Client:   | <b>Mr Khaleeqe</b>  |
| Job Title:  | Demolition of outbuilding and refurbishment of the School building to provide 2 No. three-bedroom semi-detached dwellings and construction of an additional four bedrooms detached house at Church Road, Haverington ME17 1AE |
| Drawing Title:  | Existing and proposed elevations, locations and proposed site plan  |
| Scale:  | 1:1250; 1:200 and 1:100   |
| Date:   | 20 February 2022  |
| Drawing Number:   | HARU 1  |
| Revision:   | B   |