

PROPOSED GROUND FLOOR PLAN (1:50)

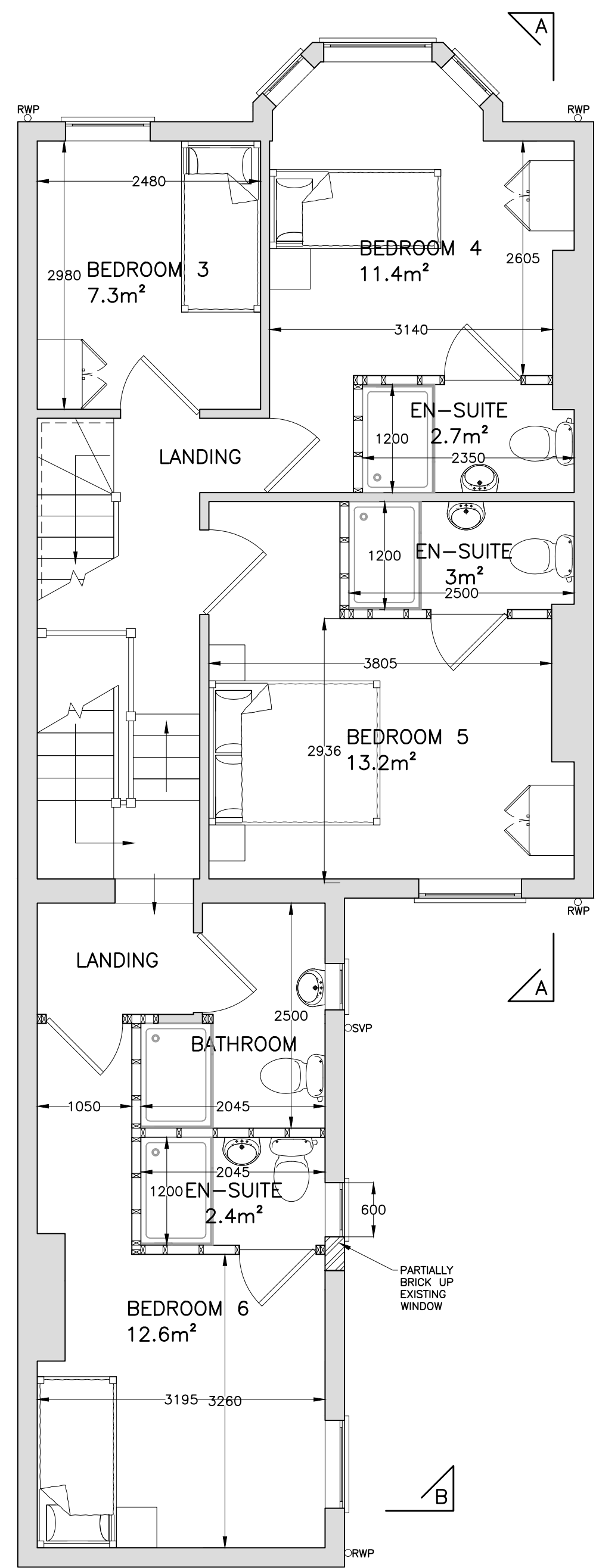

PROPOSED FIRST FLOOR PLAN (1:50)

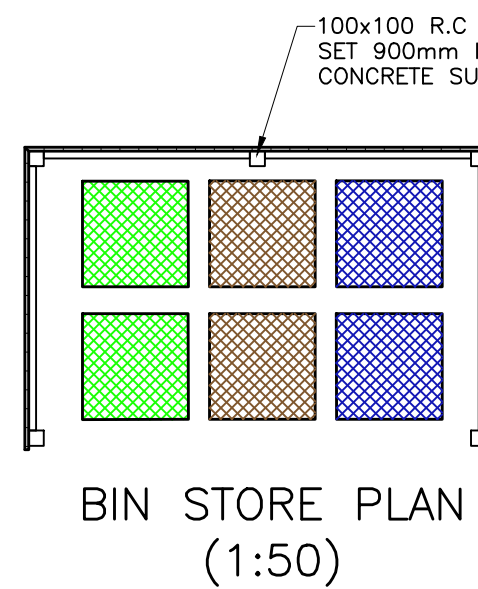

BIN STORE PLAN (1:50)

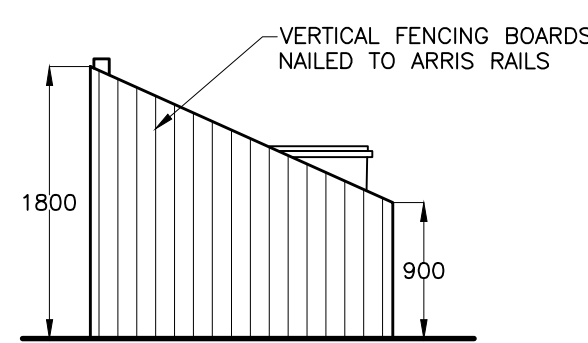

BIN STORE SIDE ELEVATION (1:50)

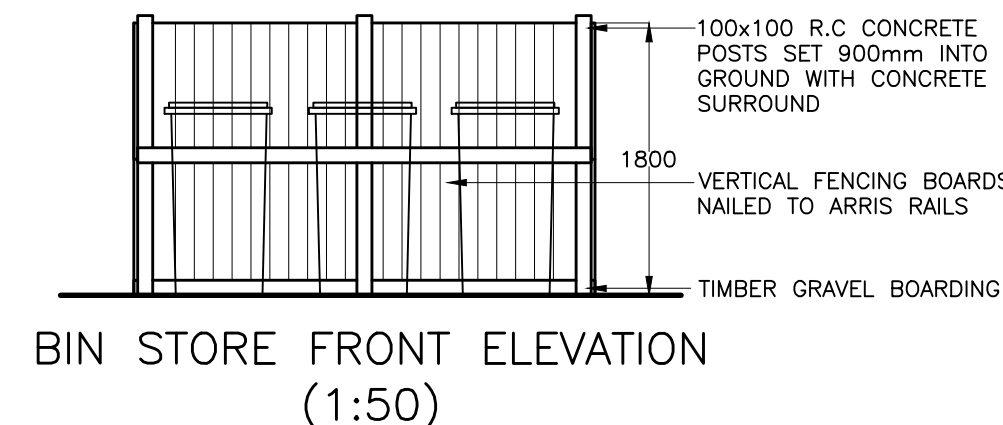

BIN STORE FRONT ELEVATION (1:50)

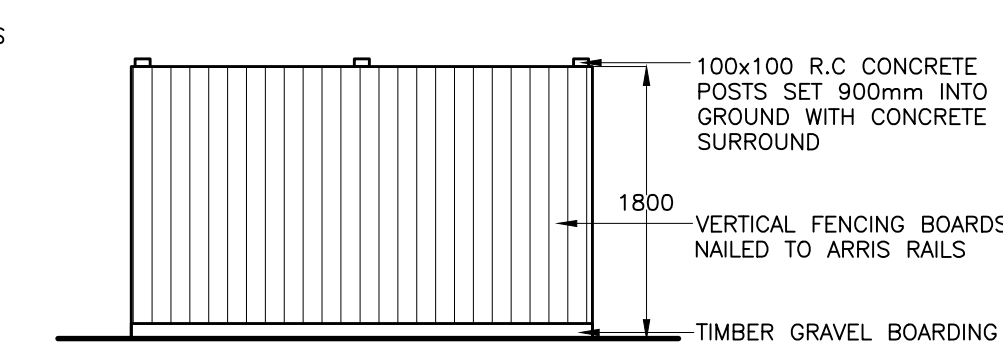

BIN STORE REAR ELEVATION (1:50)

LEGEND:

- EXISTING DWELLINGS
- PAVEMENT
- GRASS
- PERMEABLE BLOCK PAVING (NON SLIP)
- TARMAC
- GRAVEL
- SLAB PAVING
- WHEELIE BINS
- HEDGING
- VEGETATION

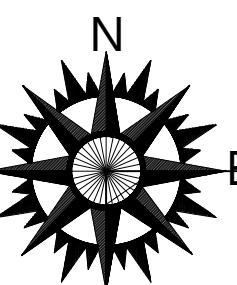

PROPOSED SECOND FLOOR PLAN (1:50)

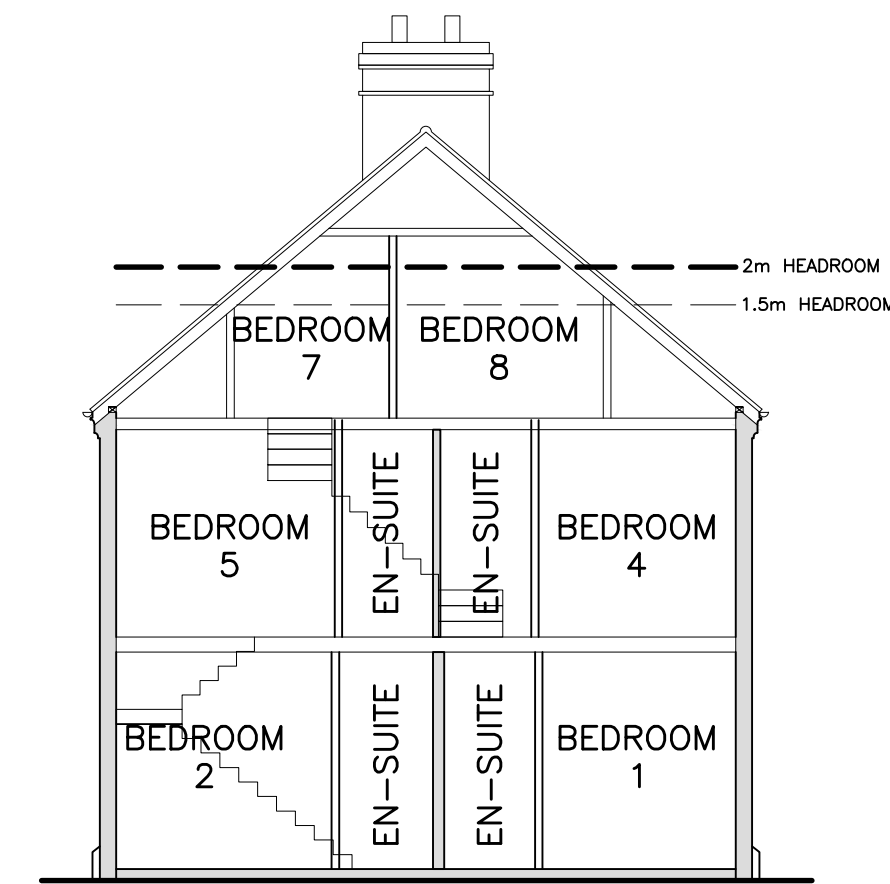
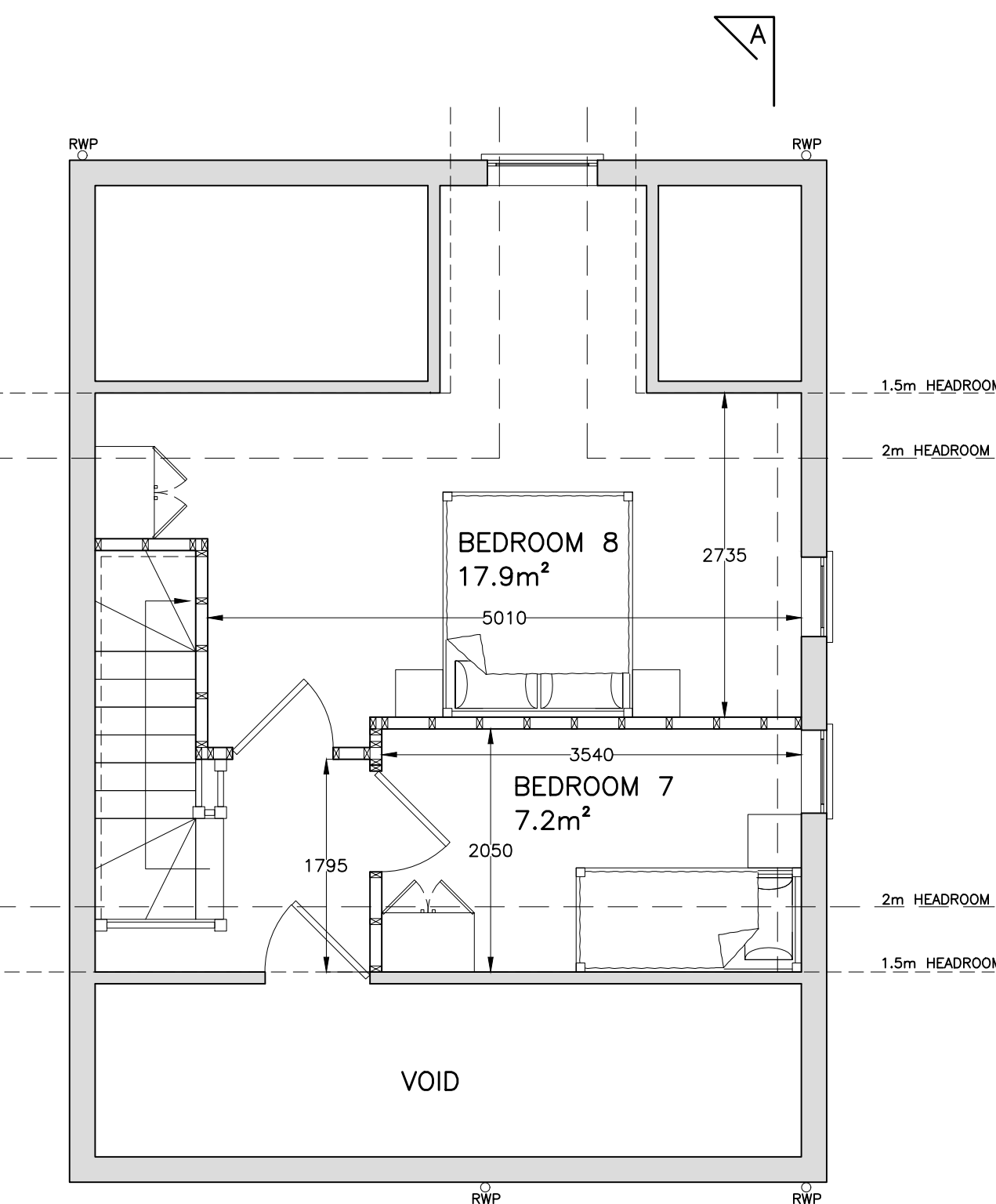

PROPOSED SECTION A-A (1:100)

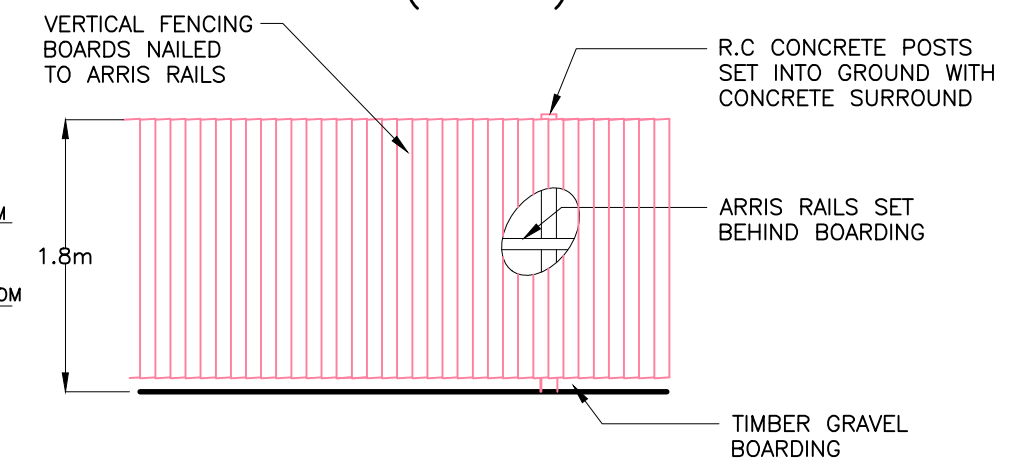

1.8m CBF DETAIL (1:50)

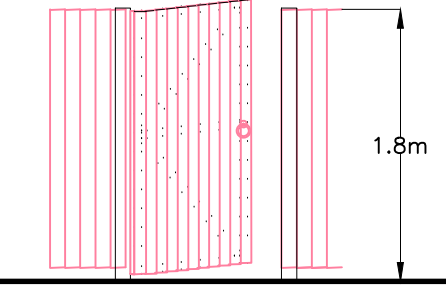

GATE DETAIL (1:50)

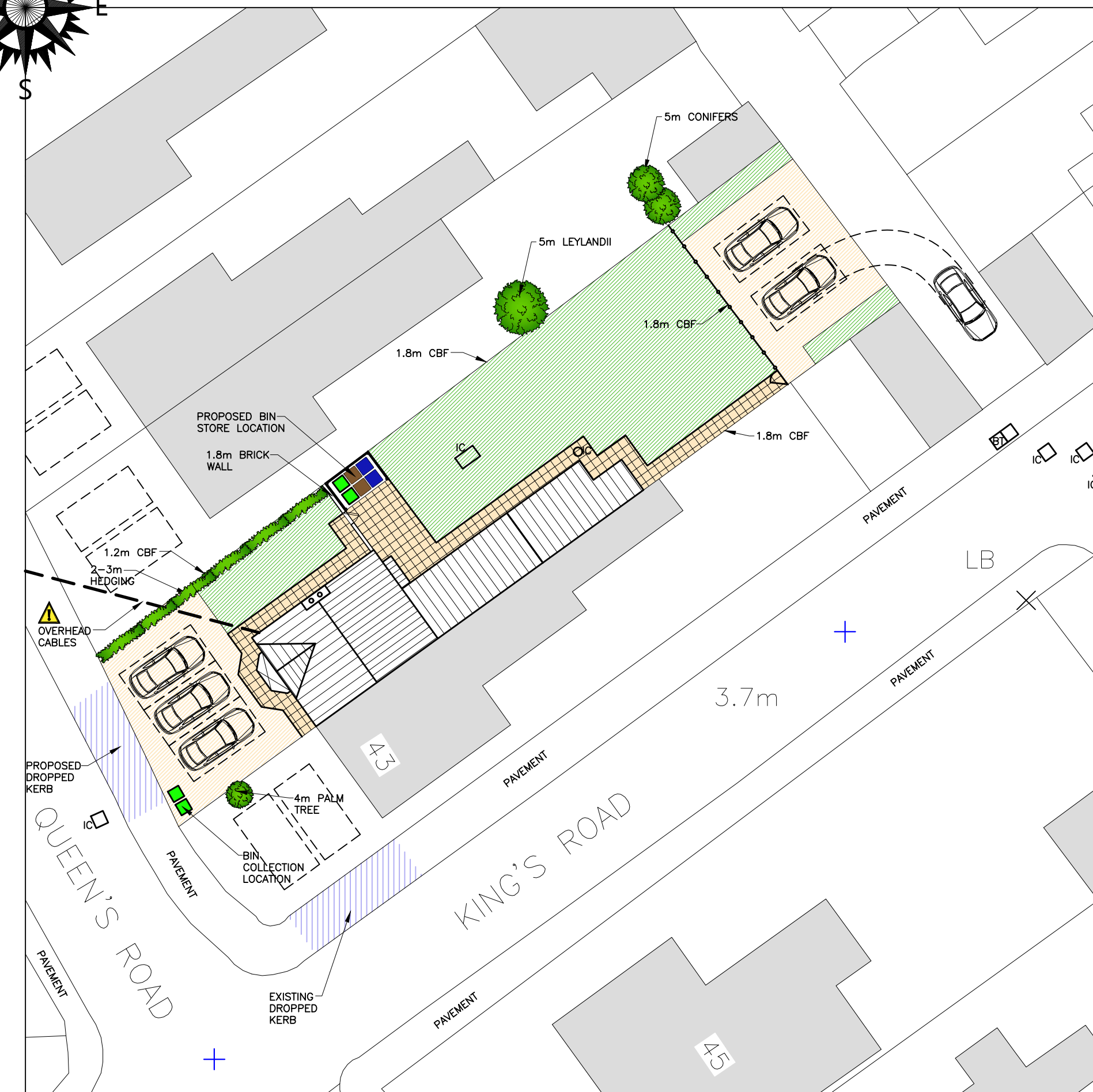

PROPOSED SITE PLAN (1:250)

Copyright on all drawings prepared by Morton & Hall Consulting Limited is their property. Drawings and designs may not be reproduced in part or in whole without their written permission.
Please read, if in doubt ask. Change nothing without consulting the Engineers.
Contractor to check all dimensions on site before work starts or materials are ordered. If in doubt ask. All dimensions are in mm unless stated otherwise.
Where materials, products and workmanship are not fully specified they are to be of the standard appropriate to the works and suitable for the purpose stated in or reasonably to be inferred from the drawings and specification. All work to be in accordance with good building practice and BS 8000 to the extent that the recommendations define the quality of the finished work. Materials products and workmanship to comply with all British Standards and EOTA standards with, where appropriate, BS or EC marks.
All products and materials to be handled, stored, prepared and used or fixed in accordance with the manufacturers current recommendations.
The contractor is to arrange inspections of the works by the BCO (or NHBC) as required by the Building Regulations and is to obtain completion certificate and forward to the Engineer
All finishes, insulation and damp-proofing to architect's details

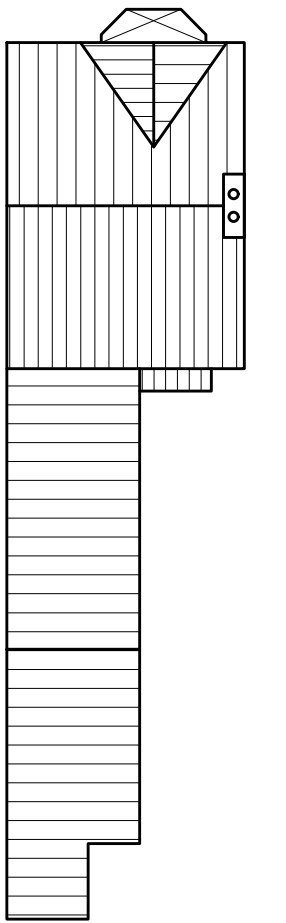

PROPOSED ROOF PLAN (1:200)

PLANNING DRAWINGS ONLY

B	PLANNERS COMMENTS	OCT 2023
A	CLIENTS COMMENTS	SEP 2023
	REVISIONS	DATE

MORTON & HALL CONSULTING LIMITED
CONSULTING STRUCTURAL ENGINEERS

1 Gordon Avenue, March, Cambridgeshire, PE15 8AJ
Tel: 01354 655454
Fax: 01354 660467
E-mail: info@mortonandhall.co.uk
Website: www.mortonconsultingengineers.co.uk

LAB Fenland District Council Building Design Awards
winner Building Excellence in Fenland

CLIENT
Barrett Properties

PROJECT
41 Queens Road
Wisbech
Cambridgeshire
PE13 2PE

TITLE
Proposed Plans, Section & Bin Store Arrangement

DRAWN G. Boreham	DATE OF ISSUE
CHECKED	
DATE Sep 2023	DRAWING NUMBER H9263/03 _B
SCALE As Shown	