

Roof finish - SARNAFIL G. PVC ROOF COVERING. BONDED TO LAYER OF FELT BONDED TO 160mm KINGSPAN ON LAYER OF FELT (VAPOUR CHECK) 25mm T&G BOARDING. 70-10 x 47mm TAPER PIECES ON 190 x 47mm FLAT ROOF JOISTS @ 600mm CTRS. DOUBLE JOISTS TO SIDE OF LANTERN & AS TRIMMER. 12.5mm DUPLEX PL'B'D CEILING.

SKYPOD PITCHED (35°) LANTERN ROOFLIGHT DOUBLE GLAZED. W. VALVE 1-2 W/M<sup>2</sup> K SET ON UPSTAND OF:- 97 x 47mm FRAMING WITH 80mm KINGSPAN BETWEEN WITH 25mm KINGSPAN & 12.5mm DUPLEX PL'B'D ON INSIDE & 9mm EXTERIOR GRADE PLY, LAYER OF FELT & 25mm KINGSPAN WITH SARNAFIL ROOF COVERING BONDED TO KINGSPAN WITH FELT.

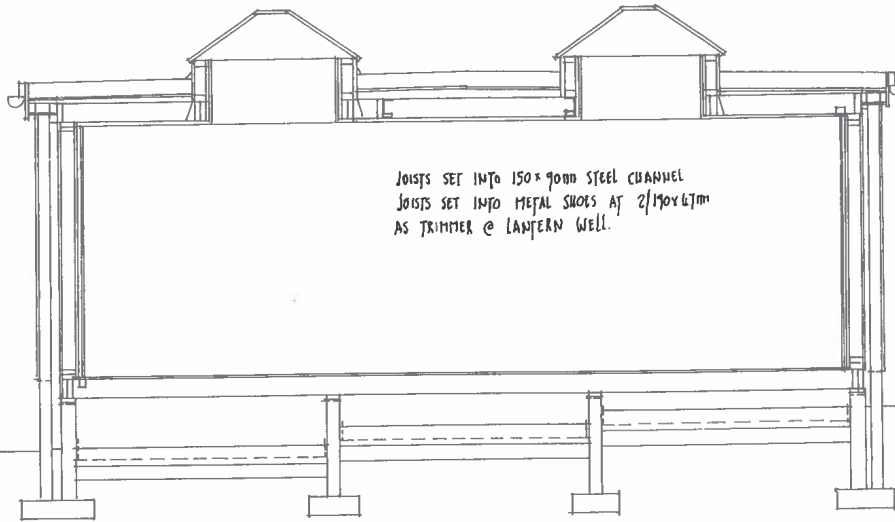

JOISTS SET INTO 150 x 90mm STEEL CHANNEL  
JOISTS SET INTO METAL SHOES AT 2/190 x 47mm AS TRIMMER @ LANTERN WELL.

SARNAFIL DRESSED OVER 70 x 45mm HW DRIP ON 21mm RW FASCIA  
97 x 47mm SPROCKET PIECES WITH 9mm EXT. GRADE PLY ON U/S  
ROCKWOOL OR EQUAL SHORT FIRE RESISTANCE CAVITY CLOSURE PIECE.

ROUGHCAST FINISHED ON ALUM.  
BELL-CAST BEAD & DPC LEV.  
FACING BRICK BASECOURSE TO MATCH EXISTING.

GF FLOOR:- 22mm T&G MOISTURE RESISTANT FLOORING GRADE CHIPBOARD ON 175 x 47mm JOISTS @ 600mm CTRS. JOISTS ON 25mm THICK TREATED WALLPLATE & DPC. NETLON ON U/S OF JOISTS. 170mm KINGSPAN BETWEEN JOISTS.

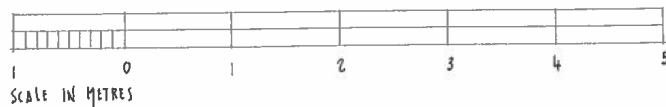

No.5 LEAD FLASHING ON UNDERLAY & 150 x 21mm FLASHING PLATE. LEAD OVER SARNAFIL.

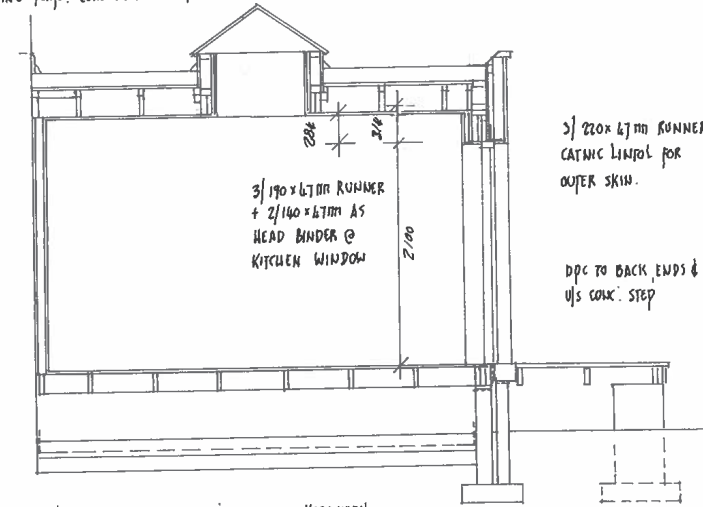

3/190 x 47mm RUNNER + 2/140 x 47mm AS HEAD BINDER @ KITCHEN WINDOW

3/220 x 47mm RUNNERS CATING LINTEL FOR OUTER SKIN.

DPC TO BACK ENDS & U/S CONC. STEP

SOLUH:- 100mm SITE CONC. ON 1000g VISQUEEN LAPPED 150mm @ EDGES & TURNED UP WALLS. 50mm SAND BLINDING TO 150mm BOTTOMING.

SECTION B

5 LINTIE CROFT, FORFAR.  
DRG. No:- 5001/4 SCALE:- 1:50 @ A3.