

General Notes

The copyright of this drawing belongs to Mlp Design, and shall not be used or reproduced in any form without its express written permission.

Do not scale from this drawing - work to the figured dimensions only. All dimensions to be checked on-site prior to the commencement of any work.

Where any discrepancy is found to exist within or between drawings and/or documents and site, it should be reported to the client and Mlp Design immediately.

Drawing is to be read in conjunction with any structural engineers reports.

Floor plan measurements are approximate and are for illustrative purposes only. While we do not doubt the floor plans accuracy, we make no guarantee or representation as to the accuracy and the completeness of the floor plan and associated area measurements.

© Mlp Design 2023.

Drawing Notes

New stairs down to first floor from second floor

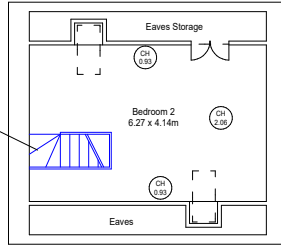

SECOND FLOOR
Approx Gross Internal Area: 26.0 m² - 280 ft²
(Excluding Eaves)

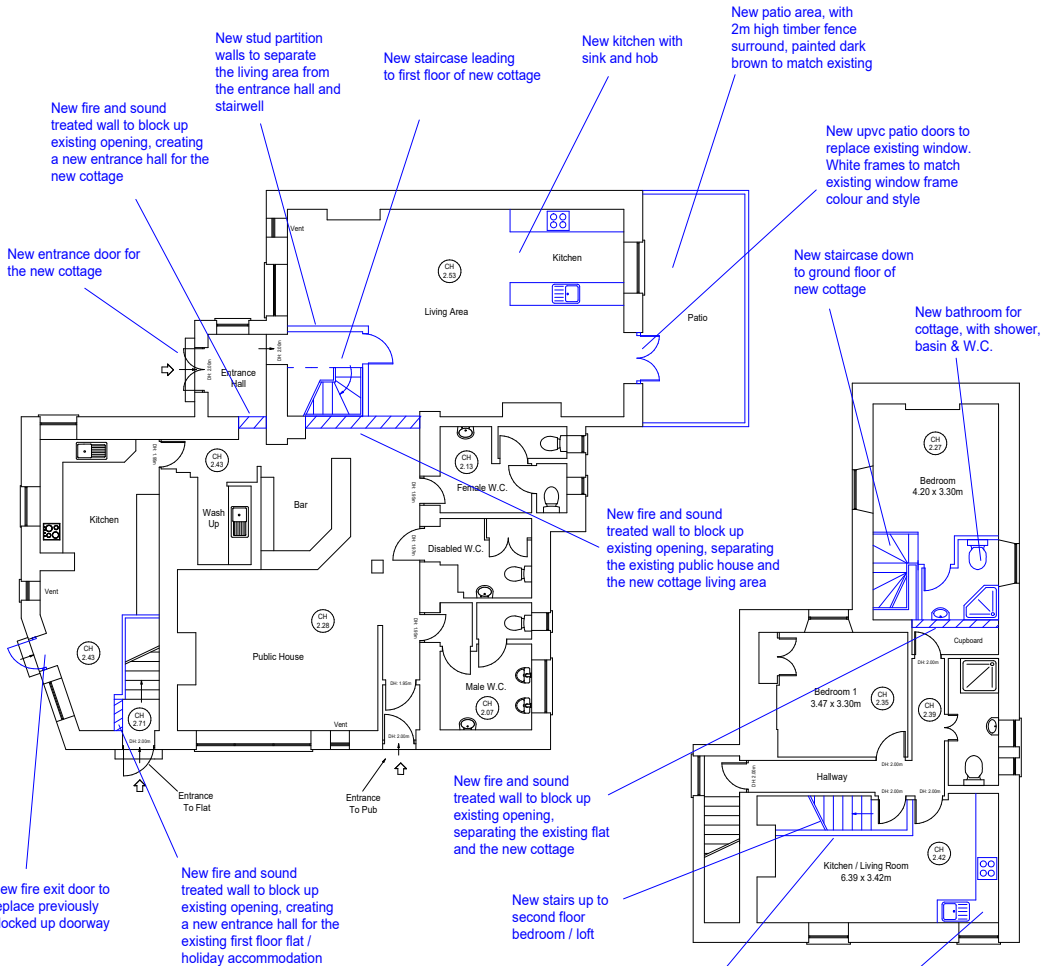

GROUND FLOOR
Approx Gross Internal Area: 159.6 m² - 1,718 ft²

FIRST FLOOR
Approx Gross Internal Area: 75.1 m² - 808 ft²



mlpdesign

Jaclin House | 24 Hood Street | Manchester | M4 6WX
0345 257 4121 - info@mlpdesign.co.uk - www.mlpdesign.co.uk

Project Address
THE BLACKSMITHS ARMS
LOW PITTINGTON
DURHAM
DH6 1BJ

Project Brief
PROVIDE PLANNING PLANS

Drawing Title
PROPOSED FLOOR PLAN

Drawing No. 2864 - FP - 01	Revision A
-------------------------------	---------------

Drawn NR	Issue Date 01 / 06 / 2023
-------------	------------------------------

Client PRIVATE	Scale 1 - 200 @ A4
-------------------	-----------------------