



© COPYRIGHT APS LTD. ALL RIGHTS RESERVED. THIS DRAWING MAY NOT BE COPIED OR RE-USED IN WHOLE OR IN PART, WITHOUT THE WRITTEN CONSENT OF APS LTD.

SCALING FOR REFERENCE ONLY. WRITTEN DIMENSIONS SHALL GOVERN

GENERAL NOTES

THIS DRAWING MUST BE READ IN CONJUNCTION WITH ALL OTHER RELEVANT ASSOCIATED DRAWINGS & DOCUMENTS SPECIFICALLY PREPARED FOR THIS PROJECT, INCLUDING: DETAILS & CALCULATIONS BY STRUCTURAL ENGINEERS; ENERGY (SAP) ASSESSORS; & ALL OTHER EXTERNAL CONSULTANTS, & OTHER PARTICULAR SITE SPECIFICATIONS. TO VIEW ALL INFORMATION ACCURATELY, THIS DRAWING IS TO BE PRINTED AS SEEN ON SCREEN PDF WITH ALL DWG. PLOT STYLES (COLOURED/SHADED WHERE APPLICABLE) DISPLAYED

THIS DRAWING IS FOR GENERAL REFERENCE AND THE PURPOSES OF OBTAINING LOCAL AUTHORITY OR APPROVED INSPECTORATE APPROVALS ONLY. THIS IS NOT A WORKING DRAWING. ALL FINAL DIMENSIONS MUST BE DETERMINED ON SITE AT THE SETTING OUT STAGE OF THE WORKS. DISCREPANCIES ARE LIKELY, AND IF NECESSARY ARE TO BE VERIFIED WITH CLIENT/AGENT BEFORE WORK PROCEEDS. IT IS THE RESPONSIBILITY OF THE CLIENT AND THE APPOINTED BUILDING CONTRACTOR TO OBSERVE ALL RELEVANT HEALTH AND SAFETY RULES INCLUDING THE CONSTRUCTION (DESIGN & MANAGEMENT) REGULATIONS, THE PARTY WALL ACT, THE CONSTRUCTION ACT, ALL AS APPLICABLE

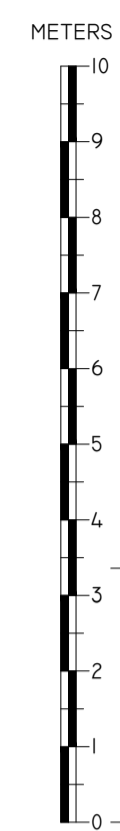

FRONT ELEVATION



REAR ELEVATION

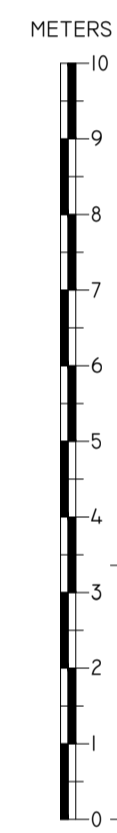

SIDE ELEVATION A



SIDE ELEVATION B

REV	BY	DATE	DESCRIPTION
REVISIONS / AMENDMENTS			

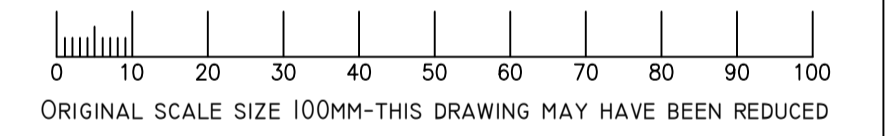

CLIENT: MR CONRAD STURT

SITE: SHAPLEY HEATH, ODIHAM ROAD, WINCHFIELD RG27 8BU

PROJECT: TWO STOREY EXTENSION TO REAR REAR + INTERNAL ALTERATIONS

DWG. TITLE: EXISTING ELEVATIONS + SITE LOCATION PLAN

DWG. STATUS: AS EXISTING

DWG. No. P700/11/02 REVISION:

DRAWN BY: PA DATE: SEPTEMBER 2023

CHECKED BY: CS DATE: SEPTEMBER 2023

SCALE: 1:100 & AS NOTED @ AI

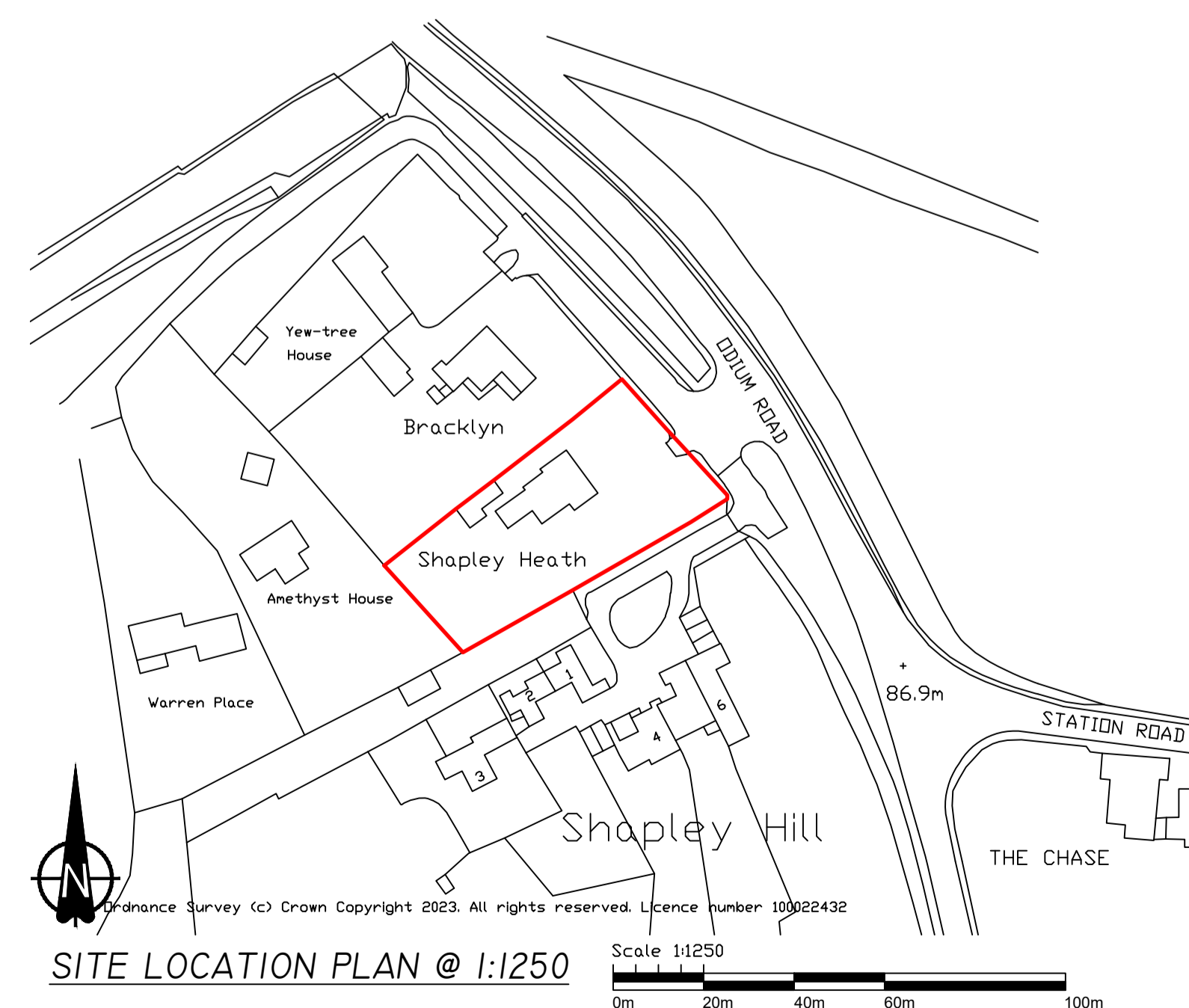

SITE LOCATION PLAN @ 1:1250

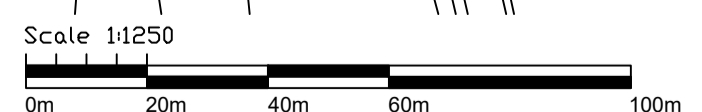

Ordnance Survey (c) Crown Copyright 2023. All rights reserved. Licence number 100022432

**AVON PROJECT SERVICES**  
 Building Design & Technology  
 3 Wren Close, Hightown, Ringwood, Hants, BH24 3RF  
 Tel/Fax: 01425 472217  
 Web: avonserve.com e: info@avonserve.com