

**Potential PV Locations**

- ZONE 1 - South of Main Hotel  
 - View towards garden interrupted by solar panels thus being detrimental to the setting of the Listed Building
- ZONE 2 - Main Hotel  
 - Solar panels cannot be installed on Grade I listed buildings
- ZONE 3 - North of Main Hotel  
 - Impeded view from Stonehouse Court Hotel by solar panels
- ZONE 4 - Caroline Gardens to the East  
 - Site already allocated for the Caroline Bedroom Project
- ZONE 5  
 - Desirable location for solar panel installation utilising an existing roof that needs replacing

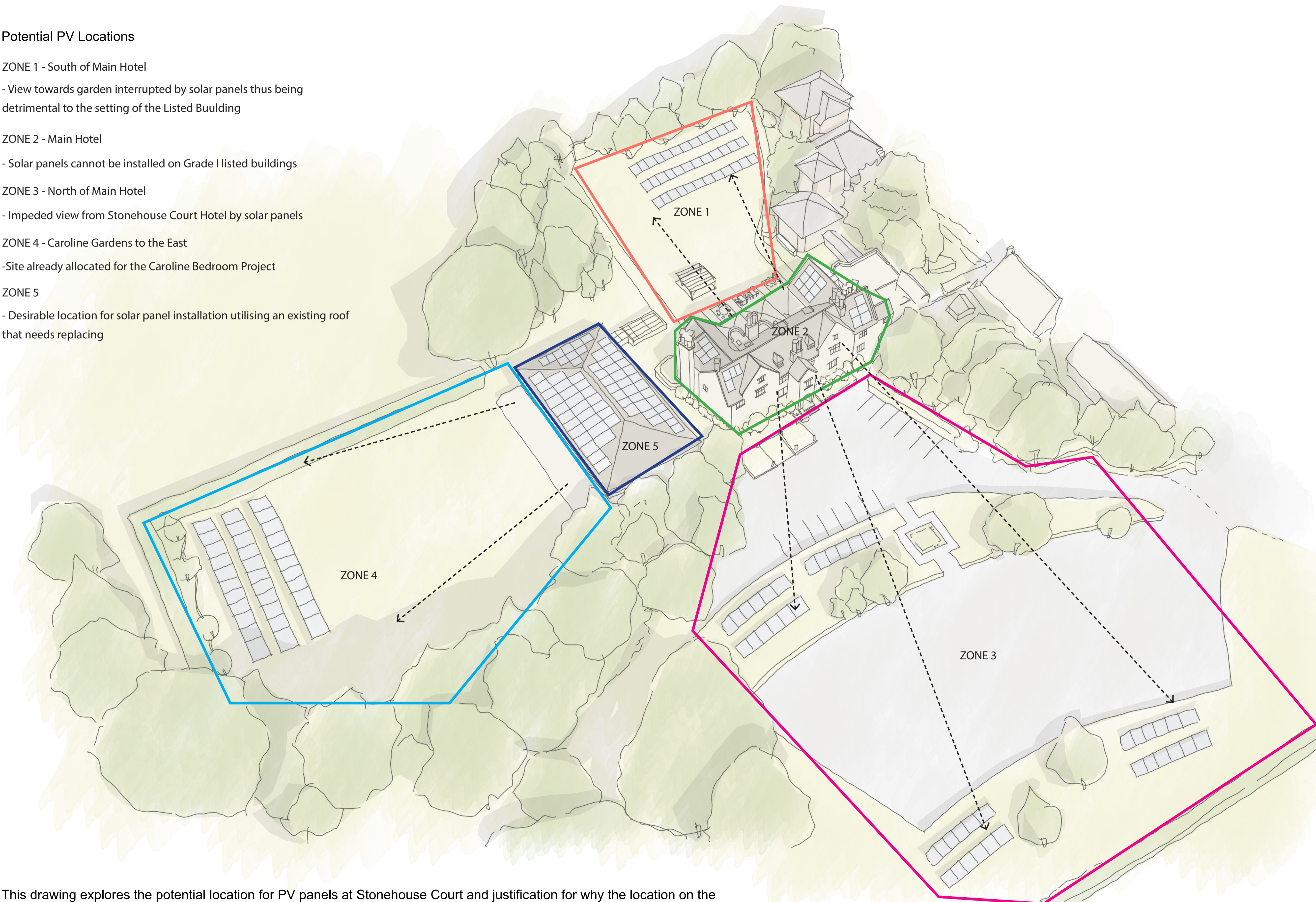

This drawing explores the potential location for PV panels at Stonehouse Court and justification for why the location on the Caroline Suite has been selected