

PARENT CONSENTS:

Removal of external stack DC/23/02119 (HH) and DC/23/02120 (LBC)
removal and making good of external chimney stack

Internal Alterations to facilitate new kitchen DC/23/02761 (LBC)
includes internals of fireplace and hearth

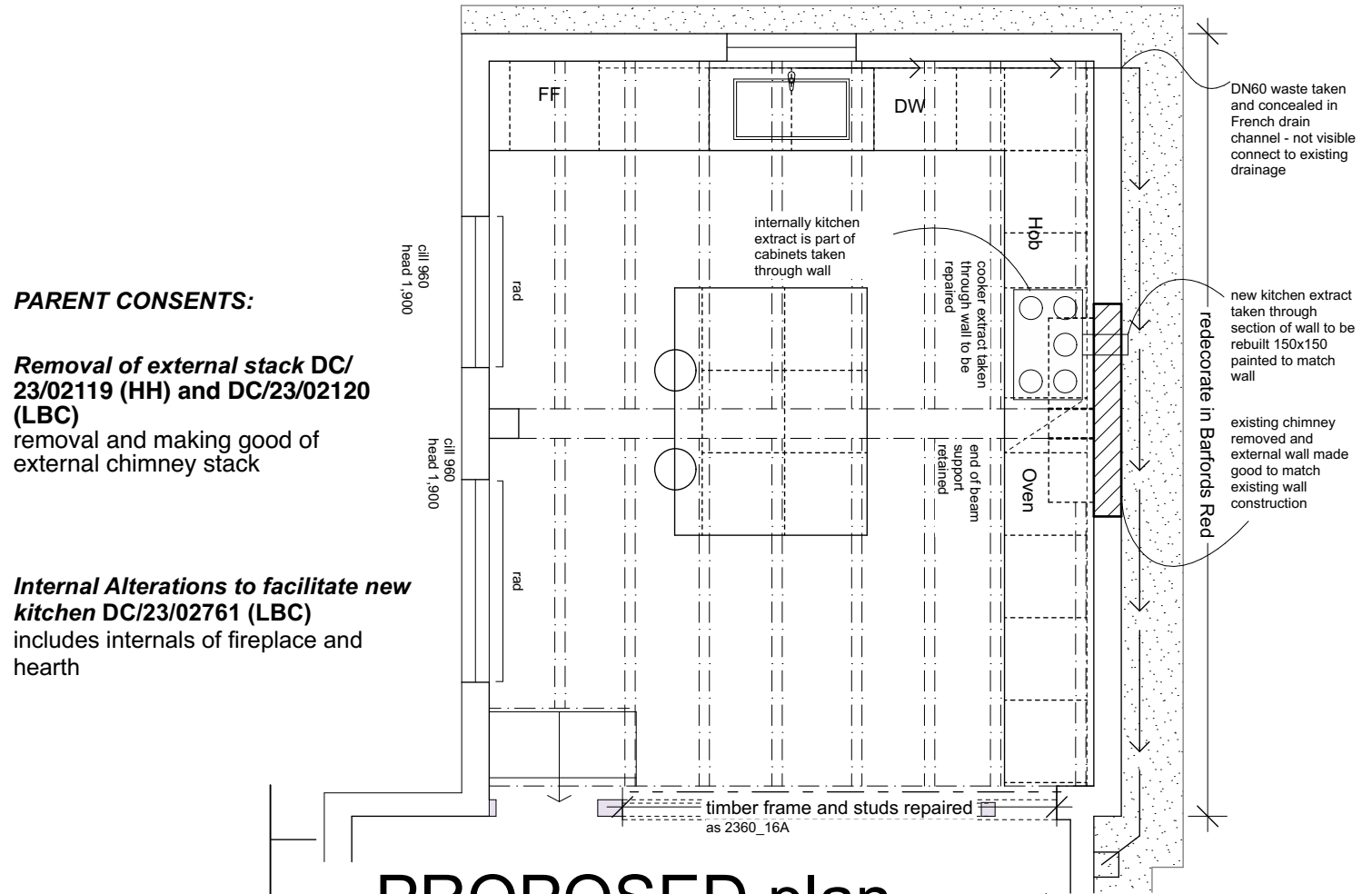

PROPOSED plan

make good to match existing Hargreaves cast iron half round gutter and clips to match existing profile section

Repair existing roof carried out using

nom 6 No clay pantiles

Held on site and stored from the same batch as the roof for maintenance and repairs

render repairs to make good to existing render

render on metal lath
breather membrane
timber stud frame 150mmx50 with full fill Dritherm 32 insulation

internally airtight layer plasterboard and skim

New kitchen extract taken through reinstated section of wall painted to match wall colour

infill to brick plinth using flettons saved from chimney stack (these are the exact match to the plinth adjacent on either side)

make new low level opening for DN60 waste for sink above wall plate. Drainage run to be laid to falls towards existing outlet in the existing French drain trench and backfilled over with pea shingle. Not visible, no excavation required.

lime render Colour 'Barfords Red'

existing drainage

repaint in Ingliby's Barfords Red 09111.N
2 coats Pozzillime Limewash.
Colour 'Barfords Red'

PROPOSED rear (north elevation)

project: Barfords Donkey Lane, IP29 4QU	drawing ID: 2360_17 Materials and Ventilation
drawn by: sjs date: 24.10.23	scale: 1:50@A4

rev:

notes:

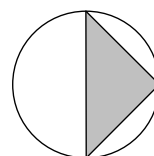

John Stebbing Architects

Unit2b Barton Road Retail Park Bury St Edmunds IP32 7BE
01284 704546 johnstebbing@architectatwork.co.uk www.architectatwork.co.uk