

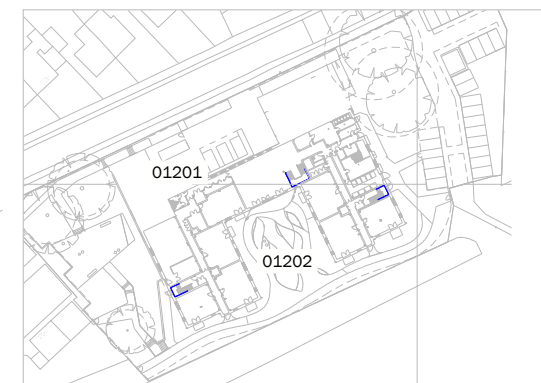

- LEGEND**
- Red line boundary
 - Indicative root barrier to proposed trees
 - Existing vegetation to be retained
 - Proposed tree
 - Existing vegetation to be retained /made good
 - Proposed hedging
 - Proposed ornamental planting bed
 - Proposed seeded wildflower Emorsgate seeds EM3
 - Proposed specimen planting
 - Proposed bulb planting



Location Plan - Not to Scale

0 1 2 5 10m
Scale in metres

Rev	Date	Description	Drn
P04	05.09.23	Revised to new drainage layout	IM
P03	11.08.23	First issue	IM
P02	14.07.23	First issue	IM
P01	10.07.23	First issue	IM

Title: | Planting Plan - Sheet 2 - Courtyard

Project: | Hearnden Court, Wellingborough

Client: | ARJ Construction

Date: | March 2023

Scale: | 1:200@ A3

Drawing No: | J6477-LLA-90-ZZ-00-D-L-01202

Revision: | P04

Suitability: | S3

Project No: | 2685

T: +44 (0)1279 647044 E: office@lizlake.com www.lizlake.com

COPYRIGHT Liz Lake Associates. Information contained in this drawing is confidential and may not be used for any purpose other than that for which the drawing is supplied without prior written authority of Liz Lake Associates. This drawing is copyright and may not be copied except within the agreed conditions of supply.

LIZ LAKE ASSOCIATES
LANDSCAPE ARCHITECTS

FOR OTHER LANDSCAPE DRAWINGS REFER TO THE FOLLOWING:

PLANTING PLANS:
-J6477-LLA-90-ZZ-00-D-L-01200 series

DETAILS:
-J6477-LLA-90-ZZ-ZZ-D-L-70302 Tree Planting Details
-J6477-LLA-90-ZZ-ZZ-D-L-70303 Typical Planting Details

SPECIFICATION:
-J6477-LLA-90-ZZ-ZZ-SP-L-63301 Soft Landscaping Specifications

SCHEDULES:
-J6477-LLA-90-ZZ-ZZ-SH-L-92205 Planting Schedule
-J6477-LLA-90-ZZ-ZZ-SH-L-63802 Implementation Schedule
-J6477-LLA-90-ZZ-ZZ-SH-L-29901 Designer's Risk Assessment

REPORT:
-J6477-LLA-90-ZZ-ZZ-RP-L-63801 Landscape Management Plan

All dimensions in millimetres

This drawing is to be used for planting information only

Any species substitution must be verified with the project Landscape Architect

This layout must be checked in accordance with NHBC Standards 2023 (Chapter 4.2 - Building Near Tree, and Chapter 10.2 - Drives, Paths and Landscaping) by the project engineer prior to implementation

Excavations: Contractors must ensure they have full information relating to service and drainage positions before undertaking any excavations

Root barriers to be used in association with tree planting adjacent to kerbs, services, highways etc.

All irrigation by specialists

For CDM information refer to Designers Risk Assessment

