

DISCLAIMER NOTES

DO NOT SCALE THIS DOCUMENT - USE FIGURED DIMENSIONS ONLY.
 ALL DIMENSIONS MUST BE CHECKED ON SITE PRIOR TO COMMENCEMENT OF ANY RELATED WORKS.
 THIS DOCUMENT IS COPYRIGHT OF THE ORIGINATOR, IT MUST NOT BE ALTERED, REPRODUCED OR DISTRIBUTED WITHOUT PRIOR CONSENT.
 THIS DOCUMENT MUST BE READ IN CONJUNCTION WITH ALL SUPPORTING DOCUMENTS PRODUCED BY THE ORIGINATOR AND OTHER PROJECT DISCIPLINES.
 OS MAPPING OBTAINED FROM PROMAP LICENCE No. 1000022432 REPRODUCED BY BERRYS UNDER OS LICENCE No. 100003668

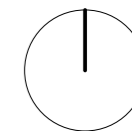

RIBA 
 Chartered Practice

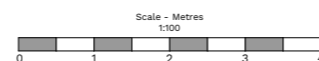
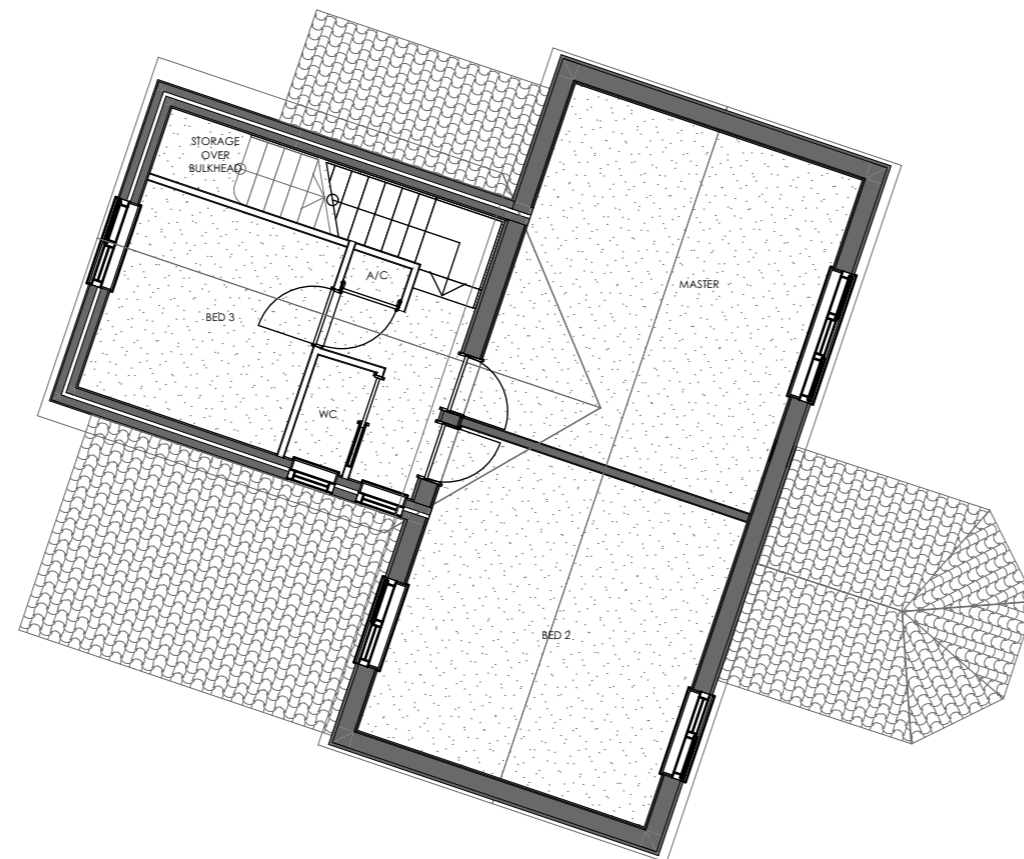

REV	DESCRIPTION	DATE	BY	CHKD

ORIGINATING OFFICE

BEECH HOUSE
 SHREWSBURY BUSINESS PARK
 SHREWSBURY
 SHROPSHIRE
 SY2 6FG
 01743 276897
 shrewsbury@berrys.uk.com
 www.berrys.uk.com

BERRYS

STATUS: **PLANNING**

CLIENT: Mrs. M. Quigley

PROJECT: Extension and alterations to Old School House, Holyhead Road, Bicton, Shrewsbury, SY3 8EQ.

DRAWING: Existing First Floor

SCALE @ A3: 1:100	AUTHOR: RC	CHKD BY:	DATE: 05.08.2022
----------------------	---------------	----------	---------------------

DRAWING No: SA44442-BRY-01- PL- A- 0102	REVISION:
--	-----------