

This drawing is the property of Simon Middlecote Architecture Ltd. Copyright is reserved by them and the drawing is issued on the condition that it is not copied, reproduced, retained or disclosed to any unauthorised person, wholly or in part without the written consent of Simon Middlecote Architecture Ltd. All dimensions to be verified on site, do not scale drawing.

Key to abbreviations

- IC Inspection chamber
- SP/AAV Soil and vent pipe with air admittance valve
- SVP Soil and vent pipe
- WP Waste pipe
- RWP Rainwater pipe
- Gu Gully
- GM Gas Meter
- EM Electric Meter
- Dis. Board Distribution board
- AP Alarm Panel

- Below ground drainage**
- — — Private combined
 - - - Shared combined
- (Assumed. TBC by survey by others)

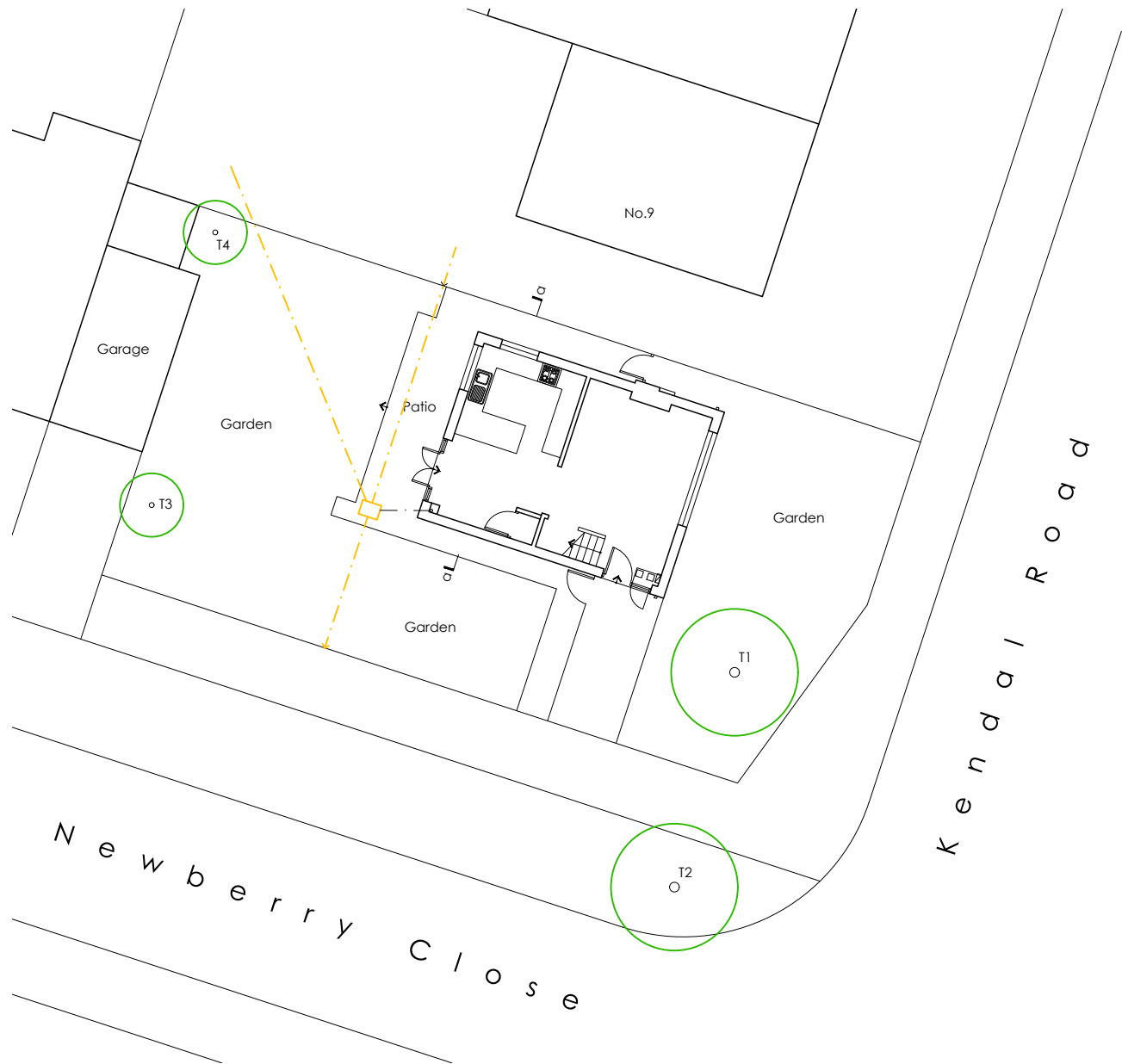

site plan 1:200

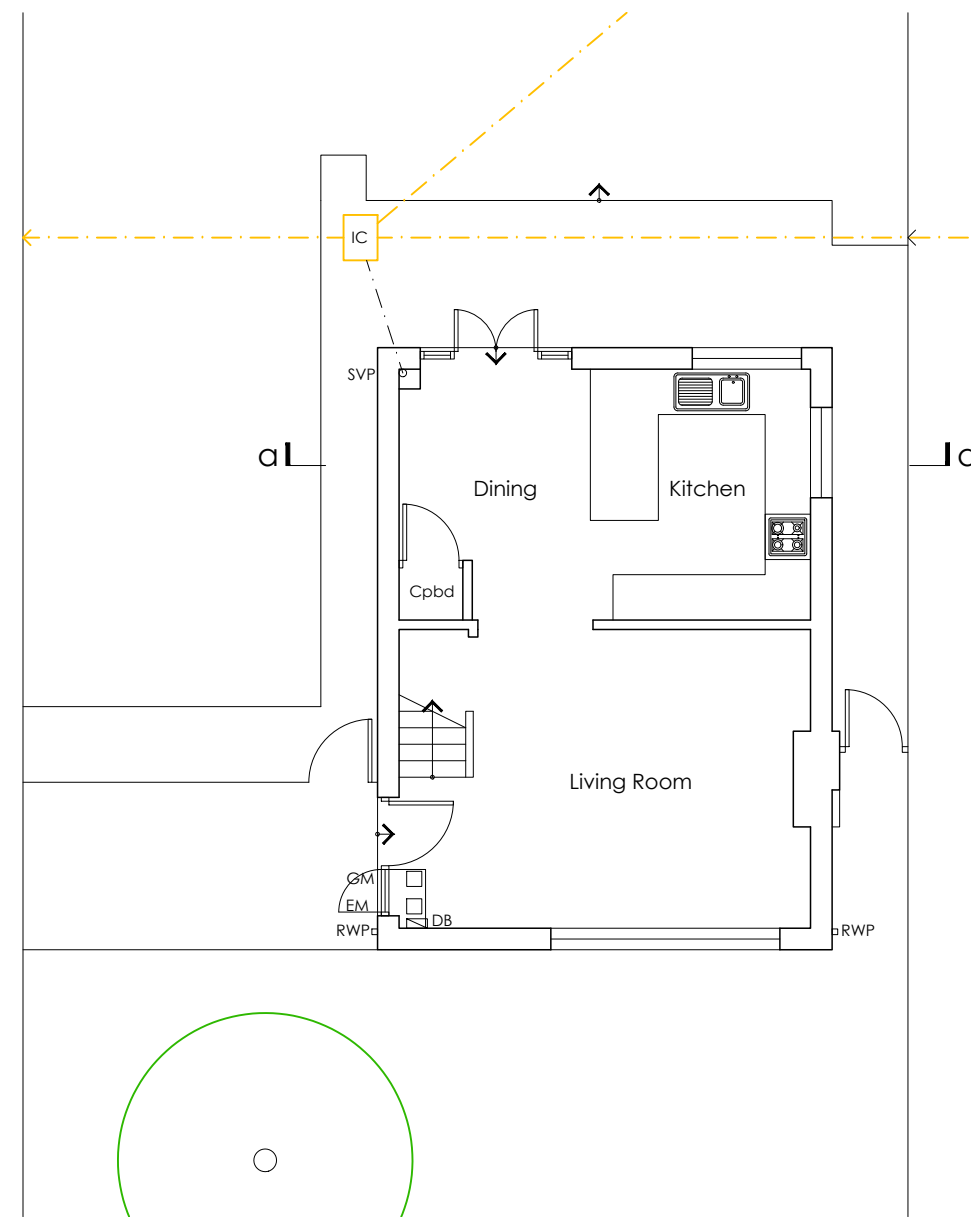

Ground Floor Plan

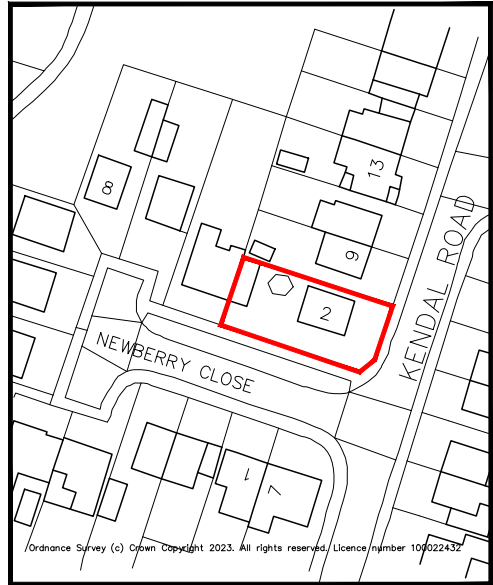

NORTH
location plan
1:1250

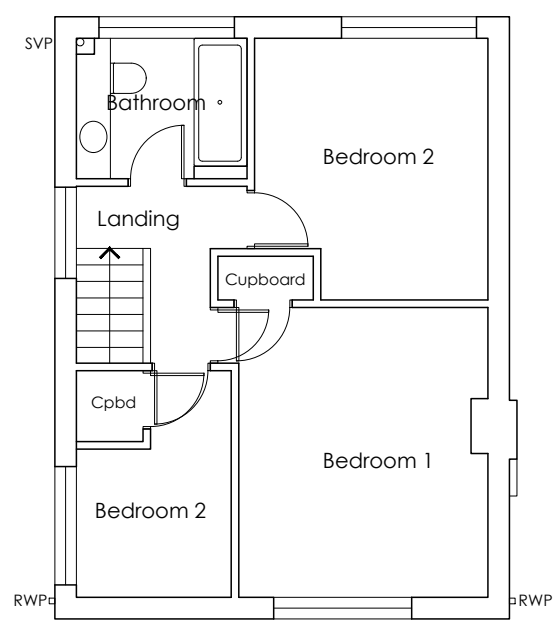

First Floor Plan

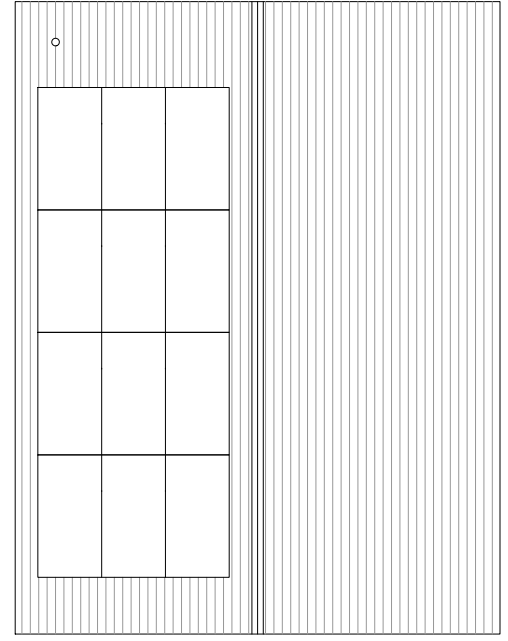

Roof Plan

| Rev | Date | Description | By |
|---|---------------------|-------------------|---------------------|
| | | | |
| <p>Simon Middlecote Architecture Ltd 7 Mountsorrel Drive West Bridgford Nottingham NG2 6LJ T - 07742 301320 E - info@simonmiddlecote.co.uk</p> | | | |
| Client: | | | |
| Project Title: 2 Newberry Close Cropwell Bishop | | | |
| Drawing Title: Location Plan and site plan and plans as existing | | | |
| Project No: 23005 | Dwg No: (02)01 | Revision: - | Scale: 1:200/100 |
| Drawn: SM | Date: 20.07.2023 | Status: SURVEY | |