

All dimensions in millimeters  
Do Not Scale

**Note**

The system can be reconfigured if air flow direction is different to that shown.  
Transition and ducting sections in between units drawn for indication purposes only. All transition pieces and ducts to be designed, supplied and installed by others.

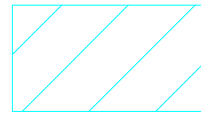

**Service Space**

Note: If access equipment is necessary service requirements may vary.

Max. Air Volume through system 0.7m³/s

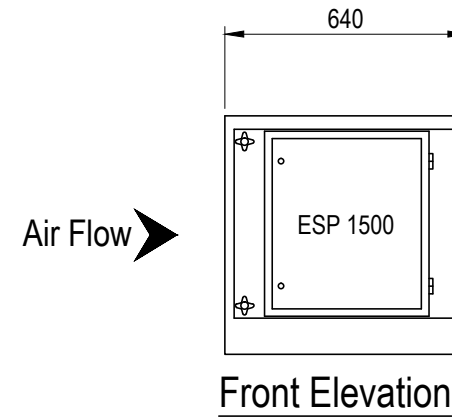
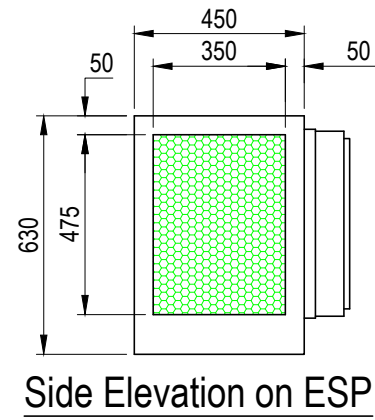
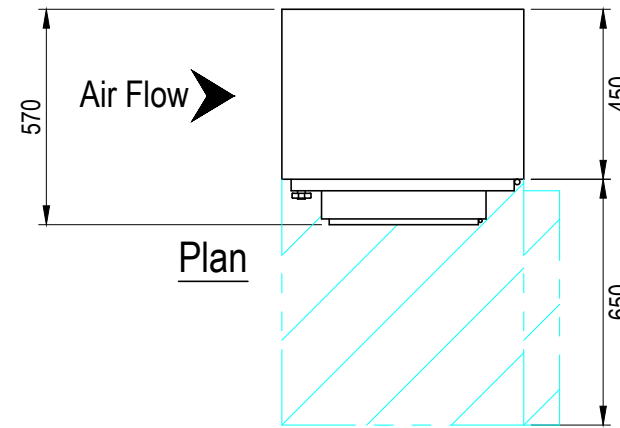

**purifiedair**<sup>®</sup>  
www.purifiedair.com  
**PURIFIED AIR LTD**  
LYON HOUSE, LYON ROAD, ROMFORD,  
ESSEX, RM1 2BG  
TEL:01708 755414  
FAX:01708 721488  
e-mail : info@purifiedair.co.uk

PURPOSE OF ISSUE: Overall Dimensions of ESP1500

CLIENT	-
LOCATION	-
DATE	DRAWN
20.01.15	MDK
SCALE	CHECKED
1:20 @ A3	
DRAWING NO.	REV.
E1	-