

- 1 Check All Dimensions On Site
- 2 For Construction Purposes Do Not Scale
- 3 All Dimensions in Millimetres

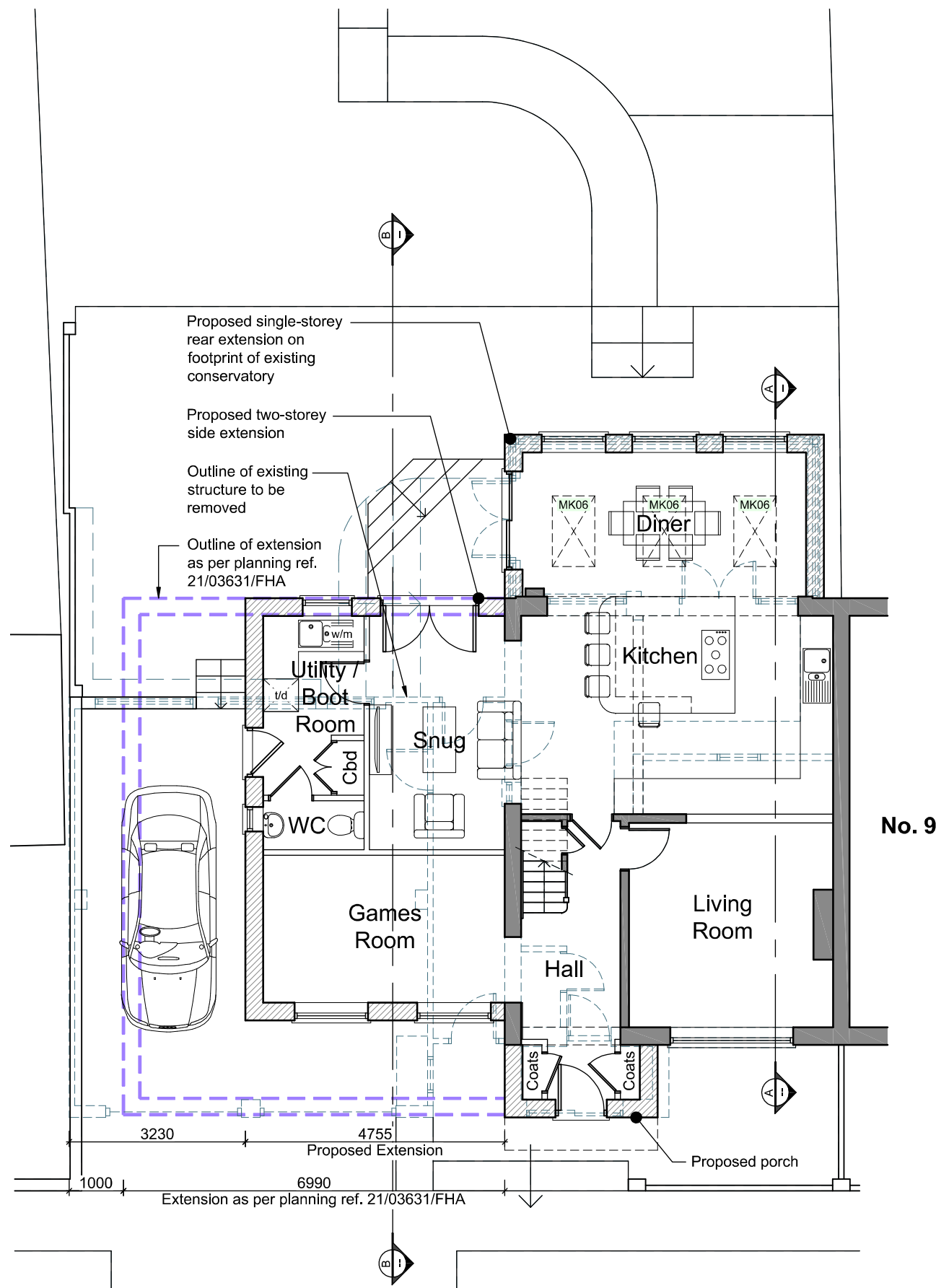

Ground Floor Plan
Scale - 1:100

	Total Area	Total Volume
Original	101.4m ²	308.5m ³
Existing	181.8m ²	523.0m ³
Proposed	195.9m ²	578.3m ³

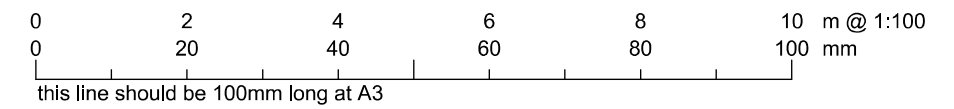
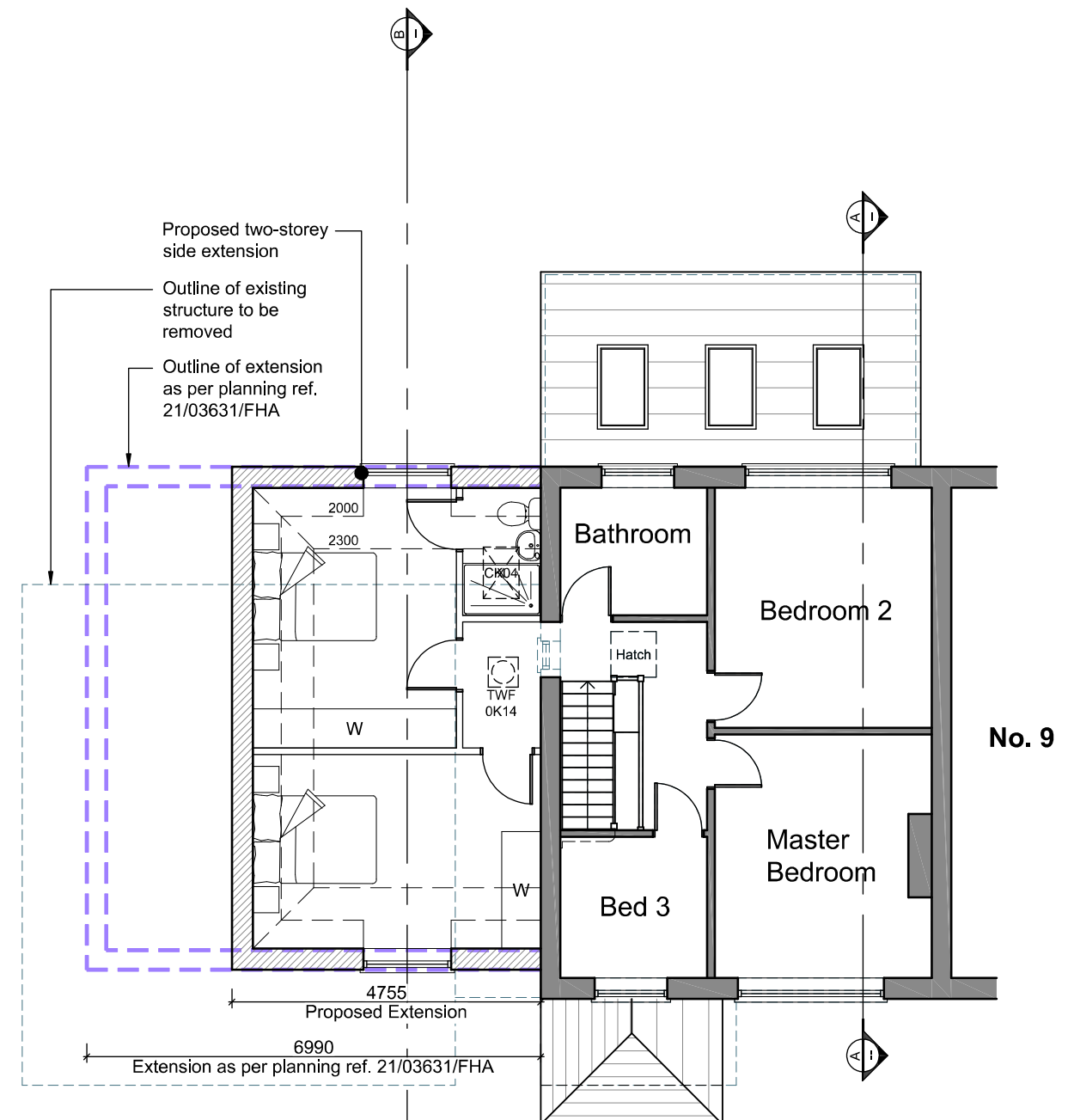

First Floor Plan
Scale - 1:100

Rev. Date Description

Rev.	Date	Description
A	Aug 23	Sun tunnel added over new landing. Side lights removed from front door to allow for cupboards. Minor internal alterations.

Project: Two storey extension and alterations at 10 Old Watling Street, Flamstead St Albans, AL3 8HL
Date: Feb 23
Drawing Title: Floor Plans as Proposed
Scale: 1:100 @ A3
Drawing No: 0679/11
Rev. A

Aubrey Technical Services ©
Architectural Design Consultants Telephone 01442 247935
'The Loft' 61A Belswains Lane Hemel Hempstead Herts HP3 9PP

PLANNING