

Access for maintenance vehicles and accessible parking gained via existing service road access.

EXISTING CONTAINER

PROPOSED SITE PLAN KEY

-  - Tarmac Hatch
-  - Gravel Hatch
-  - Proposed Walkway

The HARRIS Group Ltd does not accept liability for any deviation to our drawings or specification. The Drawing is copyright and may not be reproduced in whole or part without written authority. Do not scale off the drawing.

Rev.	Date	Description	Drawn	Checked
A	22/09/23	North arrow and scale bar added to drawing. New walkway and generator added to the plan and new notes added.	AC	EG

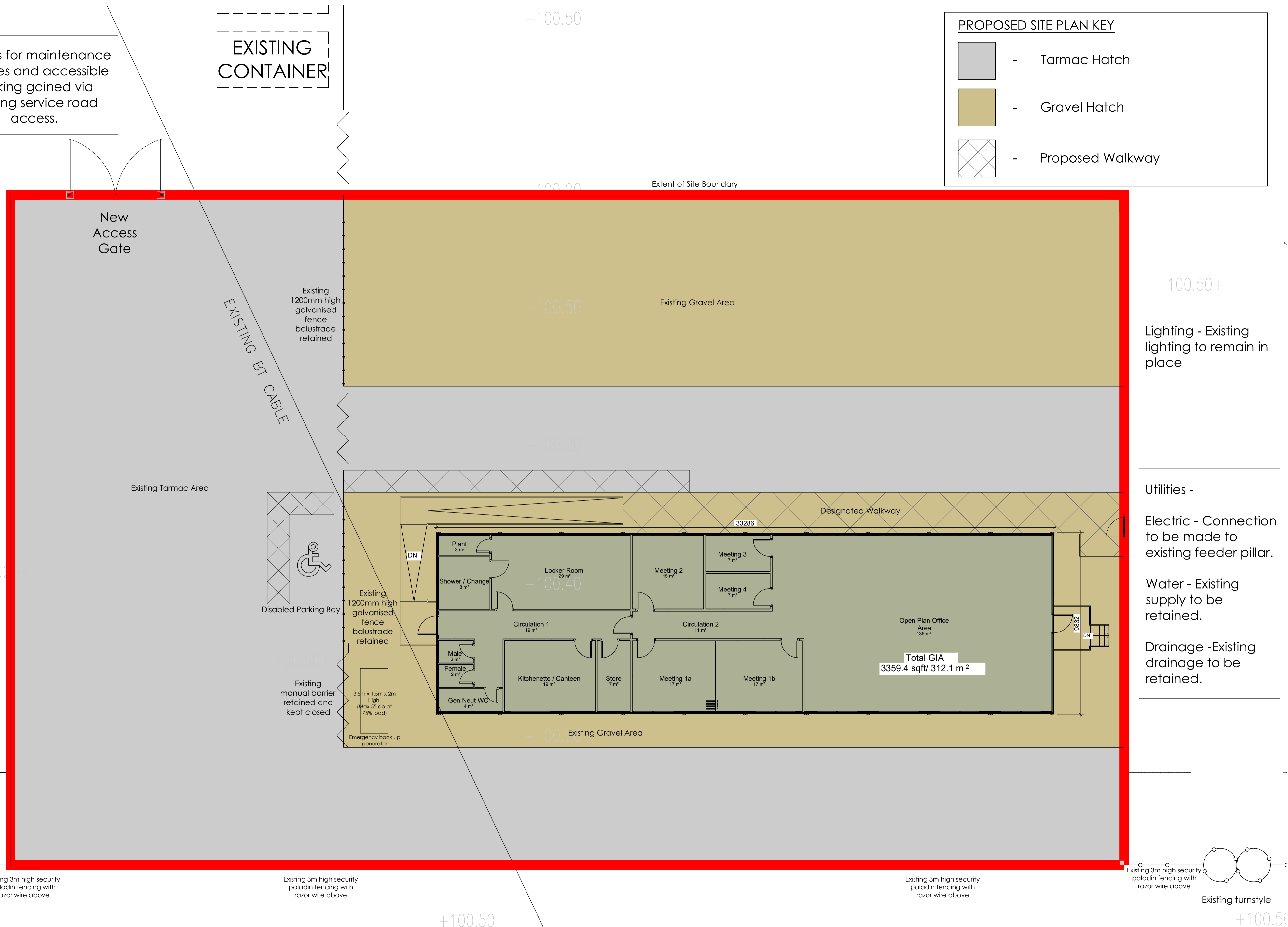

Lighting - Existing lighting to remain in place

Utilities -
 Electric - Connection to be made to existing feeder pillar.
 Water - Existing supply to be retained.
 Drainage - Existing drainage to be retained.

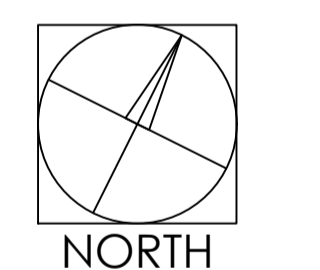

0 1000 2000 3000 4000 5000mm
 SCALE 1:100

THE HARRIS PARTNERSHIP
 ARCHITECTS
 WAKEFIELD - T. 01924 291800
 23-25 DEER STREET, WAKEFIELD WF1 1QA
 MANCHESTER - T. 0161 2388555
 CANAL WORKS, 77 CANAL STREET, MANCHESTER, M4 2BQ
 MELTON KEYNES - T. 01908 211 577
 THE OLD RECTORY, 79 HIGH STREET, MELTON KEYNES, LE14 6BA
 READING - T. 0118 950 7700
 101 LONDON ROAD, READING, RG1 8P
 LONDON - T. 020 7409 1215
 15 CANAL STREET, LONDON, E14 3BQ

Client
 UK - AEA

Project Title
 West Burton Power Station

Nottinghamshire
 Retford
 DN22 9BN

Drawing Title
 Proposed Detailed Site Plan

Drawn	Checked	Scale	BM Status	Date
AC	EG	1:100	S2	09/23

Drawing Status	Rev.	THP Project No.
PLANNING	A	19706

Project No.	Originator	Volume	Level	Type	Rate	Number
19706	THPW	XX	XX	DR	A	103