

DRAWING LEGEND

Site boundary line

PROPOSED PRIVATE FOUL DRAINAGE

Private foul water drainage

MH MH Private foul water manhole

SVP Soil vent pipe

SS Stub stack

PROPOSED PRIVATE SURFACE WATER DRAINAGE

Private surface water drainage

MH MH Private surface water manhole

SA Private surface water soakaway

RWP Rainwater pipe

TD Threshold drain (details by others)

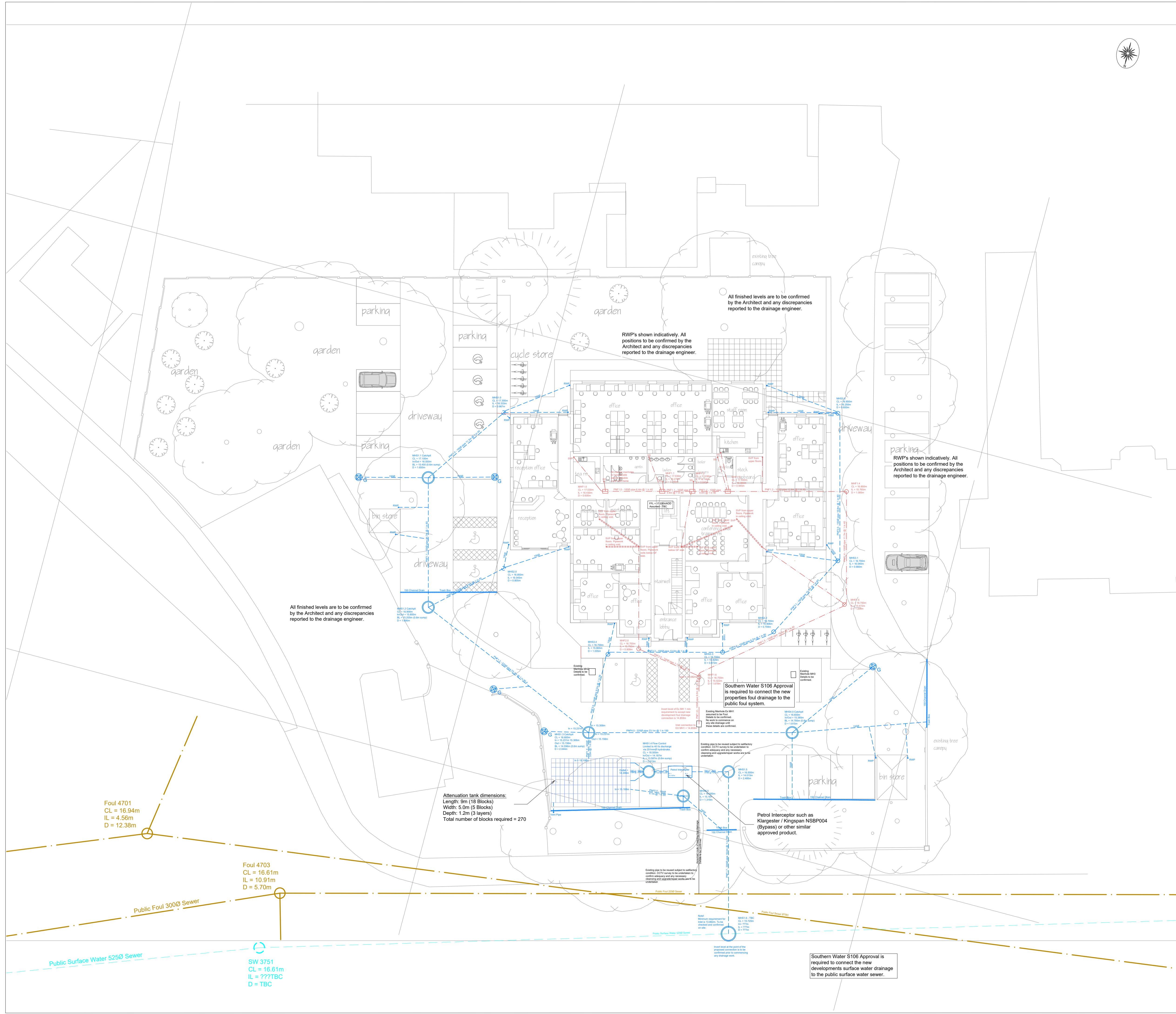

All finished levels are to be confirmed by the Architect and any discrepancies reported to the drainage engineer.

RWP's shown indicatively. All positions to be confirmed by the Architect and any discrepancies reported to the drainage engineer.

RWP's shown indicatively. All positions to be confirmed by the Architect and any discrepancies reported to the drainage engineer.

All finished levels are to be confirmed by the Architect and any discrepancies reported to the drainage engineer.

Southern Water S106 Approval is required to connect the new properties foul drainage to the public foul system.

Petrol Interceptor such as Klargester / Kingspan NSBP004 (Bypass) or other similar approved product.

Southern Water S106 Approval is required to connect the new developments surface water drainage to the public surface water sewer.

Foul 4701
CL = 16.94m
IL = 4.56m
D = 12.38m

Foul 4703
CL = 16.61m
IL = 10.91m
D = 5.70m

Attenuation tank dimensions:
Length: 9m (18 Blocks)
Width: 5.0m (5 Blocks)
Depth: 1.2m (3 layers)
Total number of blocks required = 270

SW 3751
CL = 16.61m
IL = ???TBC
D = TBC

Surface Water Strategy
Current surface water runoff rates:
2yr = 31.5/s
30yr = 79.1/s
100yr = 95.1/s
Surface water will have a controlled discharge to the public surface water sewer.
50% of the 30yr runoff 79.1/s. Therefore controlled to 40/s

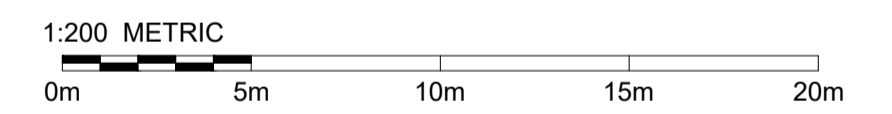

DRAINAGE NOTES

- The location of any existing drains and sewers are to be accurately located and reported prior to any work commencing on site.
- All materials, workmanship and construction to be in accordance with the requirements of 'Sewers for Adoption - 7th Edition' and published addendum and corrigendum.
- Channel drains shown are only to collect surface water run-off from hard paved areas and door thresholds and are not intended to collect groundwater or run-off from gardens and landscaped areas.
- All abandoned pipework to be completely removed or grout filled unless stated otherwise.

NOTES

- The Contractor should check all dimensions on site.
- It is the Contractors responsibility to ensure compliance with building regulations and current codes of practice.
- Drawings cannot take into account any drains or underground works not locatable by visual survey of the site.
- Commencement of any building works prior to full building regulation approval is entirely at the clients risk.

A	First issue to client	25/10/2023
Rev	Description	Date
PROJECT: Proposed residential development at St Peters Presbytery, 117 Canterbury Road, Westgate-On-Sea, Kent CT16 3QX		
CLIENT: AGI Architecture		
DRAWING: Drainage Plan - Overall Site	SCALE: 1:200	DATE: 25/10/2023
STATUS: PRELIMINARY	PROJECT NO: T-2023-081-02	SHEET NO: A1



Studio 23 Tridax Business Park, Honeywood Parkway, Whitfield, Dover, Kent CT16 3QX
Tel: 01304 820777

Copyright and other intellectual property rights in this document and all related documents, drawings, etc., including calculations, is invested in Tridax Ltd and cannot be used or reproduced for any other purpose than that for which they been created without the express permission in writing by Tridax Ltd. In first instance ring 01304 820777.