

The copyright of the design remains with Low Carbon Studio Ltd. and may not be reproduced without their prior written consent.
 All dimensions are to be checked on site and the Architect notified of any discrepancies.
 Do not scale from this drawing for Constructional purposes.

NOTES:

Hatching indicates extent of alterations 

Red hatching indicates partitions, doors and fittings to be removed 

EXTERNAL MATERIALS

Existing
 External walls - Masonry wall with render to match existing.
 Chimney stack - Masonry with render to match existing.
 Roof - Slates.
 Rain water goods - Cast Iron painted black.
 Windows - PVC double glazed.
 Doors - Timber/PVC with double glazing.

Proposed
 External walls - Timber cladding Scotlarch RW102.
 Dormer - Timber cladding with single ply roof.
 Roof - Slates or standing seam zinc.
 Windows - PVC double glazed, frame colour grey.
 Doors - PVC fully double glazed, frame colour grey.

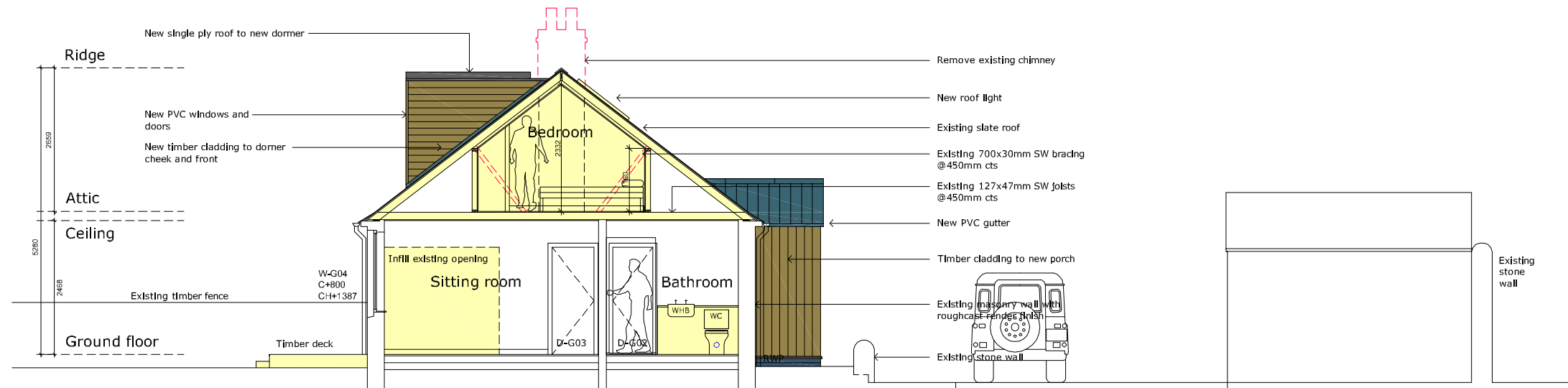

PROPOSED SECTION C-C

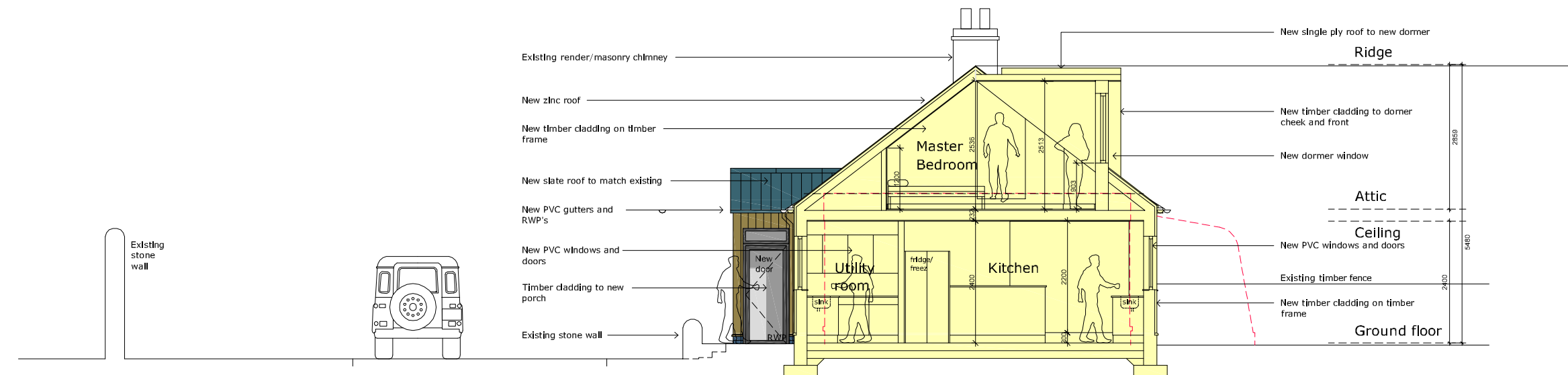

PROPOSED SECTION D-D

PROPOSED SECTIONS
 SCALE 1:100@A3



A	CC	26.10.23	Planning updates
NO.	INIT.	DATE	REVISION

www.lowcarbonstudio.org 

CLIENT GARY DUNHAM & KATRINA MACINTOSH

PROJECT 3 WESTER BROOMHOUSE COTTAGES
 ALTERATIONS TO EXISTING HOUSE

Denerigg / West Saltoun / East Lothian / EH34 5EJ / T 01875 341419

TITLE PROPOSED SECTIONS

DRAWN	CHECK	JOB No. /	Drwg No. /	Rev
CC		2297 /	221 /	A
SCALE	DATE			
1:100@A3	SEPT 23			

mail@lowcarbonstudio.org