







The copyright of the design remains with Low Carbon Studio Ltd, and may not be reproduced without their prior written consent. All dimensions are to be checked on site and the Architect notified of any discrepancies. Do not scale from this drawing for Constructional purposes.

NOTES:

-  twin 13a s.s.o. - 375mm to base from f.f.l.
-  single 13a s.s.o. - 375mm to base from f.f.l.
-  wall mounted radiator
-  single 13a s.s.o. - 375mm to base from f.f.l.
-  low voltage downlight
-  wall mounted light fitting
-  switchplate wired to fittings shown 1200mm to base

Hatching indicates extent of alterations
 Red hatching indicates partitions, doors and fittings to be removed

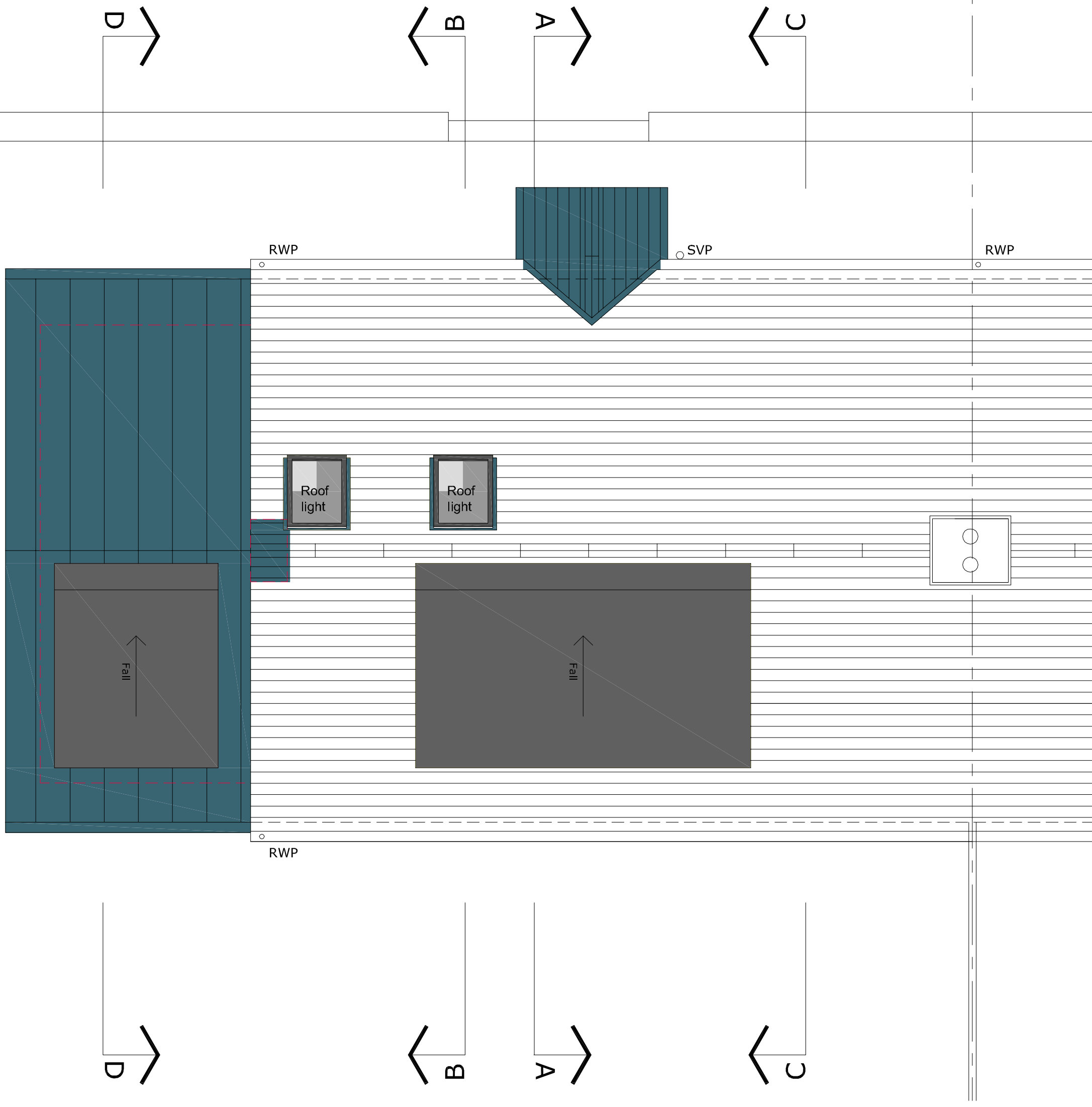

NO.	INIT.	DATE	REVISION
A	CC	26.10.23	Planning updates

www.lowcarbonstudio.org  **lowcarbonstudio**

CLIENT GARY DUNHAM & KATRINA MACINTOSH

PROJECT 3 WESTER BROOMHOUSE COTTAGES
 ALTERATIONS TO EXISTING HOUSE

Denerigg / West Saltoun / East Lothian / EH34 5EJ / T 01875 341419

PROPOSED ROOF LAYOUT
 SCALE 1:50@A3



TITLE PROPOSED ROOF LAYOUT

DRAWN	CHECK	JOB No. /	Dwg No. /	Rev
CC	-	2297 / 212	/ A	
SCALE	DATE			
1:50@A3	SEPT 23			

mail@lowcarbonstudio.org