

EXISTING FLOOR PLAN

EXISTING GATE AND SIDE GATE

MR AND MRS CRAMPIN  
 PROPOSED FIRST FLOOR BEDROOMS  
 INTERNAL ALTERATIONS  
 1A MINE ROAD,  
 BRIDGE OF ALLAN

EXISTING FLOOR SITE PLAN

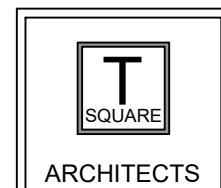

Architecture - Design - Planning

39 Allanvale Road  
 Bridge of Allan  
 Stirling  
 FK9 4PA

Mob: 07596906412

E-mail: [claire.gibbons@tsquare-architects.co.uk](mailto:claire.gibbons@tsquare-architects.co.uk) Web: [www.tsquare-architects.co.uk](http://www.tsquare-architects.co.uk)

scale 1:100	date 05.10.23	drawn: CG	status: P
proj no. 2023-1001	Dwg no. T-201	REV	