

MR AND MRS CRAMPIN
 PROPOSED FIRST FLOOR BEDROOMS
 INTERNAL ALTERATIONS
 1A MINE ROAD,
 BRIDGE OF ALLAN

SITE PLAN

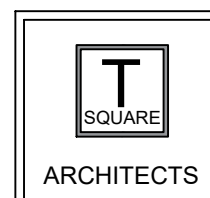

Architecture - Design - Planning

39 Allanvale Road
 Bridge of Allan
 Stirling
 FK9 4PA

Mob: 07596906412

E-mail: claire.gibbons@tsquare-architects.co.uk Web: www.tsquare-architects.co.uk

scale 1:100	date 05.10.23	drawn: CG	status: P
proj no. 2023-1001	Dwg no. T-701	REV	