

ASSUMED EXISTING ROOF BUILD-UP

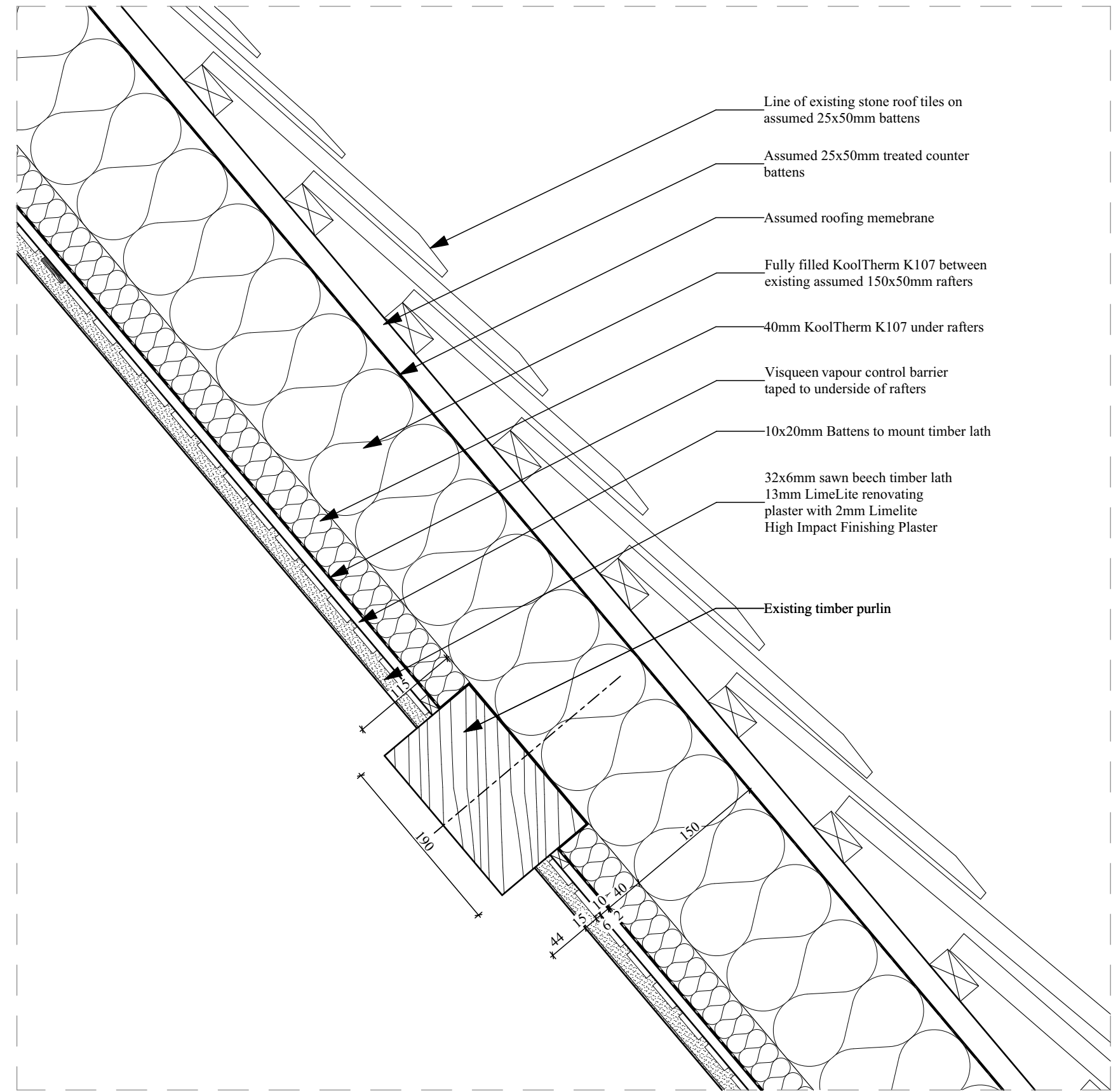

PROPOSED ROOF DETAIL: ADDING KINGSPAN (RIGID THERMOSET PHENOLIC) INSULATION BETWEEN & UNDER RAFTERS WITH TRADITIONAL LIME PLASTER TO ACHIEVE U-VALUE 0.14W/M2.K

B	18.09.23	Modern plasterboard shown on existing build-up.
A	14.09.23	Planning status indicated.

REV.	DATE	NOTES
------	------	-------

CHECK ALL DIMENSIONS ON SITE AND REPORT ANY DISCREPANCIES.
DO NOT SCALE FROM THIS DRAWING

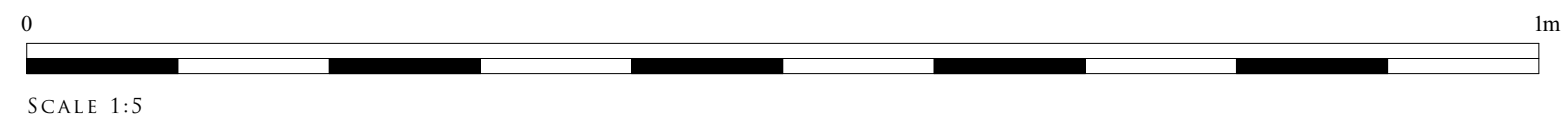

PLANNING

CRAIG HAMILTON ARCHITECTS LTD

COED MAWR FARM, HUNDRED HOUSE, RADNORSHIRE LD1 5RP · T:01982 553312
OLD STABLE BLOCK, INCUBIVE SPACE, HURSLEY PARK ROAD, HURSLEY SO21 2JN

PROJECT THE OLD RECTORY, WITHINGTON
DRAWING TITLE: STUDIO PROPOSED ROOF BUILD-UP
DRAWING N^o: 0503/PL38 REV: B
DATE: AUGUST 2023 SCALE: 1:5@A2
DRAWN BY: MS