



Topographical Abbreviations

A/R	Assumed Route	LP	Lamp Post
BH	Borehole	MH	Manhole
BOL	Bollard	MKR	Marker
BT	British Telecom Cover	MT	Mercury Telecom Cover
BW	Barbed Wire Fence	OHC	Overhead Cable
BWK	Brickwork	OHP	Overhead Pipe
CATV	Cable TV Cover	OSBM	Ordnance Survey Bench Mark
CB	Close Boarded Fence	PB	Post Box
CCTV	Closed Circuit TV	PGM	Permanent Ground Marker
CHLK	Chainlink Fence	PR	Post & Rail Fence
CHPL	Chestnut Paling Fence	PW	Post & Wire Fence
CL	Cover Level	PWM	Post & Wire Mesh Fence
CM	Cable Marker	RE	Rodding Eye
CP	Catch Pit	RG	Road Gully
CPS	Conc Paving Slabs	RN	Road Name
CPL	Catch Pit Base Level	RS	Road Sign
CZP	Crazy Paving	RW	Retaining Wall
D/C	Drainage Channel	RWP	Rain Water Pipe
DIA	Diameter	SAP	Sapling
DK	Drop Kerb	SC	Stop Cock
DP	Down Pipe	SPR	Spread
EJB	Electricity Junction Box	STA	Traverse Station
EC	Electricity Cover	SV	Stop Valve
EP	Electricity Pole	SVP	Soil Vent Pipe
ER	Earthing Rod	SW	Storm Water
FH	Fire Hydrant	TB	Telephone Box
FIG	Feed Into Ground	TBM	Temporary Bench Mark
FW	Foul Water	TFR	Taken From Records
G	Gully	TJB	Telephone Junction Box
GV	Gas Valve	TPT	Trial Pit
HT	Height	TL	Traffic Light
IC	Inspection Cover	TP	Telephone Pole
IL	Invert Level	UTL	Unable To Lift
IR	Iron Railing Fence	UTT	Unable To Trace
KO	Kerb Outlet	VP	Vent Pipe
LB	Litter Bin	WKH	Water Key Hole
LC	Lamp Column	WM	Water Meter
LL	Lap Larch	WV	Water Valve

NOTES

Grid is related to OS using GPS
All levels related to OS using GPS

5	-		
4	-		
3	-		
2	-		
1			
0	ACC	First Complete Issue	01/04/2022
Rev		Description	



CHINERY LAND SURVEYS

LABURNUM
MALDON ROAD
KELVEDON
ESSEX

Tele 01376 538135
Email acc@chinerylandsurveys.co.uk

SURVEYED	RJC	2-4c
DRAWN	RJC	
SCALE	1:200	

**EUROPEVANS SITE
THOBY LANE MOUNTNESSING**

TOPOGRAPHICAL SURVEY

JOB No	DRAWING NUMBER
CLS22056	CLS22056001 Rev 0

A2 Sheet - 594mm X 420mm

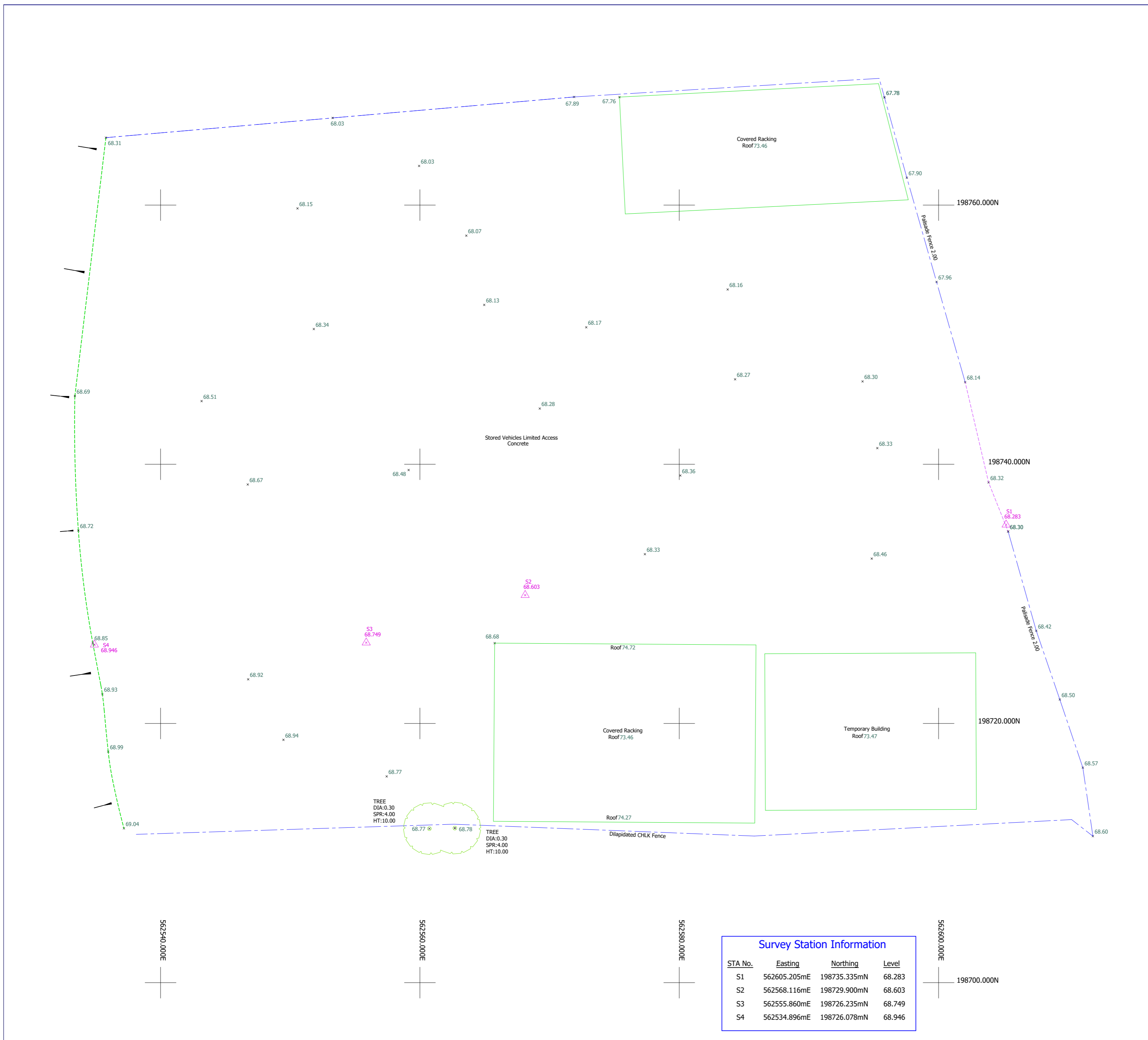

Survey Station Information			
STA No.	Easting	Northing	Level
S1	562605.205mE	198735.335mN	68.283
S2	562568.116mE	198729.900mN	68.603
S3	562555.860mE	198726.235mN	68.749
S4	562534.896mE	198726.078mN	68.946