

**PROPOSED GROUND FLOOR**

Scale @ 1/100

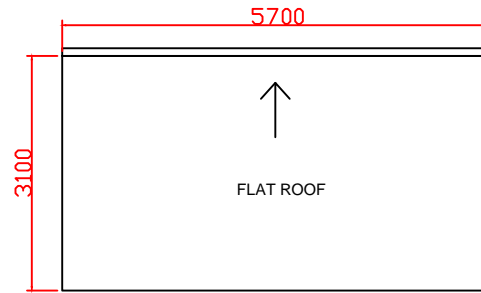

**PROPOSED ROOF PLAN**

Scale @ 1/100

**GENERAL NOTES**

- Walls: Walls to be rendered and painted off white.
- Windows and doors: Anthracite grey, RAL 7016 Upvc frame.
- Roof: Felt flat roof.

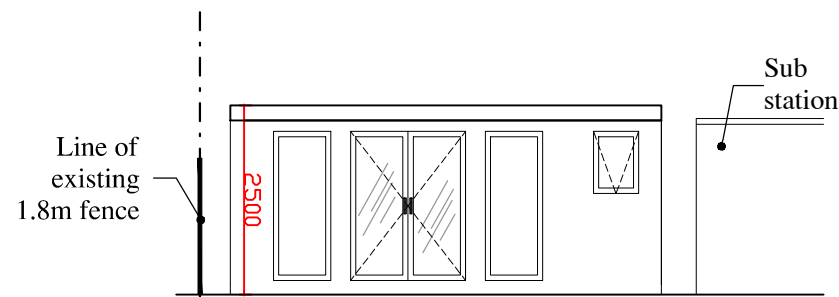
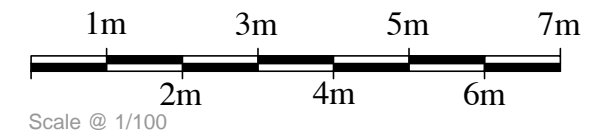

**PROPOSED FRONT ELEVATION (A)**

Scale @ 1/100

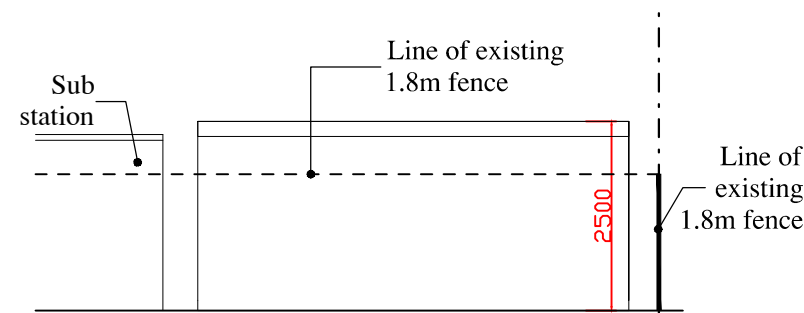

**PROPOSED REAR ELEVATION (D)**

Scale @ 1/100

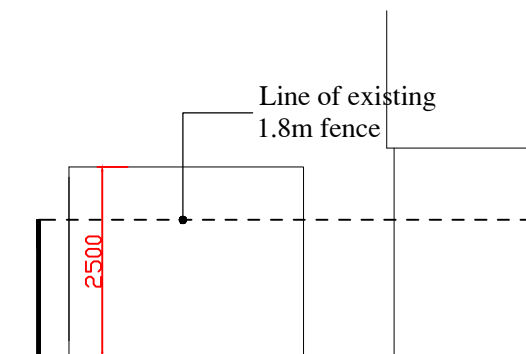

**PROPOSED SIDE ELEVATION (B)**

Scale @ 1/100

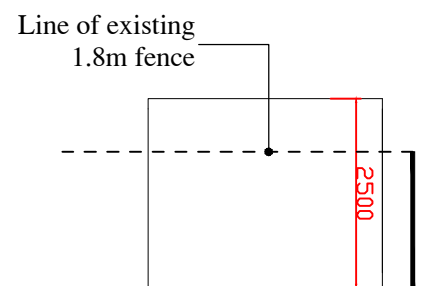

**PROPOSED SIDE ELEVATION (C)**

Scale @ 1/100

**GENERAL NOTES**

- Do not scale this drawing for Construction purposes.
- All dimensions in this dwg. are metric.
- This drawing shall be read in strict conjunction with all other relevant architectural, structural engineer's & services engineer's drawings, calculations, details & specifications.
- The contractor shall check all dimensions & setting out information on this or other related drawings prior to placing work in hand. Any errors or discrepancies between documents shall be reported to the Forward Architecture & seek clarification.
- All proprietary products shall be used & fixed in strict accordance with manufacturers' printed recommendations, notes, specifications etc.
- Only drawings stamped "ISSUED FOR CONSTRUCTION" shall be used on site.
- This drawing & all other drawings & schedules, specifications, details etc. relating to this project are copyright of Forward Architecture.

**Key:**

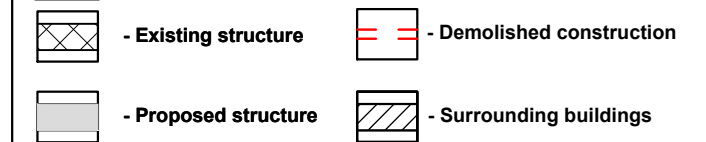

**Revisions**

ForwardArchitecture

020 8123 9086

info@forwardarchitecture.co.uk  
www.forwardarchitecture.co.uk

Project 76 Crombie Road  
SIDCUP  
DA15 8AU

Title PROPOSED PLANS  
AND ELEVATIONS

Scale As Indicated on A3 | Drawn by

Date 10-2023 | Checked

Drawing Number 2325\_02-01 | Revision



**EXISTING FRONT ELEVATION (A)**

Scale @ 1/100

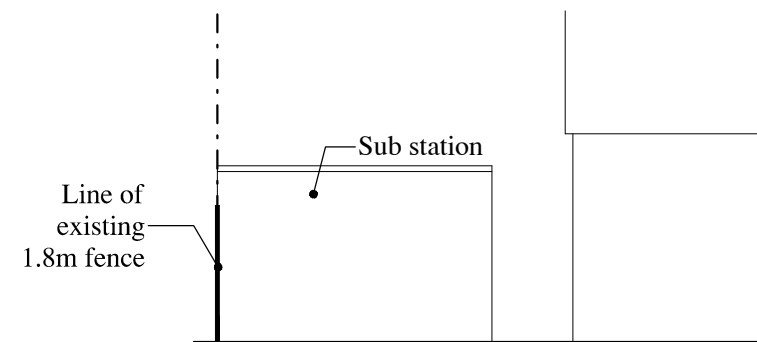

**EXISTING SIDE ELEVATION (B)**

Scale @ 1/100