

Notes
 Do not scale from this drawing. All dimensions to be checked on site prior to construction and any discrepancies reported to the Architect. Copyright reserved.

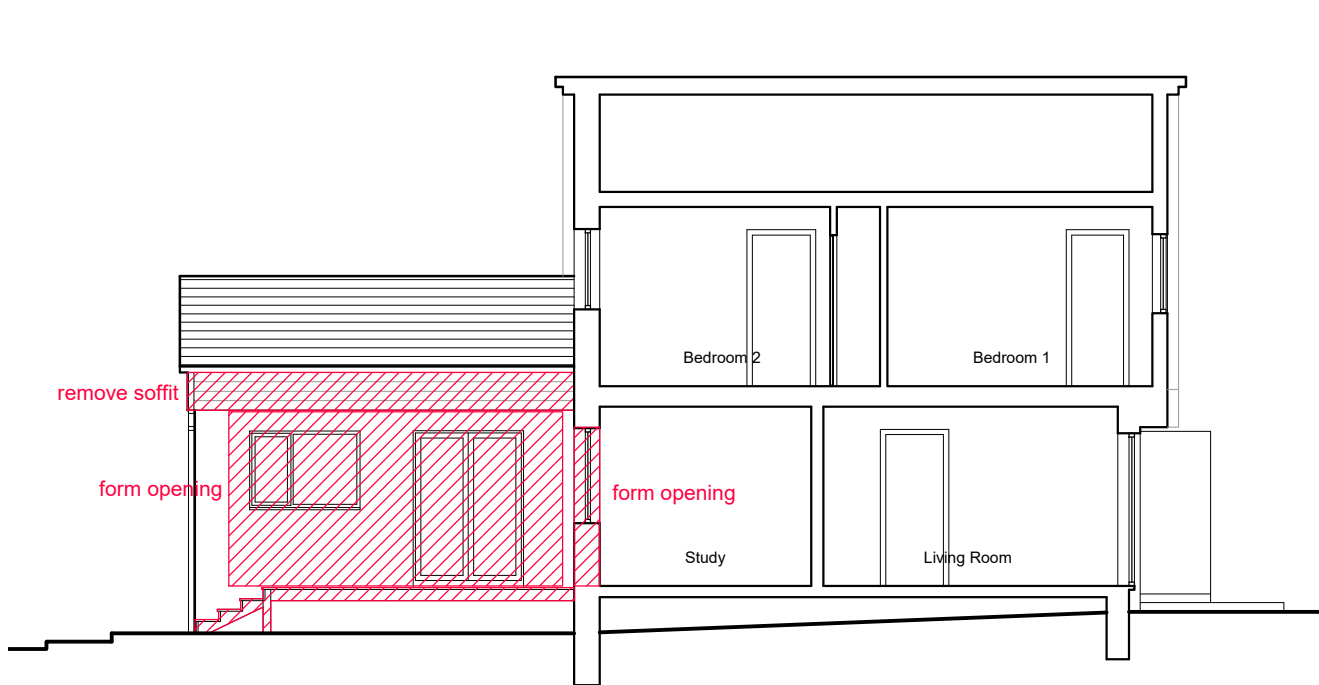

01 Section A-A' as existing
 1:100 @ A3

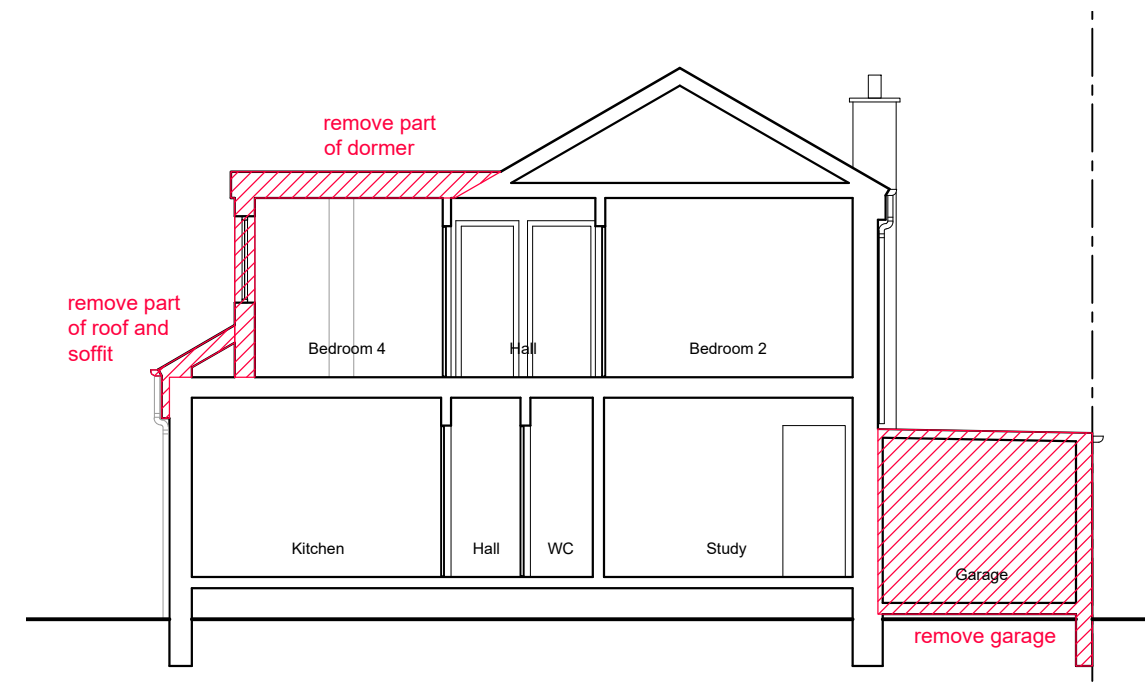

02 Section B-B' as existing
 1:100 @ A3

Revisions
 Status
PLANNING / BUILDING WARRANT
 Client
 Scott Murray
 Project
 2 Fleming Road
 Houston
 PA6 7EU
 Title
 Sections
 as existing

Scale	Size	Date	Drawn	Checked
1:100	A3	Sep 23	SW	SA



Allison Architecture
 13 Royal Crescent
 Glasgow G3 7SL
 t: +44 (0)141 353 1082
 e: hello@allisonarchitecture.co.uk
 www.allisonarchitecture.co.uk

Project No.	Drawing No.	Rev.
23028	01-005	-