

© THIS DRAWING AND THE DETAILS DEPICTED ARE THE COPYRIGHT OF BSP CONSULTING AND MAY NOT BE REPRODUCED EXCEPT BY WRITTEN PERMISSION. OS LICENCE NO. 1004172

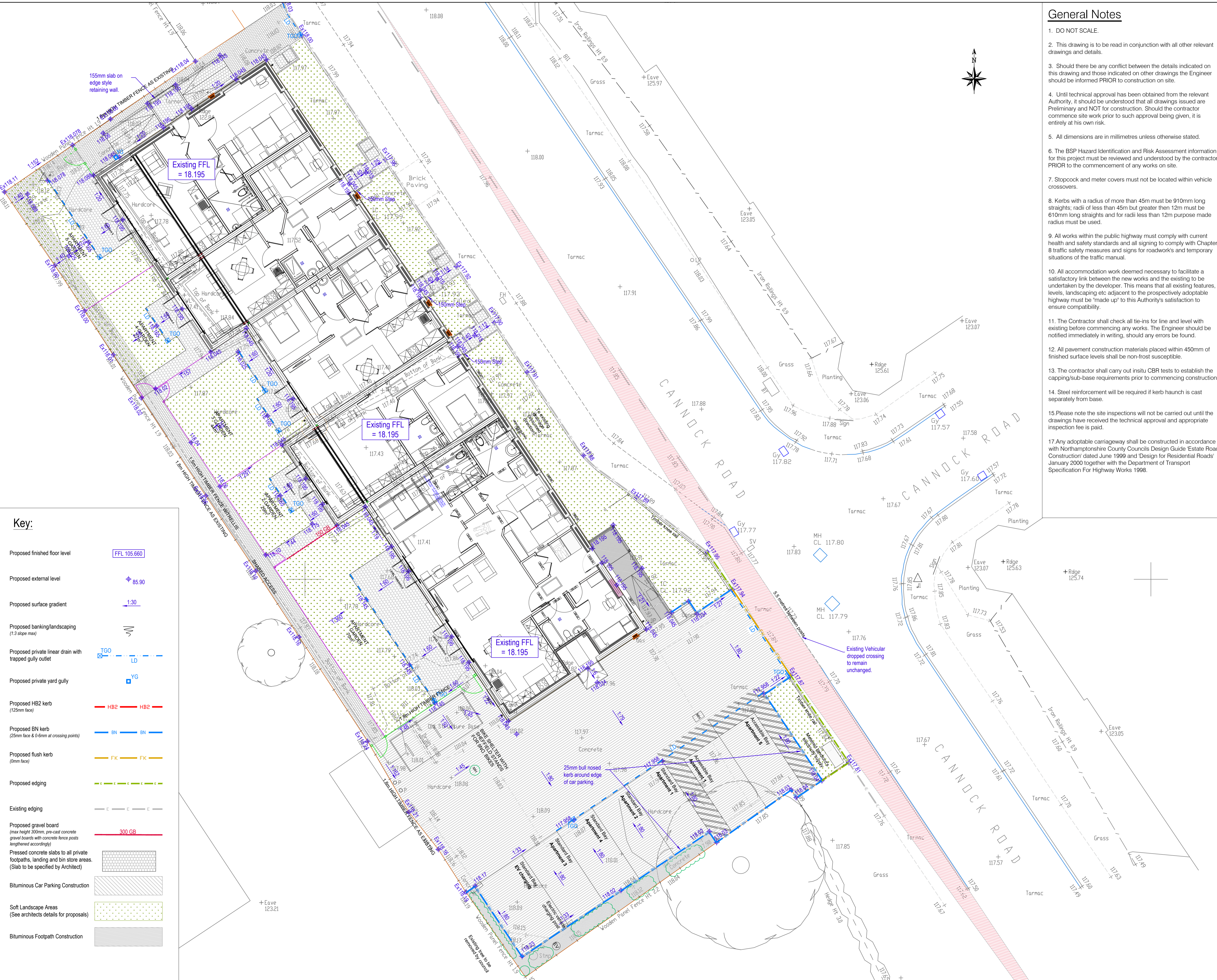

General Notes

- DO NOT SCALE.
- This drawing is to be read in conjunction with all other relevant drawings and details.
- Should there be any conflict between the details indicated on this drawing and those indicated on other drawings the Engineer should be informed PRIOR to construction on site.
- Until technical approval has been obtained from the relevant Authority, it should be understood that all drawings issued are Preliminary and NOT for construction. Should the contractor commence site work prior to such approval being given, it is entirely at his own risk.
- All dimensions are in millimetres unless otherwise stated.
- The BSP Hazard Identification and Risk Assessment information for this project must be reviewed and understood by the contractor PRIOR to the commencement of any works on site.
- Stopcock and meter covers must not be located within vehicle crossovers.
- Kerbs with a radius of more than 45m must be 910mm long straights; radii of less than 45m but greater than 12m must be 610mm long straights and for radii less than 12m purpose made radius must be used.
- All works within the public highway must comply with current health and safety standards and all signing to comply with Chapter 8 traffic safety measures and signs for roadworks and temporary situations of the traffic manual.
- All accommodation work deemed necessary to facilitate a satisfactory link between the new works and the existing to be undertaken by the developer. This means that all existing features, levels, landscaping etc adjacent to the prospectively adoptable highway must be 'made up' to this Authority's satisfaction to ensure compatibility.
- The Contractor shall check all tie-ins for line and level with existing before commencing any works. The Engineer should be notified immediately in writing, should any errors be found.
- All pavement construction materials placed within 450mm of finished surface levels shall be non-frost susceptible.
- The contractor shall carry out in situ CBR tests to establish the capping/sub-base requirements prior to commencing construction.
- Steel reinforcement will be required if kerb haunch is cast separately from base.
- Please note the site inspections will not be carried out until the drawings have received the technical approval and appropriate inspection fee is paid.
- Any adoptable carriageway shall be constructed in accordance with Northamptonshire County Councils Design Guide 'Estate Road Construction' dated June 1999 and 'Design for Residential Roads' January 2000 together with the Department of Transport Specification For Highway Works 1998.

Key:

Proposed finished floor level	FFL 105.660
Proposed external level	+ 85.90
Proposed surface gradient	1:30
Proposed banking/landscaping (1:3 slope max)	
Proposed private linear drain with trapped gully outlet	TGO LD
Proposed private yard gully	YG
Proposed HB2 kerb (125mm face)	HB2
Proposed BN kerb (25mm face & 0.6mm at crossing points)	BN
Proposed flush kerb (0mm face)	FK
Proposed edging	E
Existing edging	E
Proposed gravel board (max height 300mm, pre-cast concrete gravel boards with concrete fence posts lengthened accordingly)	300 GB
Pressed concrete slabs to all private footpaths, landing and bin store areas. (Slab to be specified by Architect)	
Bituminous Car Parking Construction	
Soft Landscape Areas (See architects details for proposals)	
Bituminous Footpath Construction	

KEY PLAN

Construction Risks	Maintenance/Cleaning Risks	Demolition/Adaptation Risks
--------------------	----------------------------	-----------------------------

In addition to the hazards normally associated with the type of work detailed on this drawing take note of the above.
It is assumed that all works on this drawing will be carried out by a competent contractor working, where appropriate, to an appropriate method statement.

SAFETY HEALTH AND ENVIRONMENTAL INFORMATION BOX

CONSTRUCTION ISSUE	AS	12/09/23	TW	31/08/23	CE	31/08/23
SITE LAYOUT UPDATED. CHANGES MADE TO SUIT.	AS	31/08/23	TW	31/08/23	CE	31/08/23
STEP ADDED TO FRONT OF PLOTS 2, 3 AND 4.	AS	10/02/23	CE	10/02/23	CE	10/02/23
INITIAL ISSUE	AS	07/02/23	CE	07/02/23	CE	07/02/23

SCALE @ A1	ISSUING OFFICE	PROJECT NUMBER
1:100	LEICESTER	22-0464

CLIENT APPROVAL	A - APPROVED
	B - APPROVED WITH COMMENTS
	C - DO NOT USE

STATUS	PURPOSE OF ISSUE
A1	CONSTRUCTION

Floor 4, 24 De Montfort Street, Leicester, LE1 7GB
 Tel: 0245 413 4000
 e-mail: info@bsp-consulting.co.uk
 Also offices in Nottingham, Derby and Sheffield

PROJECT
CANNOCK ROAD, CORBY NORTHAMPTONSHIRE

TITLE
LEVELS AND CONSTRUCTION LAYOUT

CLIENT
GLEEDS COST MANAGEMENT LTD.

PROJECT ORIGINATOR	FUNCTIONAL	SPATIAL	FORM	DISCIPLINE	NUMBER	REV
CRCL-BSP-XX-XX-D-C-0230						C01