

Alastair Barclay  
 Surveying and Building Consultant  
 Smiddy House  
 Shiresmill  
 Dunfermline  
 Fife  
 KY12 8ER  
 Mobile 07792 751 924  
 Email - ali.b20@btinternet.com

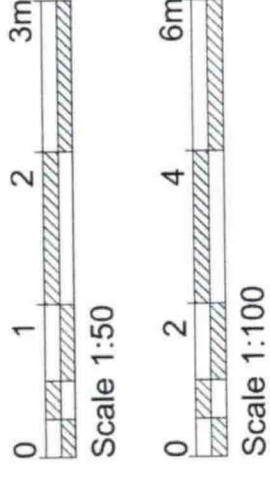

DWG NO - HOP 012

PROPOSED GARAGE  
 AND VARIOUS ALTERATIONS TO THE  
 EXISTING HOUSE  
 AT 79 HOPE STREET,  
 INVERKEITHING, FIFE,  
 KY11 1LN

FOR MR & MRS O. PADILLA

SCALE 1:50

Date - September 2023

This drawing has been produced for Planning Permission and Building Warrant purposes only. This is a true copy of the plans.

Signature: [Redacted]

Date: [Redacted]

All signed by the Contractor

Garage to be built 200mm from the existing boundary.

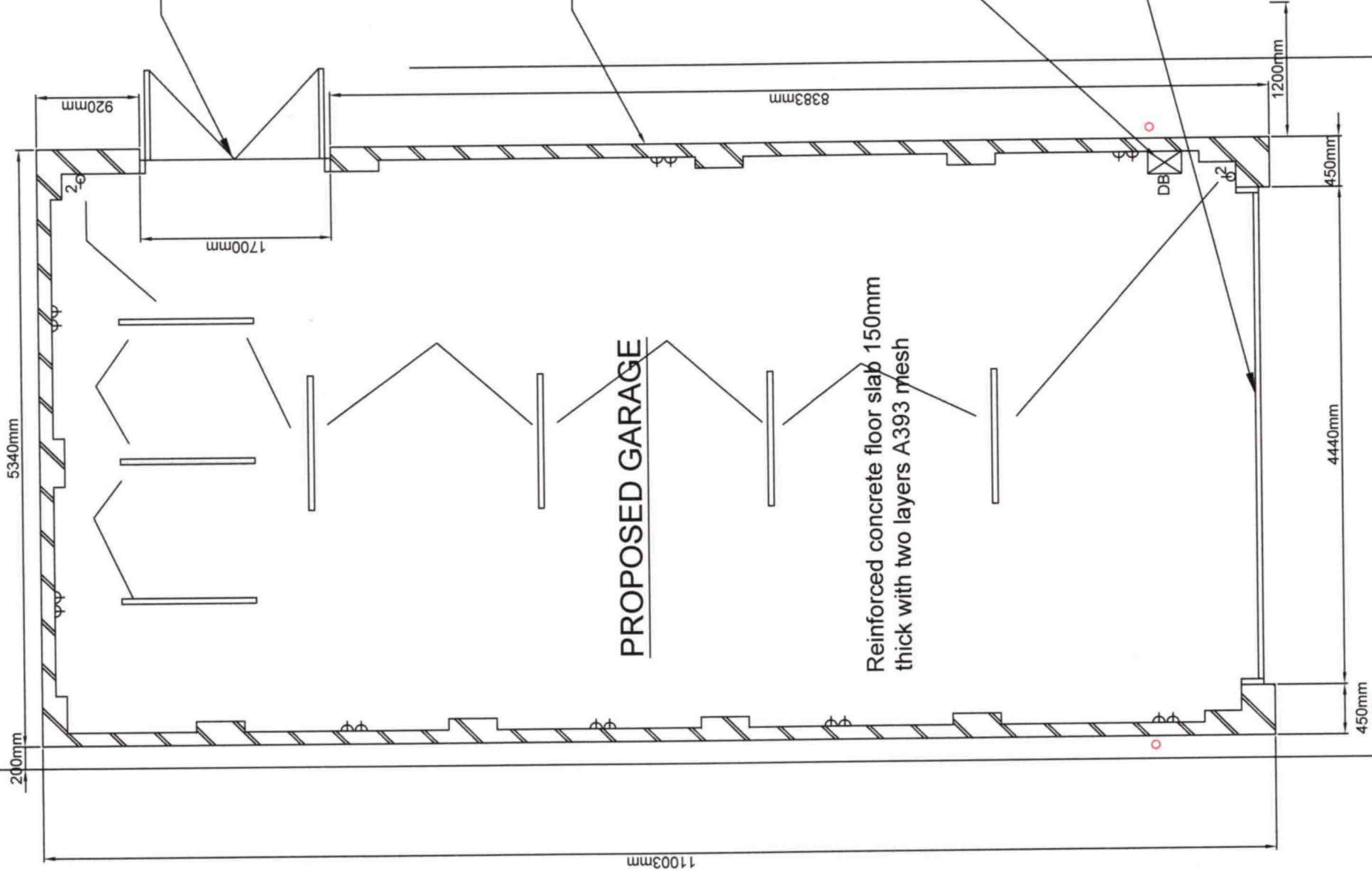

**PROPOSED GARAGE  
 FLOOR PLAN**