

Alastair Barclay  
 Surveying and Building Consultant  
 Smiddy House  
 Shiresmill  
 Dunfermline  
 Fife  
 KY12 8ER  
 Mobile 07792 751 924  
 Email - ali.b20@btinternet.com

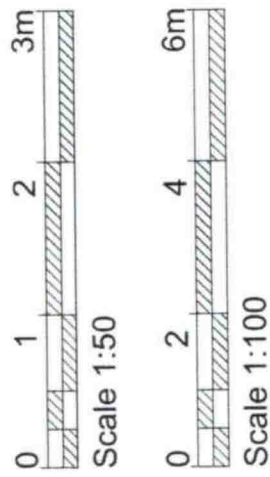

DWG NO - HOP 008

**PROPOSED GARAGE  
 AND VARIOUS ALTERATIONS TO THE  
 EXISTING HOUSE  
 AT 79 HOPE STREET,  
 INVERKEITHING, FIFE,  
 KY11 1LN**

**FOR MR & MRS O. PADILLA**

**SCALE 1:100**

**Date - September 2023**

This drawing is for the Building V...  
 plans for t...  
 Signed.....  
 Date.....  
 All sizes must be checked on-site and verified by the Contractor

New porch to rear elevation.  
 New 100mm UPVC drain securely fixed to the underside of the existing kitchen ceiling with new stack venting externally through new slate vent. All new connections to be made separately and new ceiling formed and acoustically insulated to conceal pipework.  
 New rainwater drain trapped at base with 110mm UPVC underground drain laid to falls at minimum 1:80 connected to existing drainage and new rodding eye formed to aid maintenance of the drainage.

New 100mm extract fan to provide 15 litres / sec extract from the new cloakroom - terminates in slate vent on the new roof.  
 New sanitary ware connected to the existing external 100mm soil drain.  
 Existing window removed and opening infilled with 100mm fair faced block externally vented with new insulated timber kit inside - see specification.  
 New trickle vent fitted above door to provide 12,000mm<sup>2</sup> of free ventilation area.

Existing door opening infilled with new timbers studs and plasterboard each side, skim coated and skirting patched each side to match existing

**Note - All new / altered electrical work must comply with BS7671: 2008.**  
**Note - Smoke and Heat Detection:**  
 New heat detector to be fitted to kitchen and smoke detector to be fitted to lounge and hall.  
 All sensors must comply with BS 5446

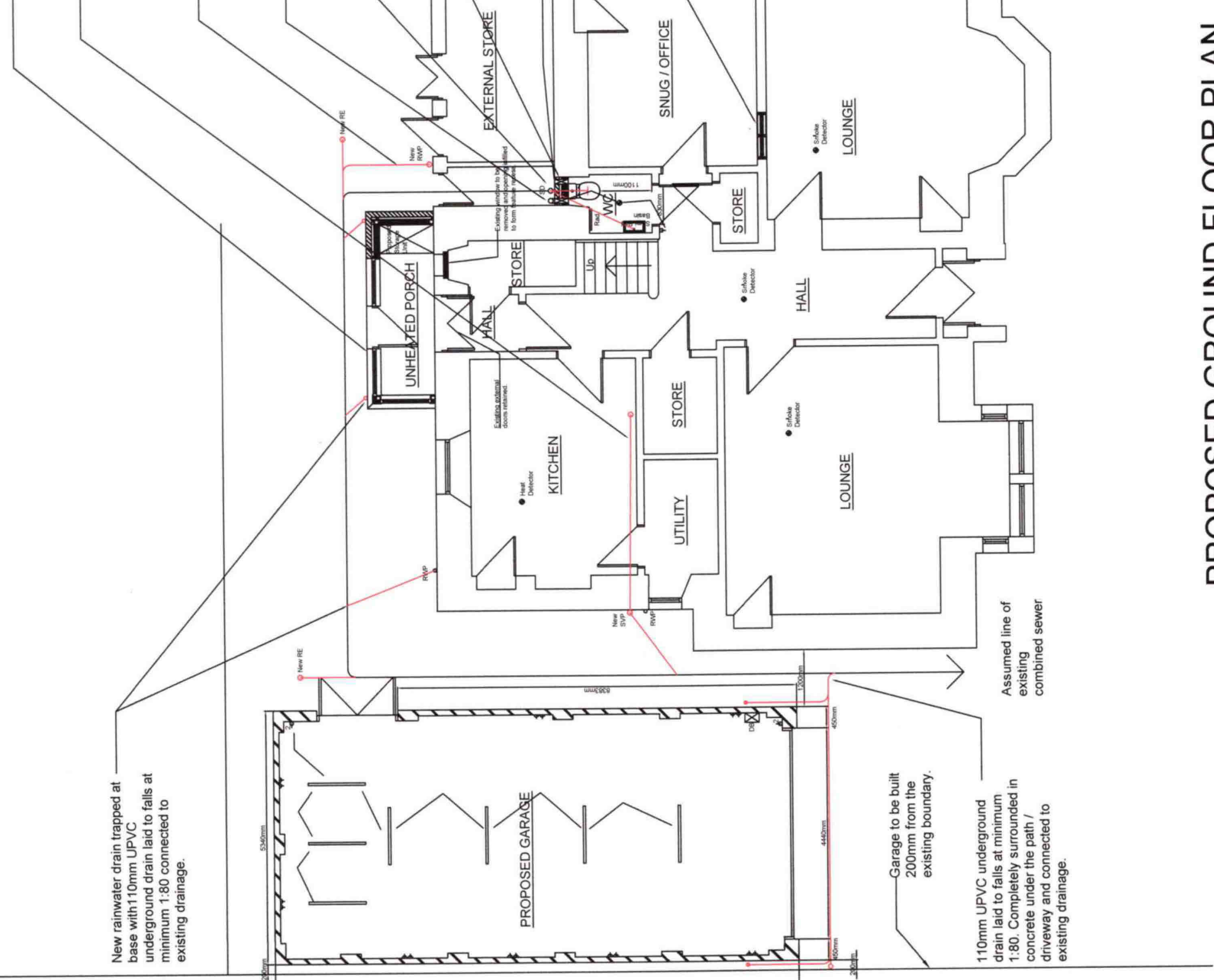

**PROPOSED GROUND FLOOR PLAN**