

Alastair Barclay  
 Surveying and Building Consultant  
 Smiddy House  
 Shiresmill  
 Dunfermline  
 Fife  
 KY12 8ER  
 Mobile 07792 751 924  
 Email - ali.b20@btinternet.com

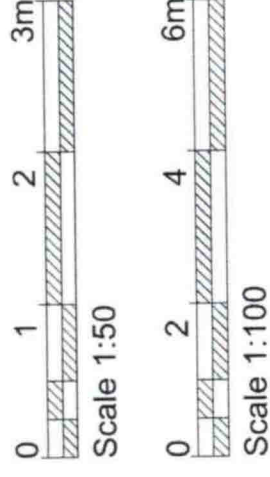

DWG NO - HOP 012

PROPOSED GARAGE  
 AND VARIOUS ALTERATIONS TO THE  
 EXISTING HOUSE  
 AT 79 HOPE STREET,  
 INVERKEITHING, FIFE,  
 KY11 1LN

FOR MR & MRS O. PADILLA

SCALE 1:50

Date - September 2023

This drawing has been produced for Planning Permission and a true copy of the



All sizes must be checked on site and verified by the Contractor

Garage to be built 200mm from the existing boundary.

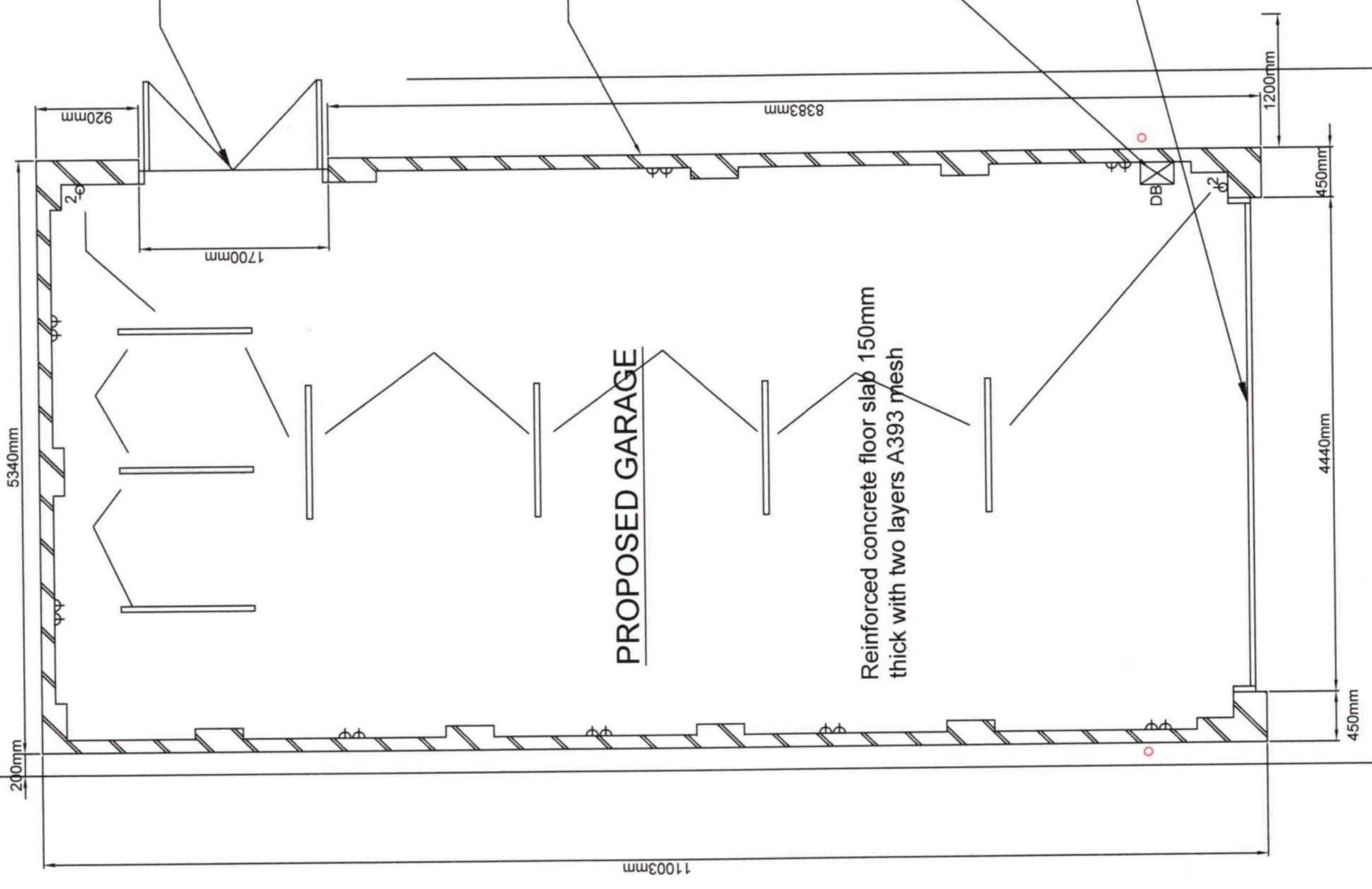

Double outward opening UPVC glazed doors with low access threshold.

100mm concrete block in superstructure with a minimum compressive strength of 7.30N/mm<sup>2</sup>

New distribution board in garage to have total RCD protection.

Up and over garage door to front elevation.

# PROPOSED GARAGE FLOOR PLAN

## PROPOSED GARAGE

Reinforced concrete floor slab 150mm thick with two layers A393 mesh