

LOCATION PLAN 1:1250

BLOCK PLAN 1:500

Alastair Barclay
 Surveying and Building Consultant
 Smiddy House
 Shiresmill
 Dunfermline
 Fife
 KY12 8ER
 Mobile 07792 751 924
 Email - ali.b20@btinternet.com

79 Hope Street, Inverkeithing, KY11 1LN

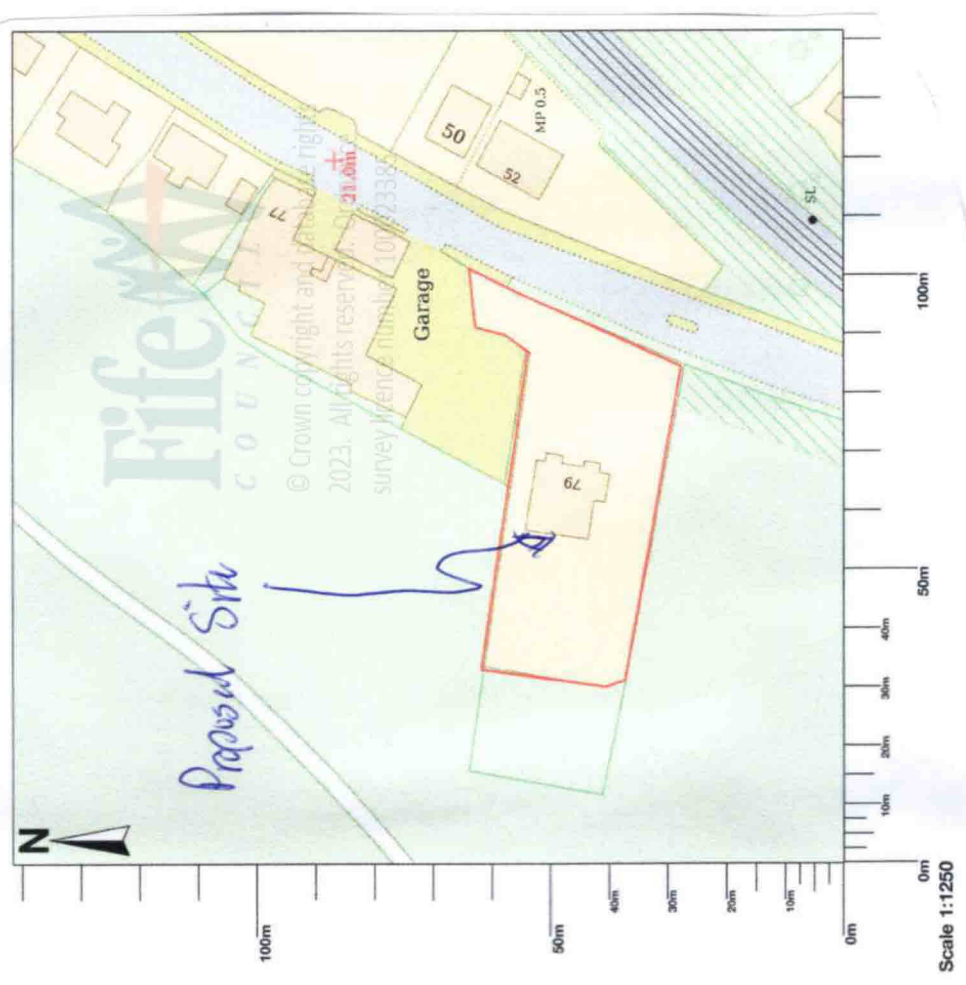

NORTH

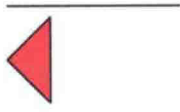

PROPOSED
SITE

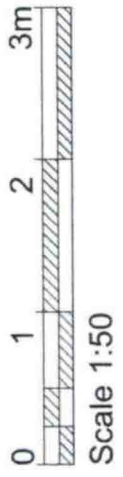
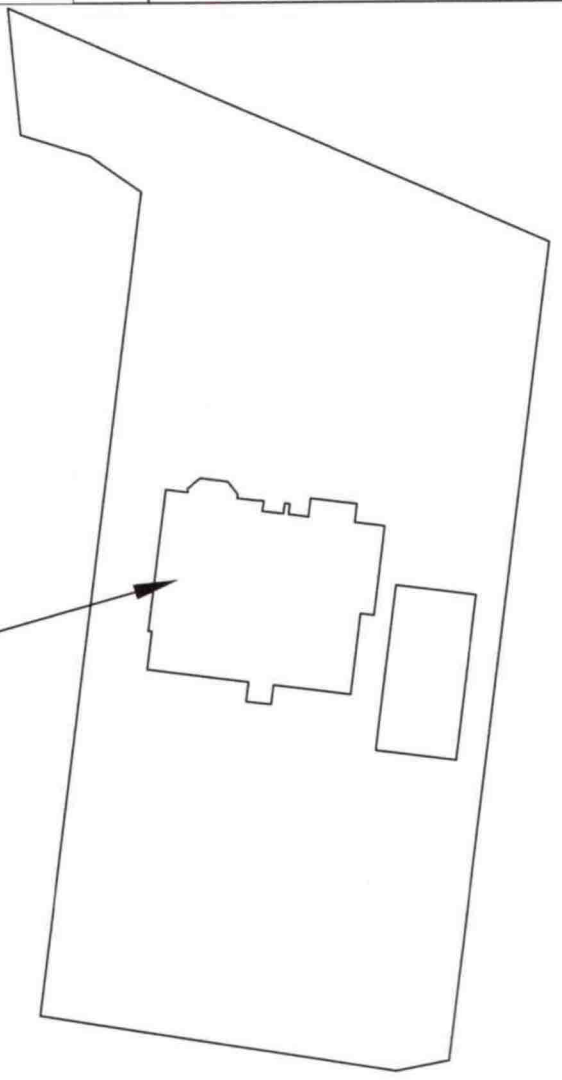

Scale 1:50

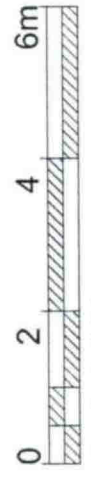

Scale 1:100

DWG NO - HOP 0013

PROPOSED GARAGE
 AND VARIOUS ALTERATIONS TO THE
 EXISTING HOUSE
 AT 79 HOPE STREET,
 INVERKEITHING, FIFE,
 KY11 1LN

FOR MR & MRS O. PADILLA

SCALE 1:100

Date - September 2023

This drawing has been produced for Planning Permission and Building Plans. It is not to be used as a copy of the original plans.

Signed

Date



All sizes must be checked on site and verified by the Contractor