

Alastair Barclay  
 Surveying and Building Consultant  
 Smiddy House  
 Shiresmill  
 Dunfermline  
 Fife  
 KY12 8ER  
 Mobile 07792 751 924  
 Email - ali.b20@btinternet.com

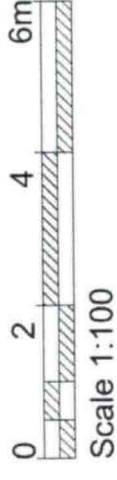
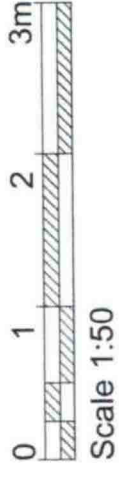

DWG NO - HOP 003

**PROPOSED GARAGE  
 AND VARIOUS ALTERATIONS TO THE  
 EXISTING HOUSE  
 AT 79 HOPE STREET,  
 INVERKEITHING, FIFE,  
 KY11 1LN**

**FOR MR & MRS O. PADILLA**

**SCALE 1:100**

**Date - September 2023**

This drawing has been produced for Planning Permission and Building W... true copy of the plans for t...

Signed.....

Date.....

All sizes must be checked on site and verified by the Contractor

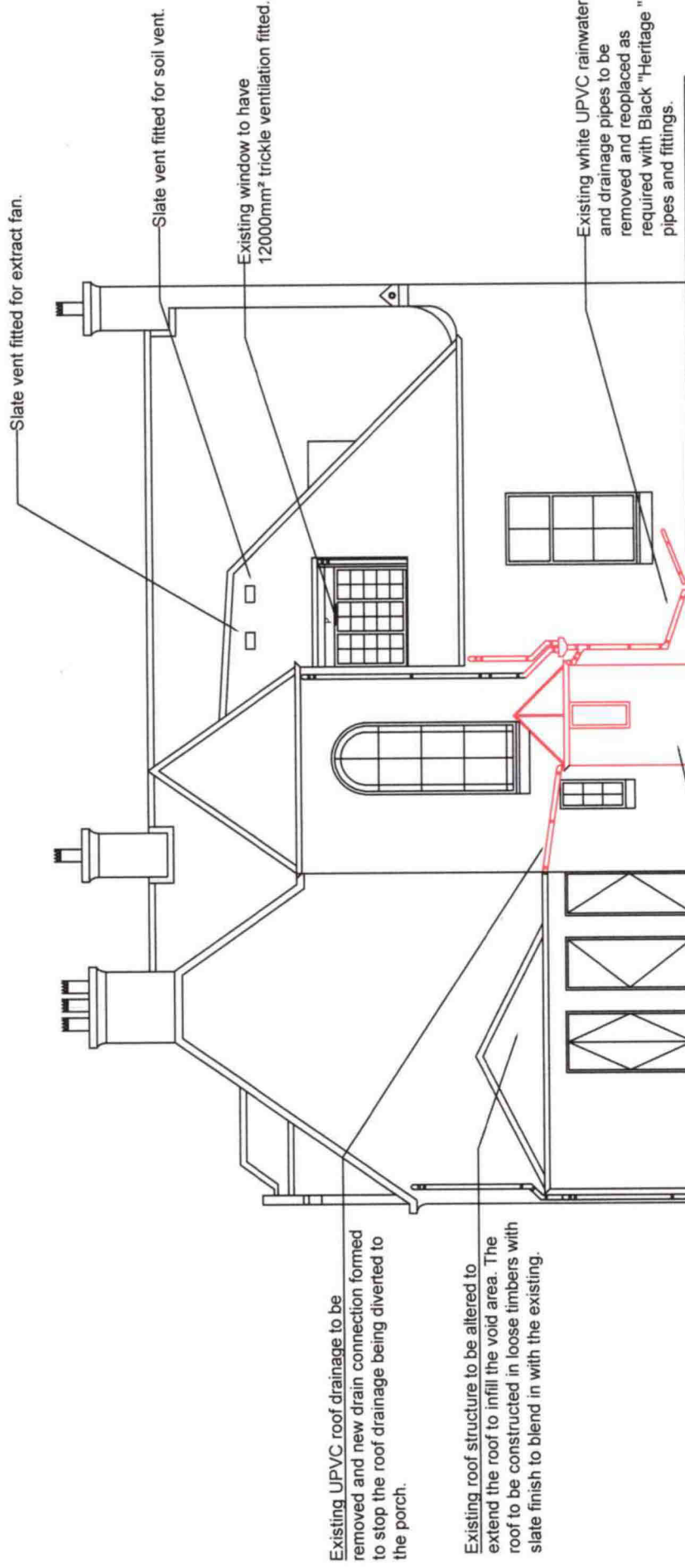

Existing "1970's" timber channel lined porch to be carefully taken down and removed from site - the existing base to be grubbed up to allow new structure to be built.

**EXISTING REAR ELEVATION**

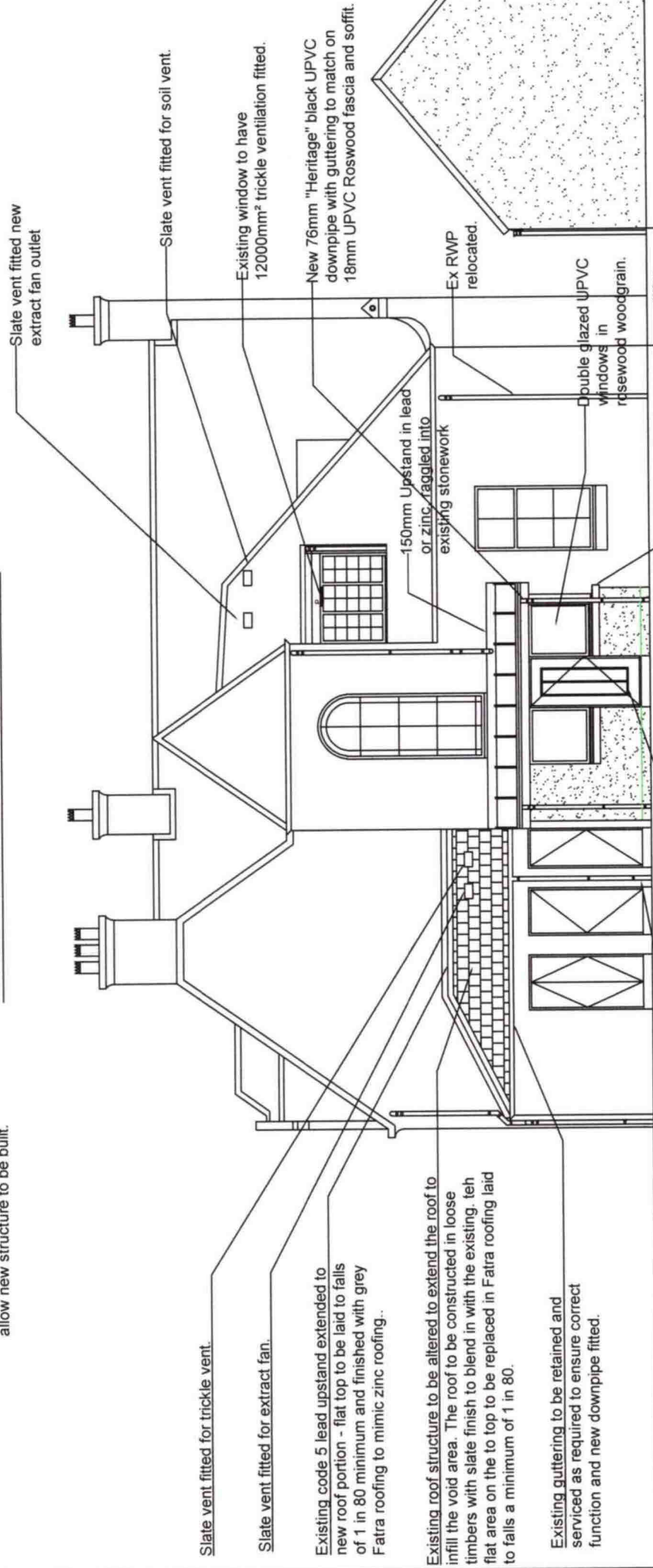

**PROPOSED REAR ELEVATION**

**New Garage Shown**

**Proposed New Garage  
 - see detail drawings**