

Notes:
 This drawing is the sole copyright of KPP Architects Ltd and reproduction in any form is forbidden unless permission is obtained in writing.
 Do not scale from this drawing. Any discrepancies on site should be brought to the attention of KPP Architects Ltd.
 Work and materials must comply with the current building regulations and codes of practice and be read in conjunction with building specifications and other sub-contractors information. All materials are to be installed in strict accordance with the recommendations of the manufacturers.

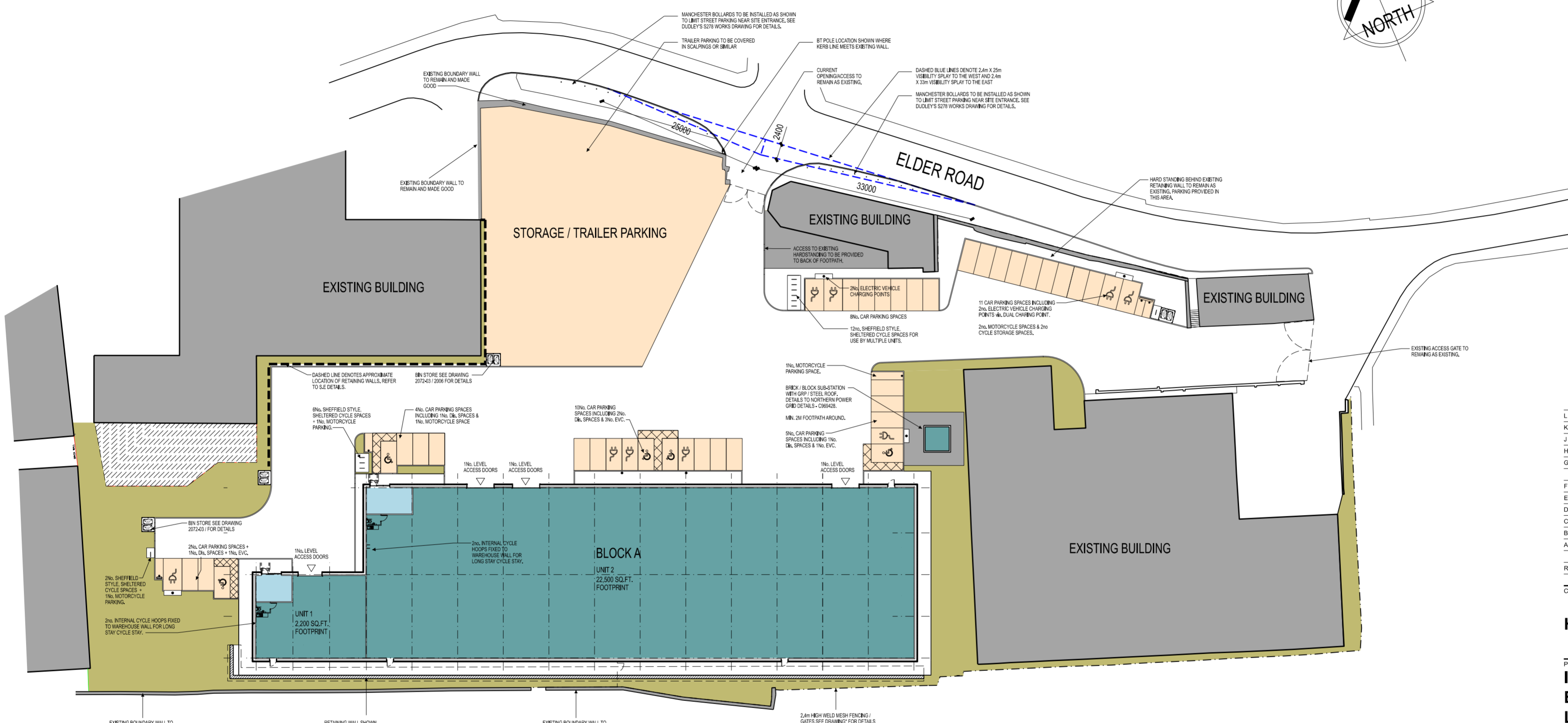
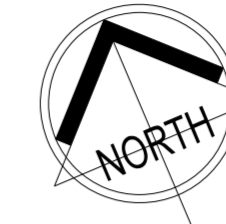

SCHEDULE OF AREAS

BLOCK A		
UNIT 1 -	300 SQFT OFFICE	22,200 SQFT WAREHOUSE
		22,500 SQFT TOTAL
UNIT 2 -	200 SQFT OFFICE	2,000 SQFT WAREHOUSE
		2,200 SQFT TOTAL
OVERALL BUILDING AREAS - 24,700 SQFT		
SITE AREA - 2.25 ACRE		

— DICTATES APPROXIMATE LOCATIONS OF DOUBLE YELLOW LINES FOR PARKING CONTROL. EXACT LOCATIONS TBA.

L	SUB-STATION ADDED.	SF	31.10.23
K	VISIBILITY SPLAYS ADDED	SF	06.06.23
J	GENERAL AMENDMENTS MADE ACROSS SITE.	SF	16.03.23
H	MAIN YARD ENTRANCE MOVED.	SF	01.02.23
G	BIRD MOUTH FENCE REMOVED.	SF	04.01.23
	YELLOW LINES ADDED.		
F	AMENDMENTS MADE FOR PLANNING CHANGES	SF	14.07.22
E	EXIT ACCESS REMOVED	SF	23.09.21
D	GENERAL AMENDMENTS MADE FOR PLANNING	SF	09.09.21
C	ALTERATIONS TO OVERALL SCHEME	SF	04.06.21
B	AMENDED IN LINE WITH CONSULTTEE COMMENTS	SF	02.05.18
A	ALTERATIONS TO BLOCK C YARD	JB JM	02.07.18

Client
HAROLD NEWSOME LTD
 Project Title
**INDUSTRIAL DEVELOPMENT
 ELDER ROAD
 LEEDS**

Drawing Title
SITE LAYOUT PLAN

KPP ARCHITECTS
 Lodge House
 12 Town Street
 Horsforth, Leeds LS184RJ
 T : +44 (0) 113 2390460
 E : architects@kpp-leeds.co.uk
 W : www.kpp-leeds.co.uk

Scale	Size	Date	Drawn	Checked
1:500	A2	JAN'18	DR	.
Status	PLANNING			
KPP Job No	2072-03			Rev
Number	2000			L