

© Crown copyright and database rights. 2023. Ordnance Survey 0100031673 Created using Plans by Emapsite

Scale: 1:2500 Paper Size: A4

Notes:
Proposed Agricultural Building, Rookery Farm,
Wenham Road, Washbrook, Suffolk, IP8 3EZ

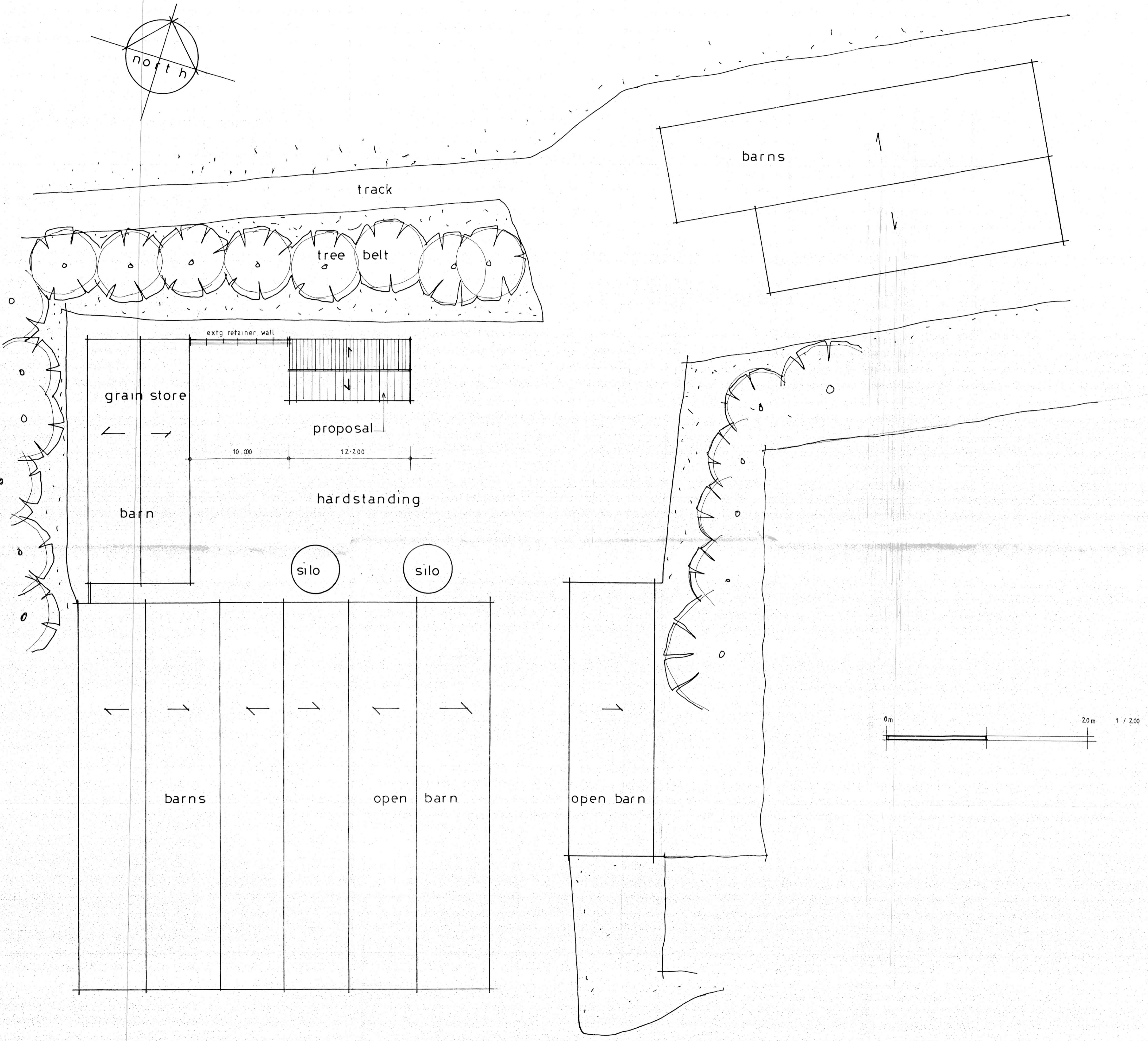

<p>dean jay pearce architectural design & planning ltd 2 / 3 Milestone, Hall Street, Long Melford Sudbury, Suffolk, CO10 9HZ T: 01787-378797 E: dean.pearce@live.co.uk</p>		
<p>Project: Proposed agricultural structure (to house grain dryer).</p>		
<p>Site Address: Rookery Farm, Wenham Road, Washbrook, Suffolk, IP8 3EZ</p>		
<p>Applicant: H M Partridge & Company Ltd</p>		
<p>Drawing title: Existing / Proposed Block Plan</p>		
<p>scales: 1:200 (A1) date: 10 / 2023 drawn: checked:</p>	<p>drg no: 23/82/01</p>	<p>rev:</p>
<p>Do not scale this drawing. Use figured dimensions only. Contractor to set out all of the works prior to commencement and report any omissions / discrepancies immediately. Scales shown on this drawing are at A1 sheet size.</p>		
<p>This drawing & information are Copyright. ©</p>		