

01 Sign Elevation 1:5
 PL(6-001) Proposed fascia sign lighting

carhartt
 WORK IN PROGRESS

Single strip LED lights mounted on back-side of sign
 Colour temperature: 4500 K
 Lumen output: 2000 / 2500

02 Sign Elevation 1:2
 PL(6-001) Proposed fascia sign lighting

car

03 Sign Section 1:2
 PL(6-001) Proposed fascia sign lighting

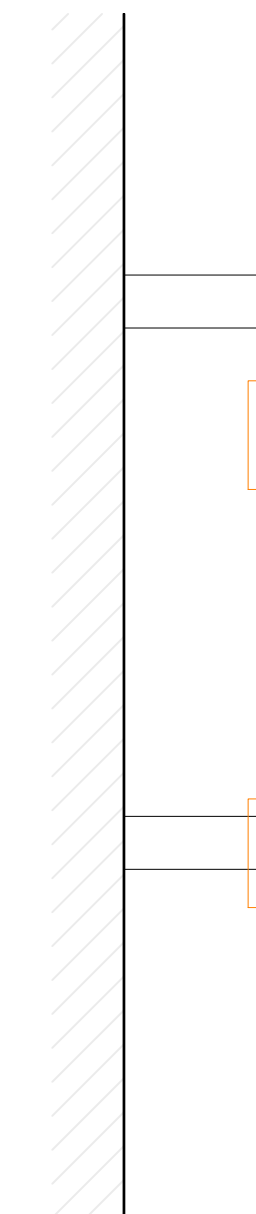

General notes
 All dimensions to be checked on site. Do not scale from drawings. Only written dimensions to be respected. Errors to be reported immediately to the architect. To be read in conjunction with all relevant drawings and specifications. All existing site, tree and building information has been compiled from different sources. Dimensions to be verified before proceeding with work. Any areas indicated are approximate and indicative only. © Marini O'Shea Limited

| Rev. | Date | Description | Initial |
|------|------|-------------|---------|
| | | | |
| | | | |
| | | | |
| | | | |
| | | | |
| | | | |
| | | | |
| | | | |
| | | | |
| | | | |

Rev. Date Description Initial

0 0.025 0.05 0.1m



Marini O'Shea architects



studio@marinioshea.com
 +44 (0) 141 328 1323
 www.marinioshea.com

Drawing name: Proposed fascia sign lighting
 Drawing number: PL(6-001)

Date: 08.2023
 Scale: Various scale @A1
 Status: Planning
 Revision: --

Project: 14-16 South Frederick Street
 Glasgow
 G1 1HJ
 Project number: 165

Client: Carhartt WIP