

Isometric View - Proposed

NTS

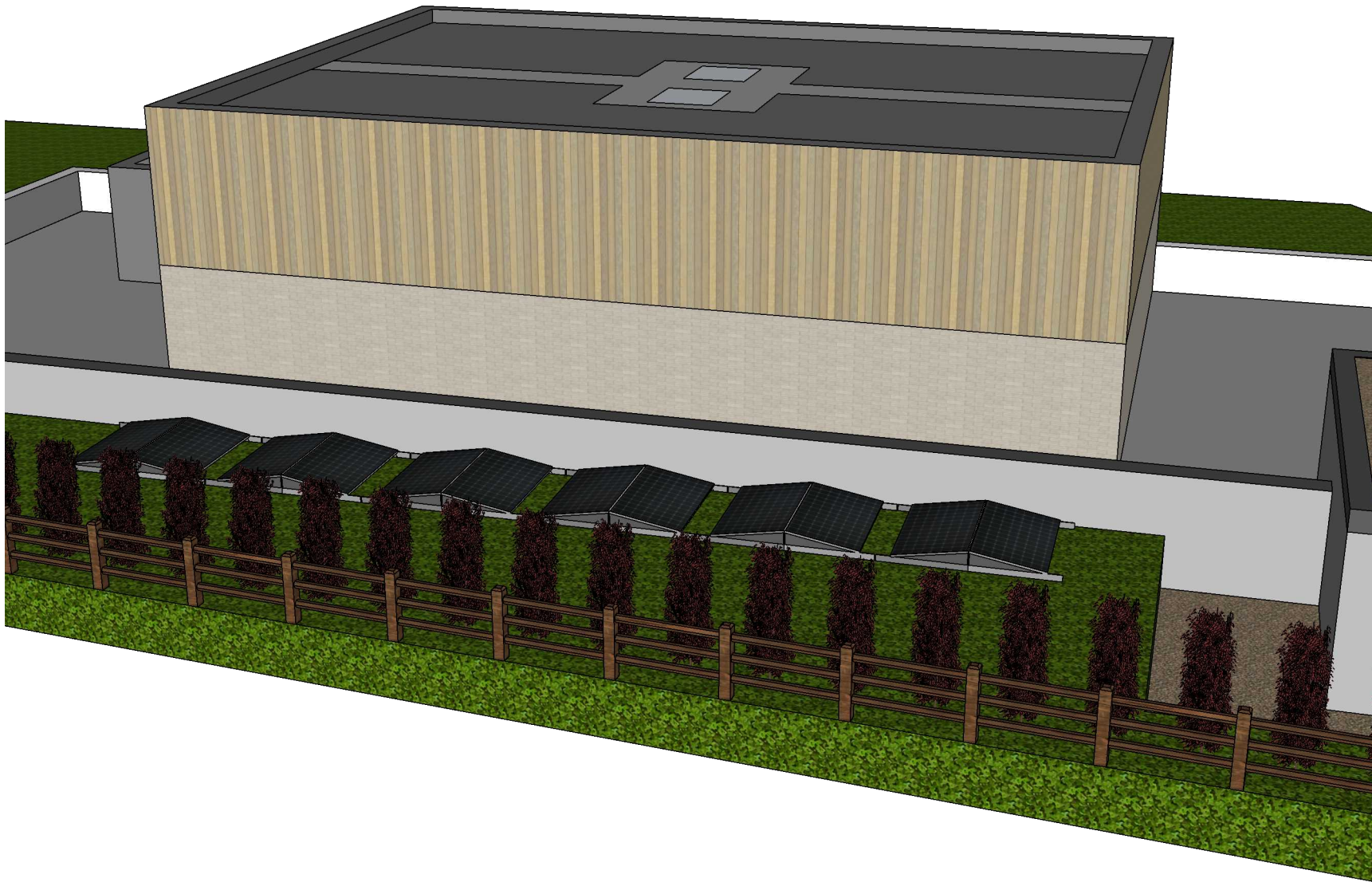

SPIRIT
ENERGY

Spirit Energy

44 Portman Road, Reading, Berkshire,
RG30 1EA

Telephone: 01189514490 Fax:
01189514499

SITE

3 Windgate Meadow
RG29 1FZ

DESCRIPTION

Isometric View
Proposed and Existing

CLIENT

Mr A Pearson

DATE 31/10/2023	SCALE NTS@A4
DRAWN MGA	DRAWING NO. 33349-1
	REV B