

Roof Plan

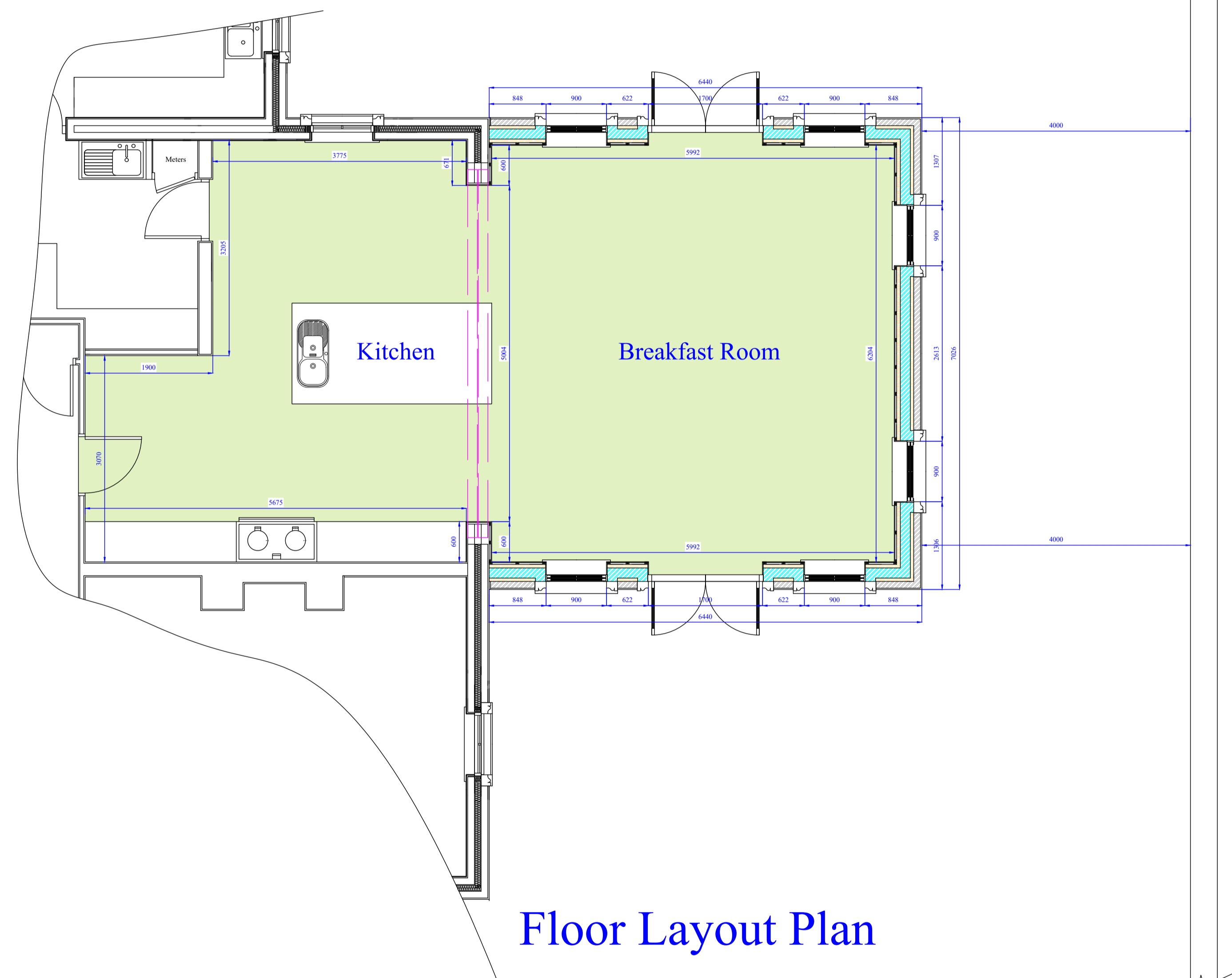

Floor Layout Plan

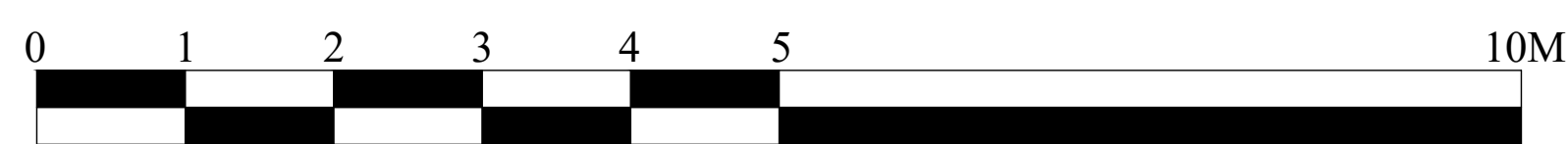
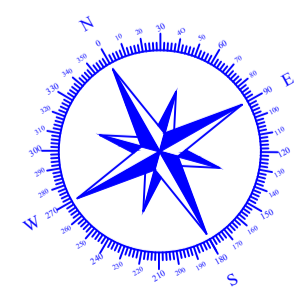

METRIC SCALE BAR

©YEOMAN ARCHITECTURE LIMITED  
 Copyright of this plan is retained by  
 YEOMAN ARCHITECTURE LIMITED  
 No part should be copied or reproduced without  
 the express permission of the copyright holder.

ALL DIMENSIONS MUST BE CHECKED ON-SITE  
 AND NOT SCALED FROM THIS DRAWING.  
 ANY DISCREPANCIES MUST BE REPORTED TO YEOMAN LIMITED  
 Whilst every effort has been made to ensure the accuracy of this plan and  
 specification, Contractors should make their own full assessment  
 of the site conditions therein, always prior to commencement of works on-site.

No.	Revision / Amendment List	Date

YEOMAN ARCHITECTURE LIMITED  
 is a Registered Professional Practice with the  
 Chartered Institute of Architectural Technologists

**YEOMAN**  
Architecture

Suite 6  
 5 Kings Mount  
 Ramparts Business Park  
 Berwick Upon Tweed  
 Northumberland  
 TD15 1TQ

Telephone: 01289 303960  
 E-Mail: yeomandesign@aol.com

Yeoman Architecture Limited  
 Registered in England & Wales Company Number: 1895249

Name:	Mr Robert Whitten
Project Address:	West Longridge Manor West Longridge Farm Berwick Upon Tweed Northumberland TD15 2JX
Project:	Proposed Single Storey Side Extension
Sheet Title:	Layout Plan As Proposed
Scale:	1.50 @ A1 Size
Date:	25th October 2023
Designed By:	James Cromarty <small>MEMBER OF THE INSTITUTE OF REGISTERED ARCHITECTS</small> Direct Mobile No: 0772 969 0520
Drawing No:	A108
Plan Ref:	RW/1541/23

