

58-60 WESTOW HILL

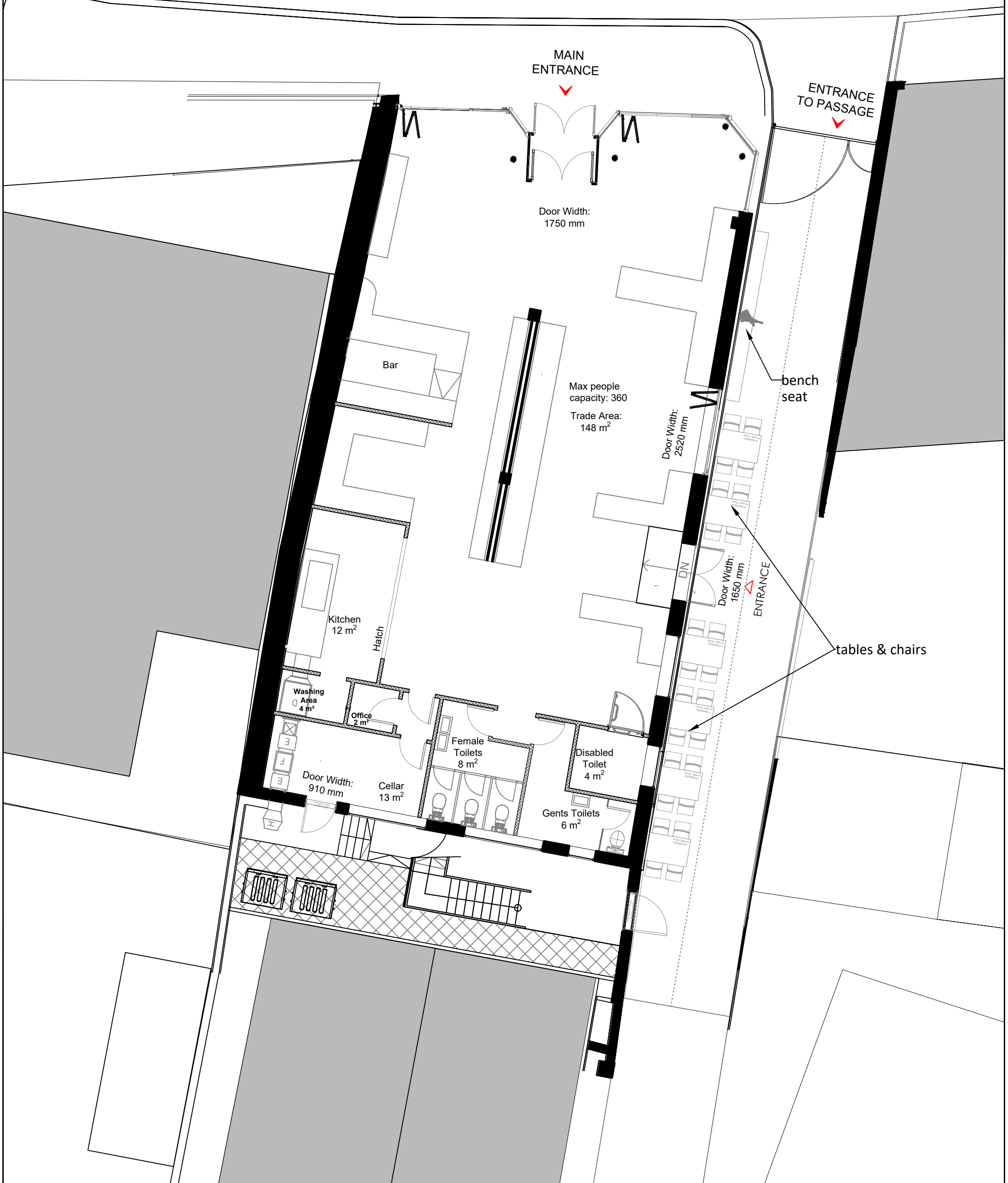

PROPOSED GROUND FLOOR PLAN
SCALE 1:100

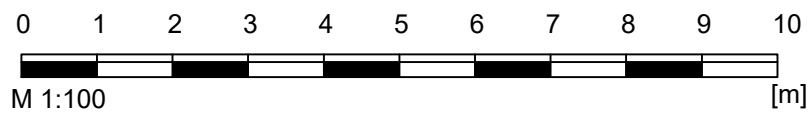

PLANNING

	<p>NOTES:</p> <ul style="list-style-type: none"> - All works to be carried out in accordance with current Building Regulations - All dimensions and levels to be checked and verified on site before commencing any work and notify the architect of any errors, omissions or discrepancies. - The drawings to be read in conjunction with contract documents, project working drawings, specification and all consultants/specialist and engineers drawings, details and specification. - This drawing is made on behalf of Antic London Ltd. - Do not scale from this drawing. 	<p>Issue Notes</p>	<p>Antic London 77 Malham road, Forest Hill London, SE23 1AH</p>	<p>DRAWN by MGL, AP, DP</p>	<p>Date: 28.06.2023</p>	<p>Address : COOPERS 58-60 Westow Hill SE19 1RX</p>
				<p>Prepared on behalf of Antic London</p>	<p>Drawing Drawing n. Scale</p>	<p>Proposed Ground Floor Plan 60WH 200 GA 00 1:100 @ A3</p>