

**DRAINAGE NOTES**

- NON PERMEABLE AREA=0.10HA
- HIERARCHY OF SUDS AS FOLLOWED:
  - SOAKAWAYS SUBJECT TO INFILTRATION TESTING. THE LOCAL GROUND CONDITIONS BGS INDICATE THE UNDERLYING STRATA IS ALLUVIUM - CLAY, SILT, SAND AND GRAVEL.
  - ON RECEIVING THE SITE INVESTIGATION REPORT IF INFILTRATION IS NOT POSSIBLE SURFACE WATER TO CONNECT INTO THE RIVER.
- THE SITE IS CURRENTLY PRESENTED AS A BROWNFIELD SITE BUT FOR THE PURPOSES OF THIS CALCULATION IS CONSIDERED TO BE GREENFIELD FROM A SURFACE WATER RUN-OFF PERSPECTIVE.
- CATCHPIT MANHOLES ARE TO BE PROVIDED AT EACH END OF THE SOAKWAY TO FACILITATE ACCESS FOR MAINTENANCE AND REMOVAL OF SILT/DEBRIS. THE PROPOSED SYSTEM HAS A SERVICE LIFE IN EXCESS OF 50 YEARS.
- AN INFODRAINAGE DRAINAGE MODEL HAS BEEN PRODUCED TO MEASURE THE AREA OF IMPERMEABLE SURFACES ON THE SITE AND PERFORM A CELLULAR STORAGE CALCULATION.
- SOAK AWAY TANK HAS BEEN SIZED FOR A 1 IN 30 YEAR STORM.
- ALL PIPES HAVE BEEN DESIGN NOT TO FLOOD IN A 1 IN 30 STORM.
- ALL PIPES HAVE BEEN DESIGNED NOT TO BE SURCHARGED IN A 1 IN 1 STORM.
- ALL PIPES TO BE PLASTIC
- MINIMUM GRADIENT FOR FOUL DRAINAGE 1:40
- WATER QUALITY IN LINE WITH CIRIA SUDS MANUAL CT33.
- THE FOUL WATER SYSTEM WILL BE DESIGNED AND CONSTRUCTED IN ACCORDANCE WITH THE CURRENT BUILDING REGULATIONS, BS EN 752 DRAINAGE AND SEWER SYSTEMS OUTSIDE BUILDINGS, THE LOCAL AUTHORITY BUILDING CONTROL, SPECIFICATIONS AND REQUIREMENTS, SEWERAGE SECTOR GUIDANCE (APPENDIX C) AND THE CIVIL ENGINEERING SPECIFICATION FOR THE WATER INDUSTRY.

© COPYRIGHT, ALL RIGHTS RESERVED  
 THIS WORK IS COPYRIGHT AND CANNOT BE REPRODUCED OR COPIED IN ANY FORM OR BY ANY OTHER MEANS (GRAPHIC, ELECTRONIC OR MECHANICAL INCLUDING PHOTOCOPIING) WITHOUT THE WRITTEN PERMISSION OF POPULOUS AND LICENSE. EXPRESS OR IMPLIED. TO USE THIS DOCUMENT FOR ANY PURPOSE WHATSOEVER IS RESTRICTED TO THE TERMS OF THE AGREEMENT OR IMPLIED AGREEMENT OR IMPLIED AGREEMENT BETWEEN POPULOUS AND THE INSTRUCTING PARTY.

USE FIGURED DIMENSIONS. DO NOT SCALE. CHECK ALL DIMENSIONS ON SITE BEFORE FABRICATION OR SETTING OUT.

**GENERAL NOTES**

- DO NOT SCALE.
- THIS DRAWING IS TO BE READ IN CONJUNCTION WITH ALL OTHER RELEVANT DRAWINGS.
- SHOULD THERE BE ANY DISCREPANCY BETWEEN DETAILS INDICATED ON THIS DRAWING AND THOSE INDICATED ON OTHER DRAWINGS THE ENGINEER SHOULD BE INFORMED PRIOR TO CONSTRUCTION ON SITE.
- UNTIL TECHNICAL APPROVAL HAS BEEN OBTAINED FROM THE RELEVANT AUTHORITIES IT SHOULD BE UNDERSTOOD THAT ALL DRAWINGS ISSUED ARE PRELIMINARY AND NOT FOR CONSTRUCTION. SHOULD THE CONTRACTOR START SITE WORK PRIOR TO APPROVAL BEING GIVEN, IT IS ENTIRELY AT HIS OWN RISK.
- ALL DIMENSIONS SHOWN ARE IN METERS UNLESS NOTED OTHERWISE.
- ALL SURVEY INFORMATION IS PROVIDED BY THE SURVIVING COMPANY AND XOSQUARE LIMITED CANNOT ACCEPT ANY LIABILITY FOR ANY DISCREPANCIES THERE IN. ALL SURVEY INFORMATION TO BE VERIFIED ON SITE BY CONTRACTOR. SHOULD DISCREPANCIES BE IDENTIFIED, XOSQUARE LIMITED IS TO BE NOTIFIED IMMEDIATELY.

**LEGEND**

- SITE BOUNDARY
- PERMEABLE CAR-PARKING SPACES
- ROAD TO BE ADOPTED
- TREE PITS
- PROPOSED SURFACE WATER CARRIER DRAIN & MANHOLE
- PROPOSED FOUL WATER DRAIN & MANHOLE
- PROPOSED TRAPPED ROAD GULLY
- PROPOSED ATTENUATION
- EXISTING COMBINED SEWER
- DIRECTION OF FLOW FOR SURFACE WATER FLOODING

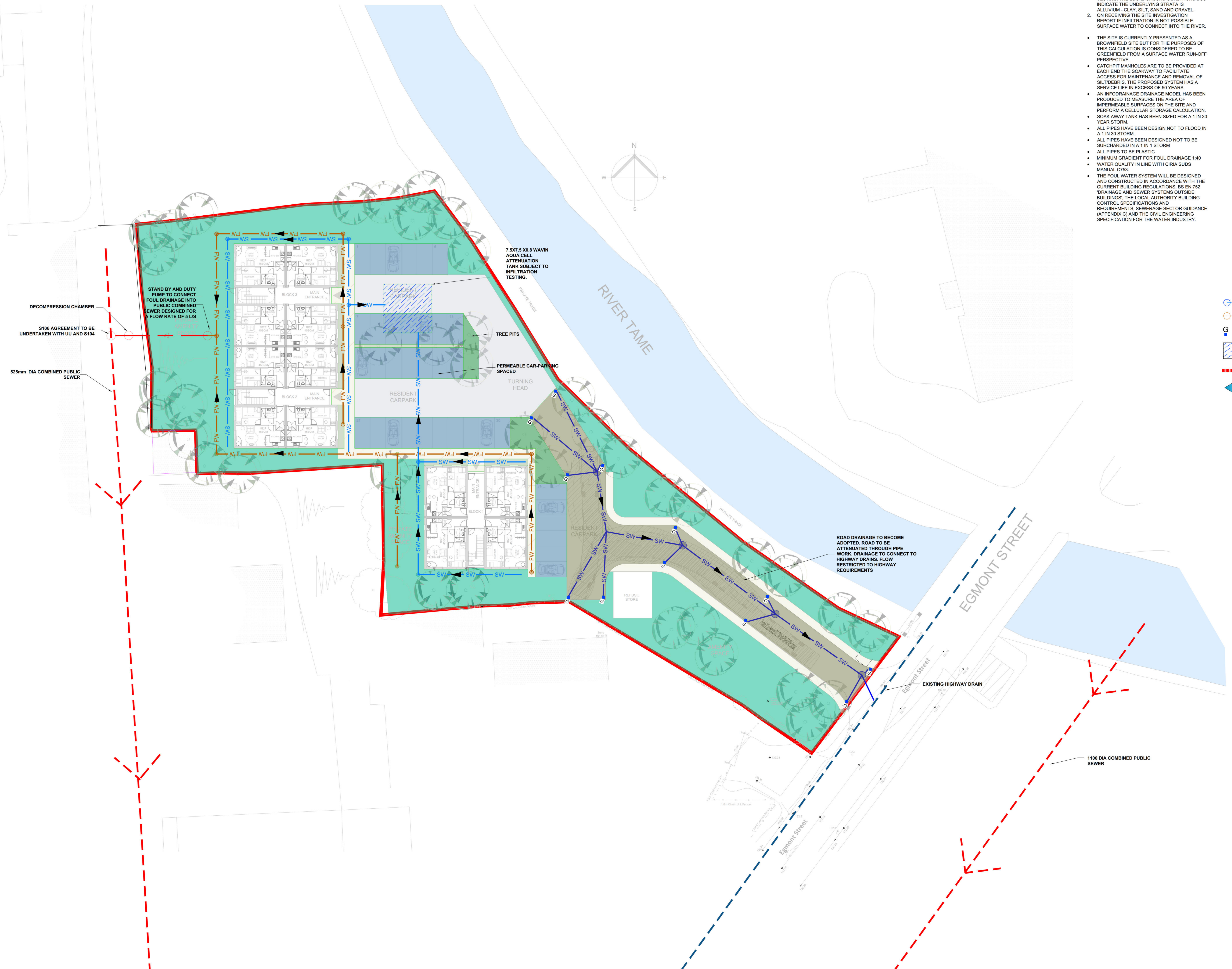

DECOMPRESSION CHAMBER  
 S106 AGREEMENT TO BE UNDERTAKEN WITH UU AND S104  
 525mm DIA COMBINED PUBLIC SEWER

STAND BY AND DUTY PUMP TO CONNECT FOUL DRAINAGE INTO PUBLIC COMBINED SEWER DESIGNED FOR A FLOW RATE OF 5 L/S

7.5x7.5 x 0.8 WAVIN AQUA CELL ATTENUATION TANK SUBJECT TO INFILTRATION TESTING.

ROAD DRAINAGE TO BECOME ADOPTED. ROAD TO BE ATTENUATED THROUGH PIPE WORK. DRAINAGE TO CONNECT TO HIGHWAY DRAINS. FLOW RESTRICTED TO HIGHWAY REQUIREMENTS

1100 DIA COMBINED PUBLIC SEWER

Rev	Date	By	Description
P01	09.10.23	PS	INITIAL ISSUE

REVISIONS	
 Vision   DESIGN   Group Engineering Consultancy	
Client	BRIDGE WATER LAND AND DEVELOPMENTS LTD
Project Name	EGMONT STREET MOSSLEY
Drawing Title	PROPOSED DRAINAGE STRATEGY
Drawing Status	INFORMATION
Drawn	PS
Approved	MW
Scale	1:200
First Issue	FRST_ISSUE
Size	A0
Job No	121
Customer	VDG
Drawn	XX
Level	XX
File	DR
Roll	C
Scale	5000
Revision	P01