

SECTION 1-1
SCALE: H 1:150, V 1:150. DATUM: 125.000

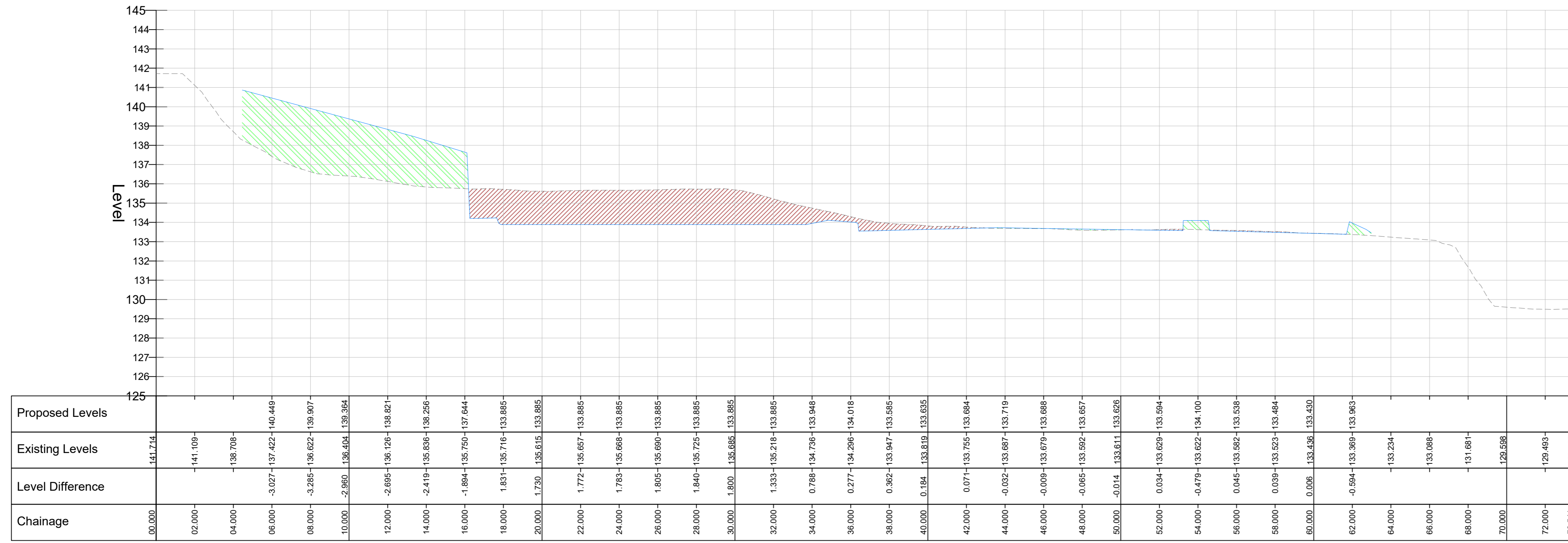

SECTION 2-2
SCALE: H 1:150, V 1:150. DATUM: 125.000

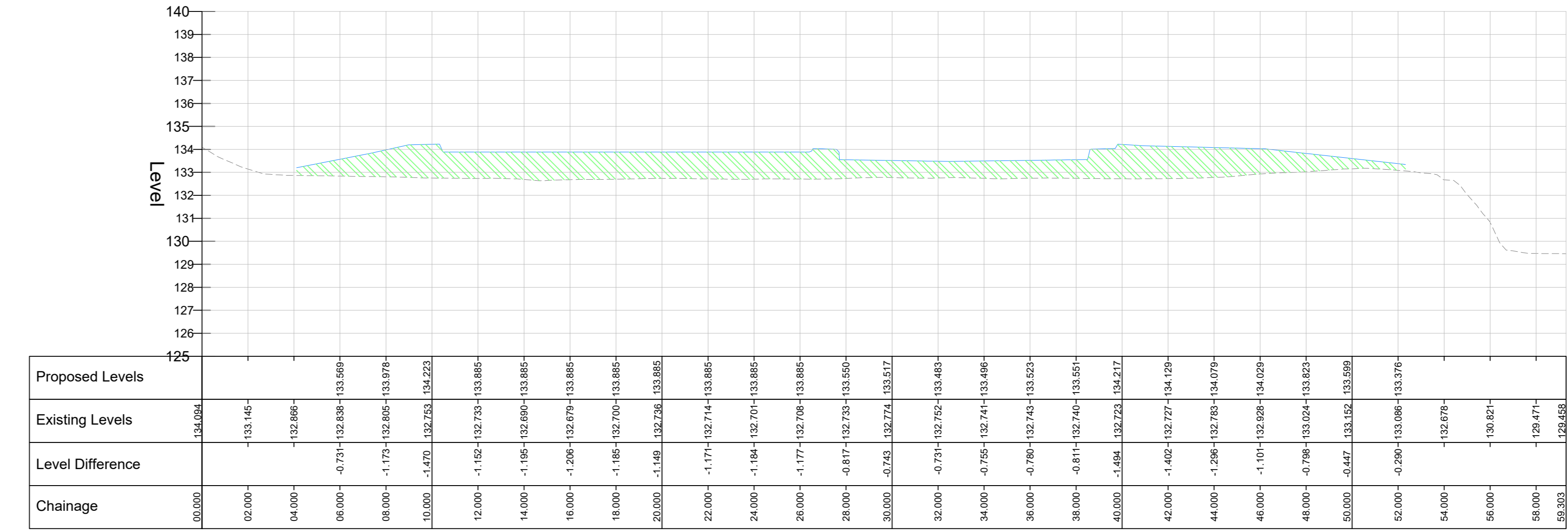

SECTION 3-3
SCALE: H 1:150, V 1:150. DATUM: 125.000

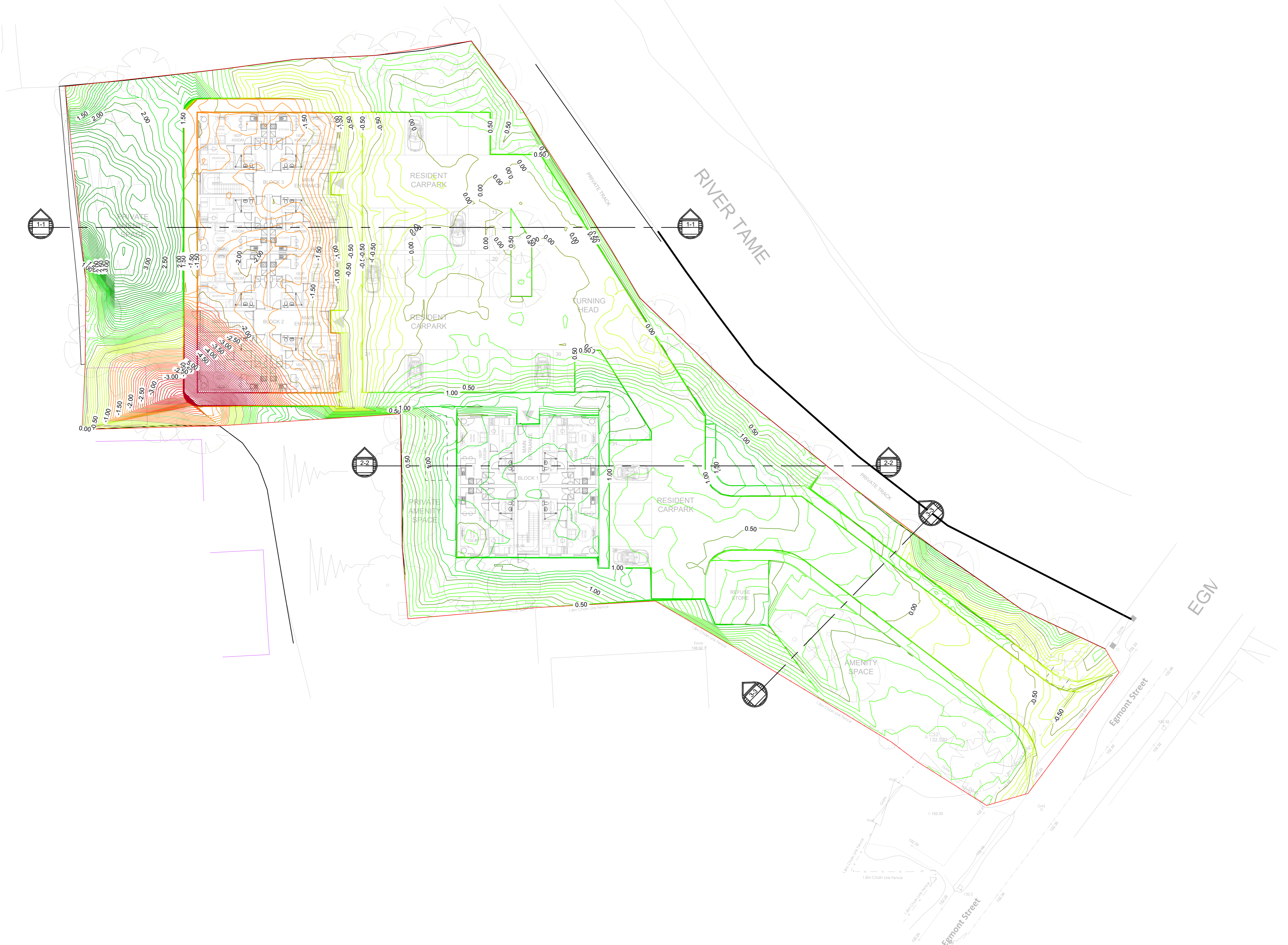
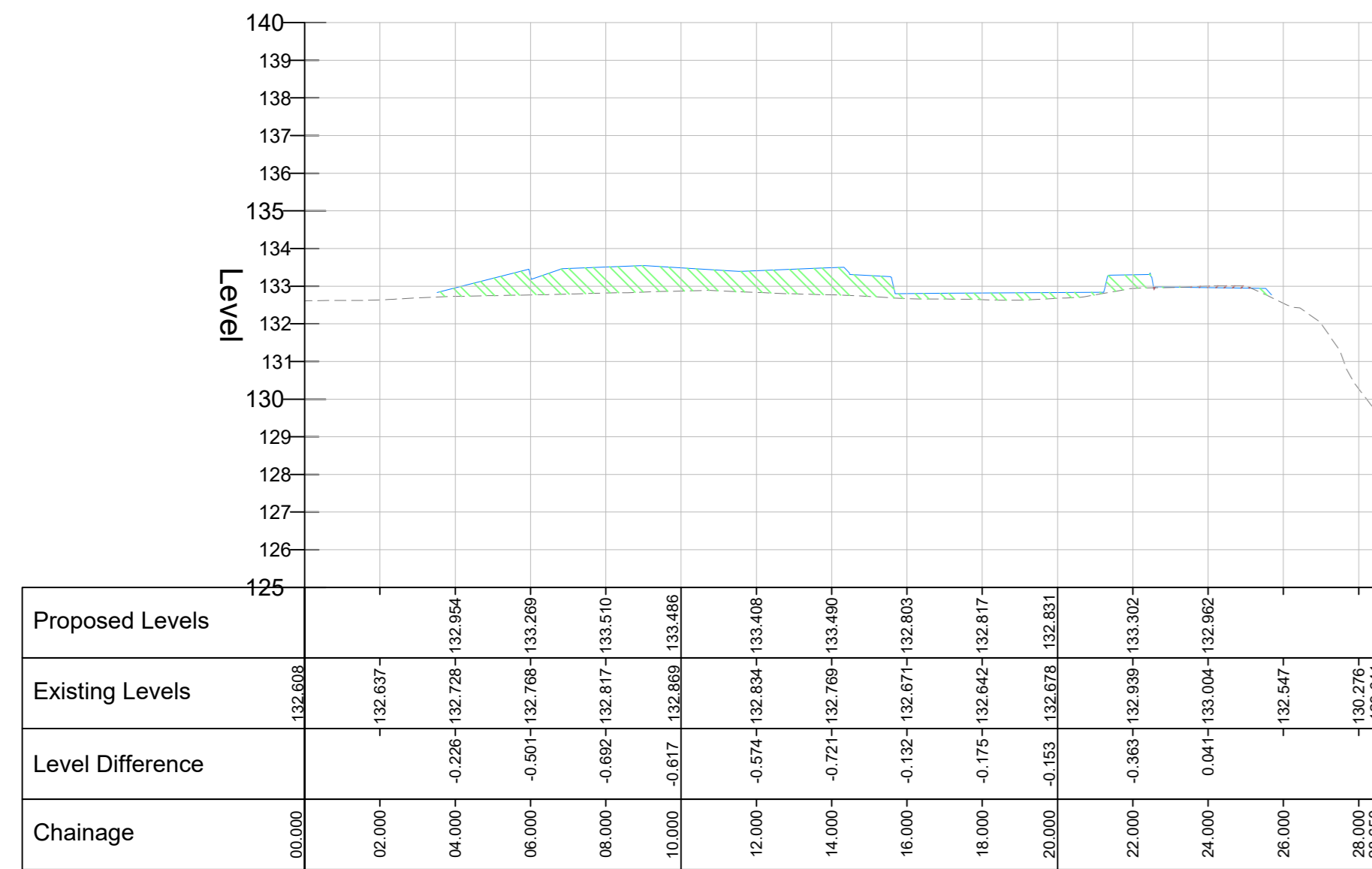

© COPYRIGHT. ALL RIGHTS RESERVED
THIS WORK IS COPYRIGHTED AND CANNOT BE REPRODUCED OR COPIED IN ANY FORM OR BY ANY OTHER MEANS (GRAPHIC, ELECTRONIC OR MECHANICAL, INCLUDING PHOTOCOPYING) WITHOUT THE WRITTEN PERMISSION OF POPULOUS AND LICENSE, EXPRESS OR IMPLIED. TO USE THIS DOCUMENT FOR ANY PURPOSE WHATSOEVER IS RESTRICTED TO THE TERMS OF THE AGREEMENT OR IMPLIED AGREEMENT OR IMPLIED AGREEMENT BETWEEN POPULOUS AND THE INSTRUCTING PARTY.

USE FIGURED DIMENSIONS. DO NOT SCALE. CHECK ALL DIMENSIONS ON SITE BEFORE FABRICATION OR SETTING OUT.

- GENERAL NOTES**
- DO NOT SCALE.
 - THIS DRAWING IS TO BE READ IN CONJUNCTION WITH ALL OTHER RELEVANT DRAWINGS.
 - SHOULD THERE BE ANY DISCREPANCY BETWEEN DETAILS INDICATED ON THIS DRAWING AND THOSE INDICATED ON OTHER DRAWINGS THE ENGINEER SHOULD BE INFORMED PRIOR TO CONSTRUCTION ON SITE.
 - UNTIL TECHNICAL APPROVAL HAS BEEN OBTAINED FROM THE RELEVANT AUTHORITIES IT SHOULD BE UNDERSTOOD THAT ALL DRAWINGS ISSUED ARE PRELIMINARY AND NOT FOR CONSTRUCTION. SHOULD THE CONTRACTOR START SITE WORK PRIOR TO APPROVAL BEING GIVEN, IT IS ENTIRELY AT HIS OWN RISK.
 - ALL DIMENSIONS SHOWN ARE IN MILLIMETERS UNLESS NOTED OTHERWISE.
 - ALL SURVEY INFORMATION IS PROVIDED BY THE SURVEYING COMPANY AND XOSQUARE LIMITED CANNOT ACCEPT ANY LIABILITY FOR ANY DISCREPANCIES THERE IN. ALL SURVEY INFORMATION TO BE VERIFIED ON SITE BY CONTRACTOR. SHOULD DISCREPANCIES BE IDENTIFIED, XOSQUARE LIMITED IS TO BE NOTIFIED IMMEDIATELY.

FORMATION DEPTHS

ROAD AND CAR PARK - 525mm
FOOTPATH - 200mm
SITE STRIP - 150mm
BUILDING FOOTPRINT - 500mm

LIDAR DATA USED IN CONJUNCTION WITH TOPOGRAPHICAL SURVEY. LIDAR ACCURACY HAS A TOLERANCE OF +/- 150mm

- LEGEND**
- FORMATION LEVEL
 - EXISTING LEVELS - POST SITE STRIP
- PROPOSED FFL MAY DEVIATE +/- 500mm DEPENDING ON THE PHASE 2 SI AND FINALISED TOPO SURVEY FOLLOWING THE REMOVAL OF THE

Rev	Date	By	Description
P1	17.07.23	MW	INFORMATION ISSUE

REVISIONS

Vision | DESIGN | Group
Engineering Consultancy

Client: BRIDGEWATER LAND AND DEVELOPMENTS

Project Name: EGMONT STREET MOSSLEY

Drawing Title: EARTHWORKS CUT AND FILL SECTION SHEET 1

Drawn	Approved	Scale	First Issue	Size			
JF	MW	1:150	FIRST ISSUE	A0			
Job No.	Company	Zone	Level	Type	Role	Drawing No.	Revision
121	VDG	XX	XX	DR	C	5506	P01