

- notes:
- The copyright of this drawing belongs to MAP Architects
  - The drawing may not be used without their consent
  - Written dimensions take preference over scaled dimensions
  - Scanned images may not be true to scale - do not scale
- revisions:    date:            description:

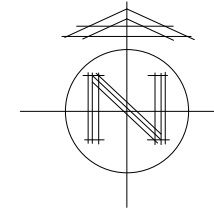

1:100

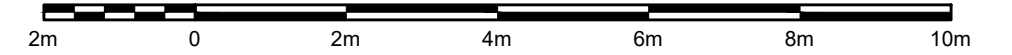

First Floor

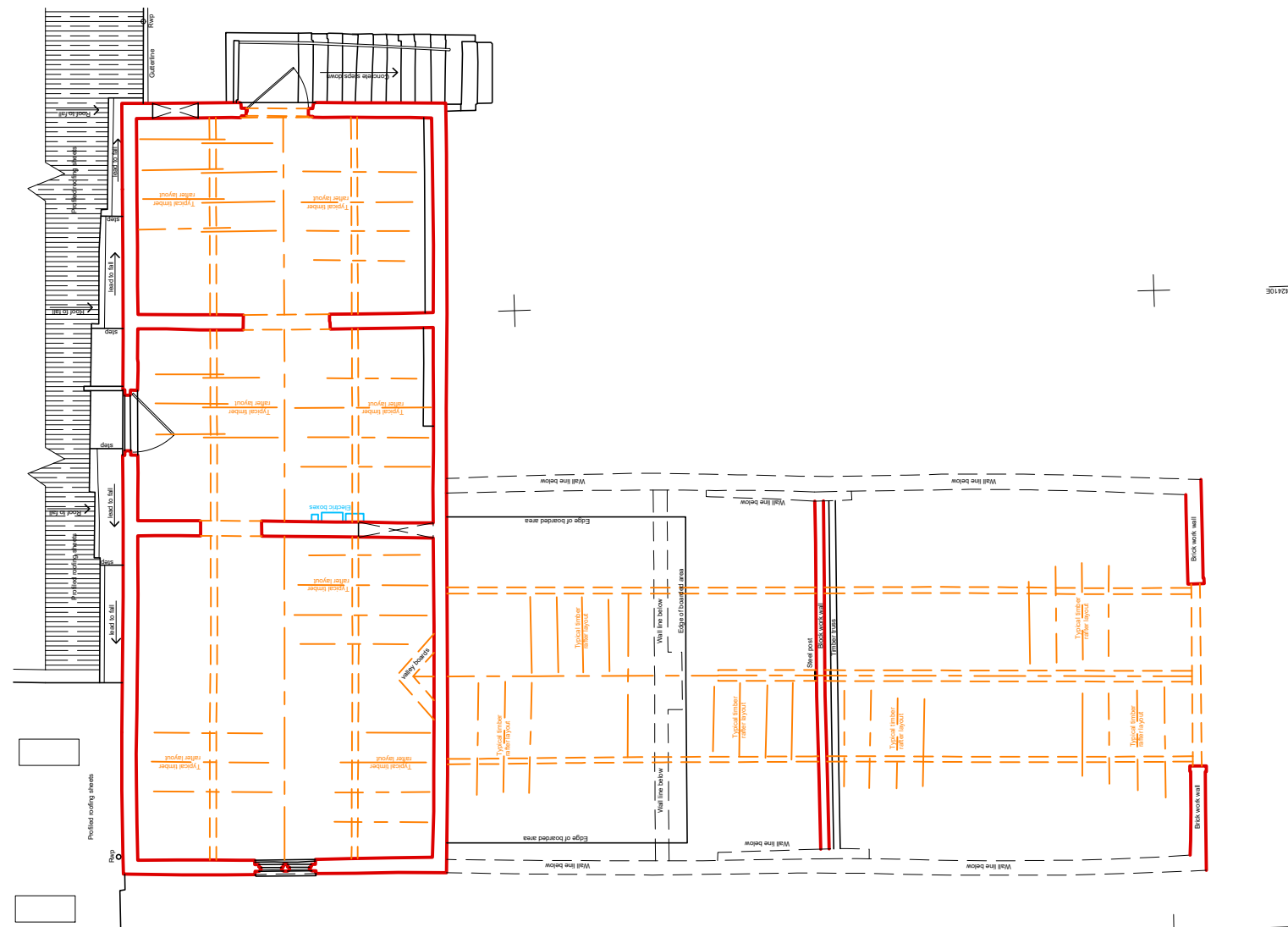

Ground Floor

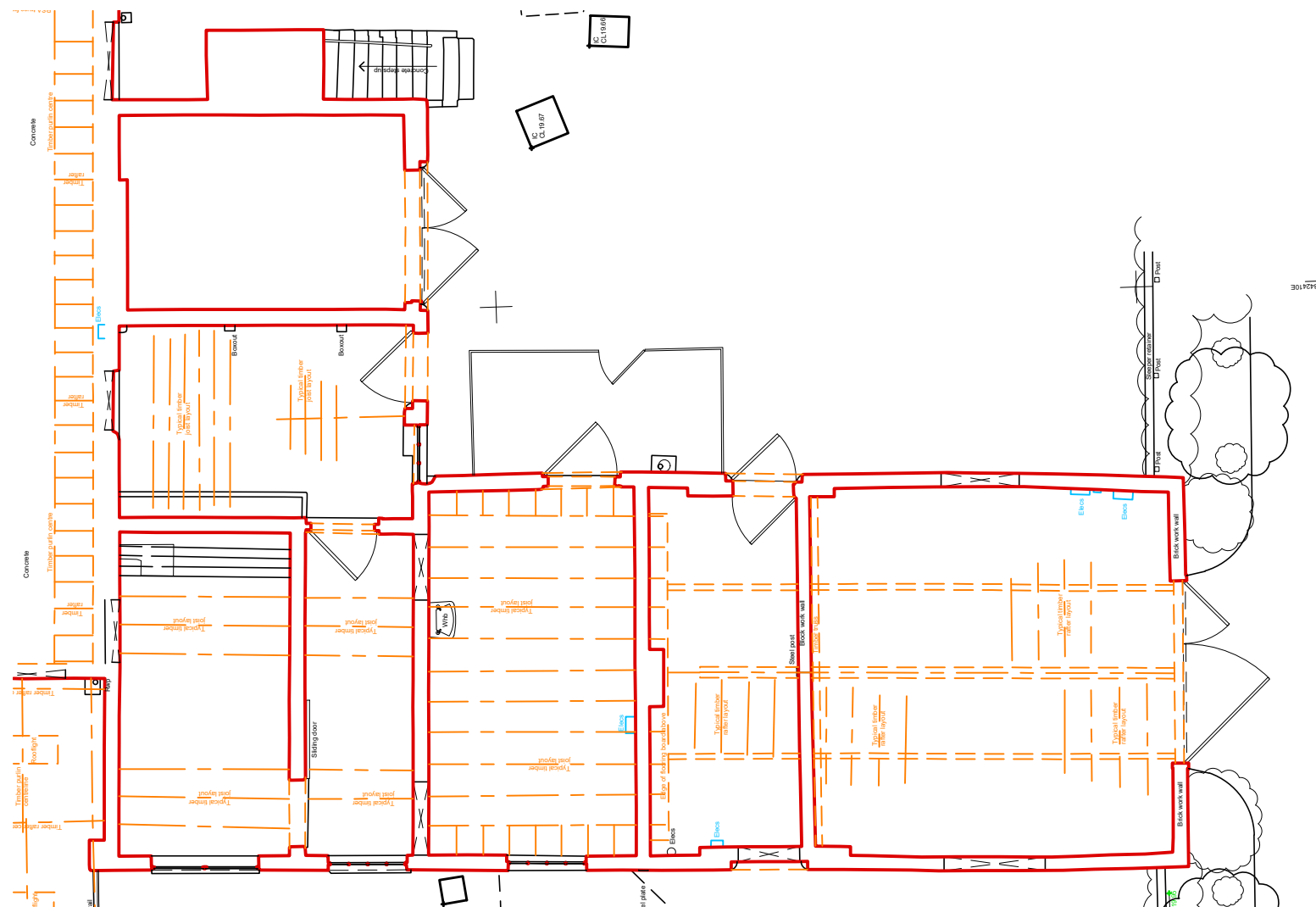

**MAP.architects**  
 Greyfriars, Neston Road, Ness, Cheshire. CH64 4AR  
 Tel: 07850 530832 email: MAP.architects@outlook.com

**Philip Feeney Ltd.**

**PROJECT**  
 Conversion of block C to residential use,  
 Lodge Farm, Farndon

**DRAWING**  
 Barn C, existing floor plans

<b>SCALE</b> 1:100 @ A3	<b>DATE</b> Sept 2023
----------------------------	--------------------------

<b>DRAWING NUMBER</b> 118.S.003	<b>REVISION</b>
------------------------------------	-----------------