

THESE ARE NOT WORKING DETAILS, they have been produced solely for the purpose of making Local Authority Applications and do not form part of any CDM requirements. All details and Dimensions to be checked and verified on site BEFORE commencement. DO NOT SCALE.

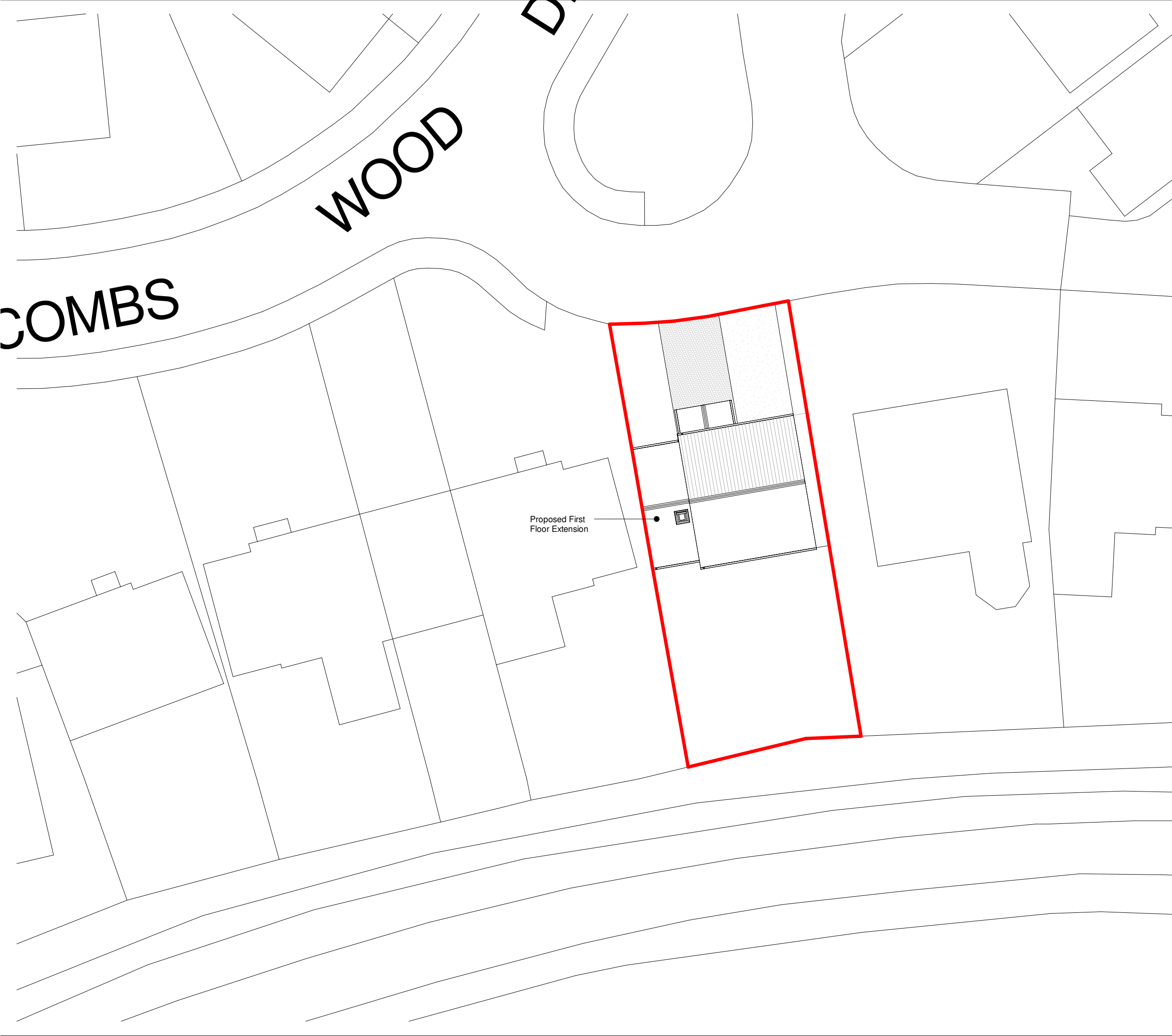

Proposed First Floor Extension

Client

Mrs Sue Turner

Project

18 Combs Wood Drive, Stowmarket, IP14 2RJ

Title

Block Plan As Proposed

Project N°

Drawing N°

Revision

0253 -0101

P01

Scale - unless otherwise stated

Issued For

1 : 200

@ A3

PRELIMINARY



Bright Architecture Ltd
629 Foxhall Rd
Ipswich
Suffolk
IP3 8NE

t: 07714822411
e:joe@brightarchitecture.co.uk

BRIGHT ARCHITECTURE