

# Existing Site Plan

North  
(Indicative)

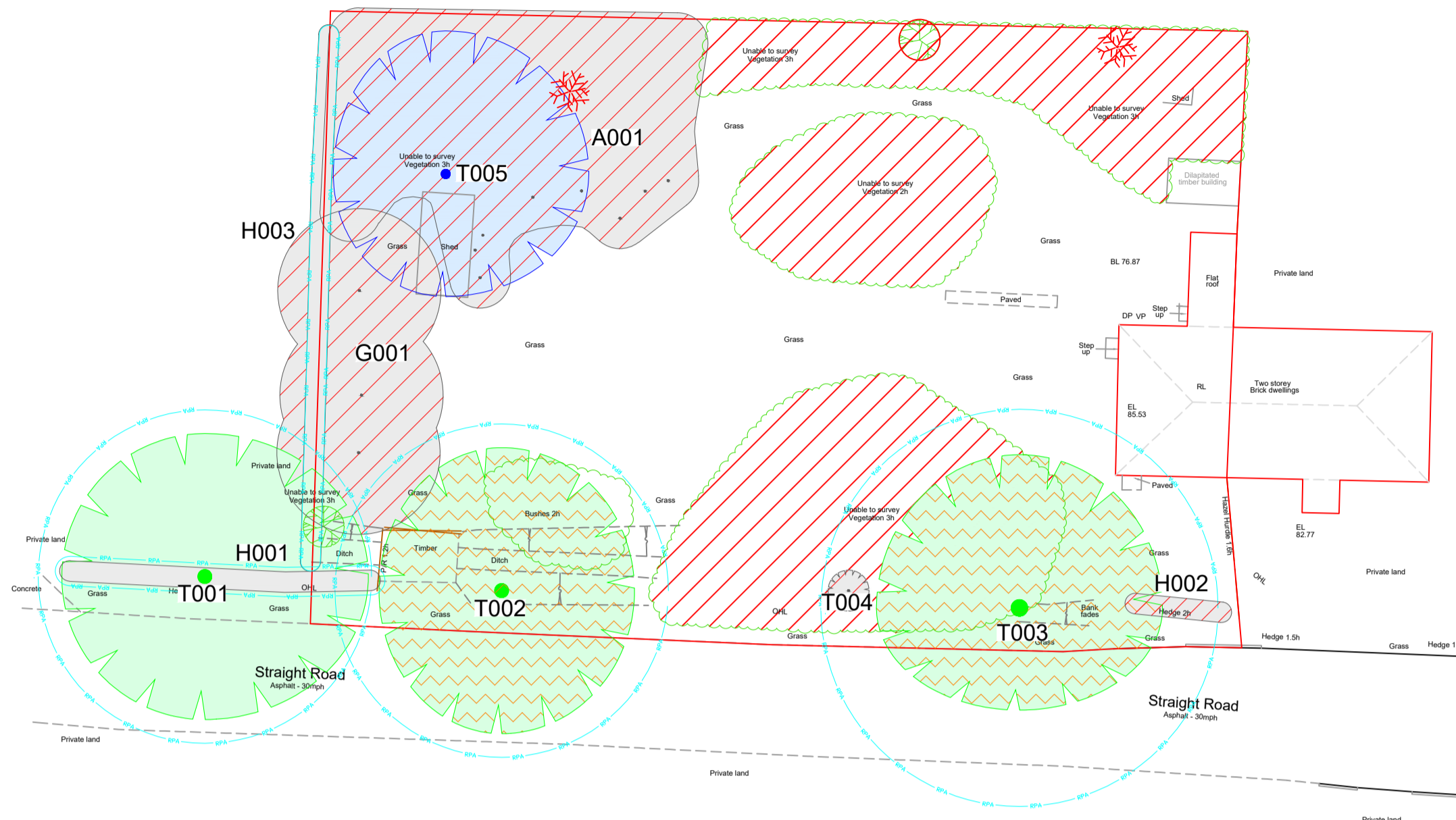
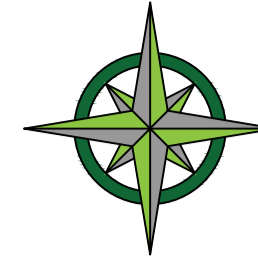

## TREE PROTECTION STATUS

Hayden's sourced TPO & Conservation Area status from the Local Planning Authority's Online Mapping System on 21/09/2023.

We were informed that:

- TPO's are present on site
- The site is not located within a conservation area

We would advise it prudent that before any tree work commences, this is checked directly with the Local Planning Authority to confirm that their online mapping system is definitive.

### CATEGORY AND DEFINITION

Trees unsuitable for retention	
Category U	Those in such condition that they cannot realistically be retained as living trees in the current land use for longer than 10 years
Trees to be considered for retention	
Category A	Trees of high quality with an estimated remaining life expectancy of at least 40 years
Category B	Trees of moderate quality with an estimated remaining life expectancy of at least 20 years
Category C	Trees of low quality with an estimated remaining life expectancy of at least 10 years, or young trees with a stem diameter below 150mm

### NOTE:

Hayden's Arboricultural Consultants were provided with a Topographical Survey but these do not always show the positions of all the trees/features on site. The locations of any additional features have been fixed using GPS. As such the position of the trees/landscape features should not be taken as exact but gives a fair distribution of their locations on site.

### LEGEND

	Existing Tree/Feature BS 5837:2012 Category A
	Existing Tree/Feature to be crown lifted to allow for development
	Existing Tree/Feature BS 5837:2012 Category B
	Existing Tree/Feature to be removed to allow for development BS 5837:2012 Category B
	Existing Tree/Feature BS 5837:2012 Category C
	Existing Tree/Feature to be removed to allow for development BS 5837:2012 Category C
	Line of Root Protection Area (RPA) - calculated following guidelines set in BS 5837:2012
	Additional feature which doesn't meet BS 5837:2012 categorisation to be removed for development
	Dead or Dying Tree
	Proposed development within & close to the RPA to be constructed following the No Dig Specification
	Line of proposed Root Pruning
	Area of temporary Ground Protection
	Line of proposed temporary protective barrier

# Proposed Site Plan

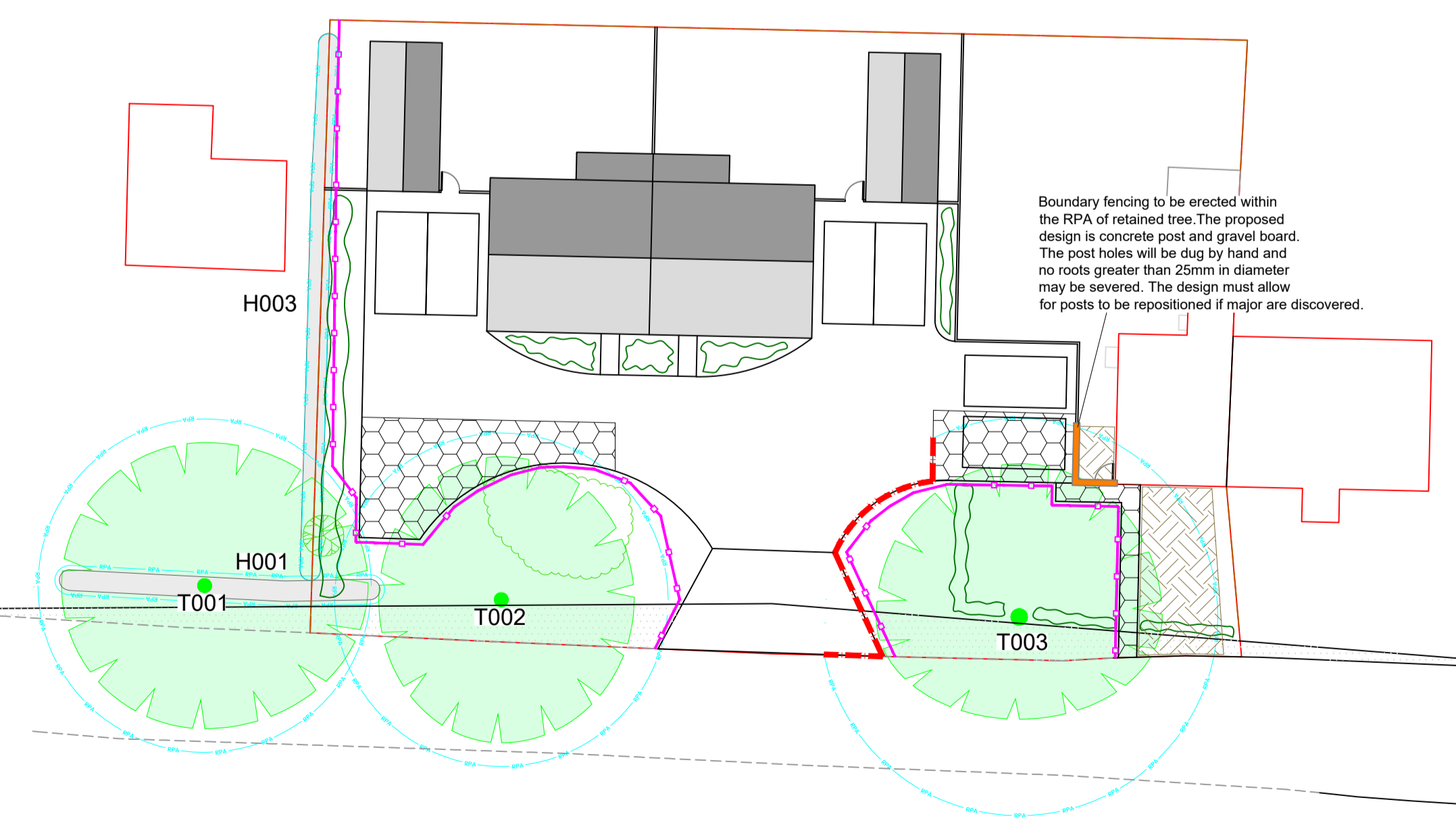

Boundary fencing to be erected within the RPA of retained tree. The proposed design is concrete post and gravel board. The post holes will be dug by hand and no roots greater than 25mm in diameter may be severed. The design must allow for posts to be repositioned if major are discovered.

27/10/23 JF Based on 60575/PLS-01 and 2023317 (02) Proposed site plan

Rev: Date: By: Revision:

The position, condition, and dimensions of the trees are based on a site survey undertaken on 15/09/23

"The original of this drawing was produced in colour - a monochrome copy should not be relied upon"

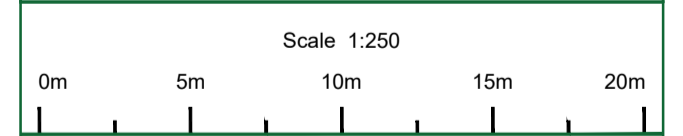

© HAYDEN'S 2023  
5 Moseleys Farm Business Centre, Fornham All Saints, Bury St Edmunds, Suffolk, IP28 6JY.  
Head Office: 01284 765391  
Southern Office: 01722 657423

www.treesurveys.co.uk Email: info@treesurveys.co.uk

Client: James Bailey Planning Ltd Drawing Title: Prelim AIA

Site: 2 School House, Straight Road, Battisford, Stowmarket, IP14 2HR

Date: 27/10/23 Drawn By: JF Cad File Ref: C:\Pro\10498-D-AIA.dwg

Scale: 1:250 (A2) Checked By: MP Drawing No: 10498-D-AIA Rev: -