

Please do not scale from this drawing.
All dimensions should be checked on site prior to commencing construction work.
If in doubt please ask.

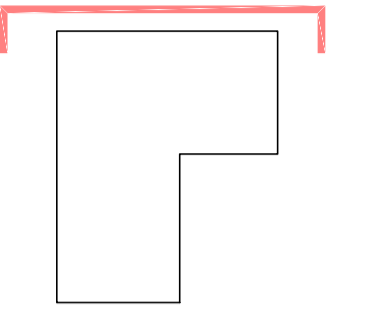

OFFICE

PROPOSED DEVELOPMENT

BLYTHWOOD STREET

BOUNDARY

BOUNDARY



KEY

- 1 Sandstone - Ashler finish - Blonde
- 2 Sandstone - Rusticated finish - Blonde
- 3 Standing seam metal - Grey
- 4 Standing seam feature dormers - Grey
- 5 Metal balustrade - Grey
- 6 PPC aluminium window - Grey
- 7 Facing brick - White
- 8 Glazing with openable window
- 9 PPC aluminium cladding - Grey
- 10 Party Wall Blockwork

| Status | Rev | Description | Author | Check | Date |
|------------------|-----|-------------|--------|-------|------|
| REVISIONS | | | | | |

mosaic
architecture + design

3rd Floor
226 West George Street
Glasgow
G2 2PQ
t: 0141 554 6977
e: office@mosaic-ad.com
w: www.mosaic-ad.com
Client
COURIE INVESTMENTS

Job Title
PBSA DEVELOPMENT
249 WEST GEORGE STREET
GLASGOW

Drawing Title
NORTH ELEVATION
AS PROPOSED

| Scale @ A1 | Date | Drawn By | Checked |
|------------|--------|----------|---------|
| 1:100 | OCT 23 | DC | NH |

| Project | Originator | System | Level | Type | Discipline | Classification | No |
|-----------------------------|------------|--------|-------|------|------------|----------------|----|
| 22004-MOS-ZZ-ZZ-DR-A-10-200 | | | | | | | |

PLANNING

NORTH ELEVATION - AS PROPOSED

