

of  
 being hollow  
 dovetail self.  
 being.  
 both at 18ccs.  
 upper ties at 18ccs  
 hanging posts at 18ccs.  
 main ties  
 fibreglass quilt.

the block external  
 Drydash finish,  
 red internally with  
 sanded planks board  
 over.

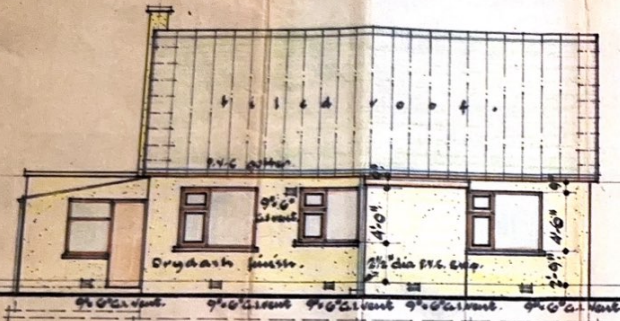

• SOUTH  
 • ELEVATION •

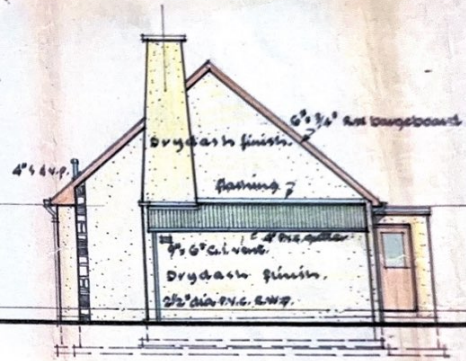

• WEST  
 • ELEVATION •

NOTE:-

- 0-28. All drainage to be carried to the entire satisfaction of the local sanitary inspector.
- 0-12. All building works to be carried out in accordance with Building Standards (Scotland) Regulations 1963.

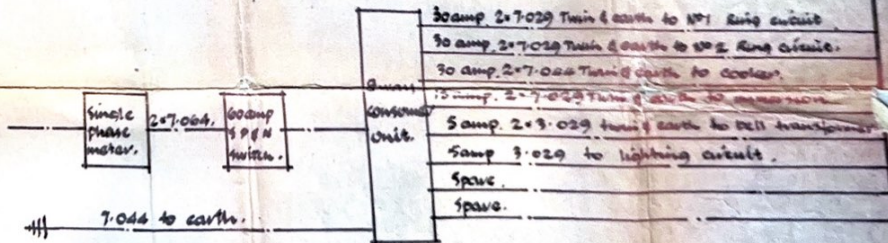
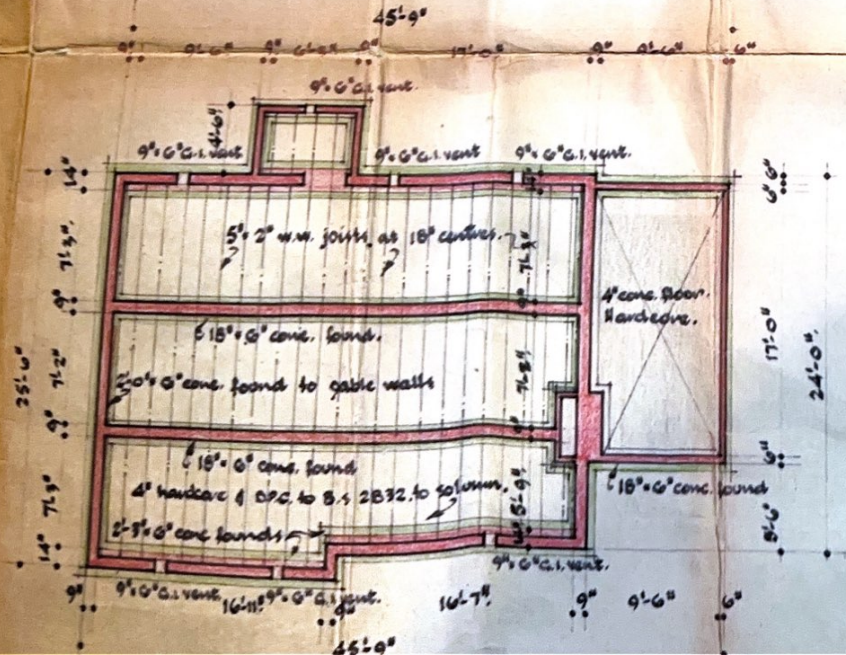

• ELECTRICAL SCHEMATIC DIAGRAM •

