

218050 N

218000 N

611600 E

611600 E

611650 E

611650 E

611700 E

611700 E

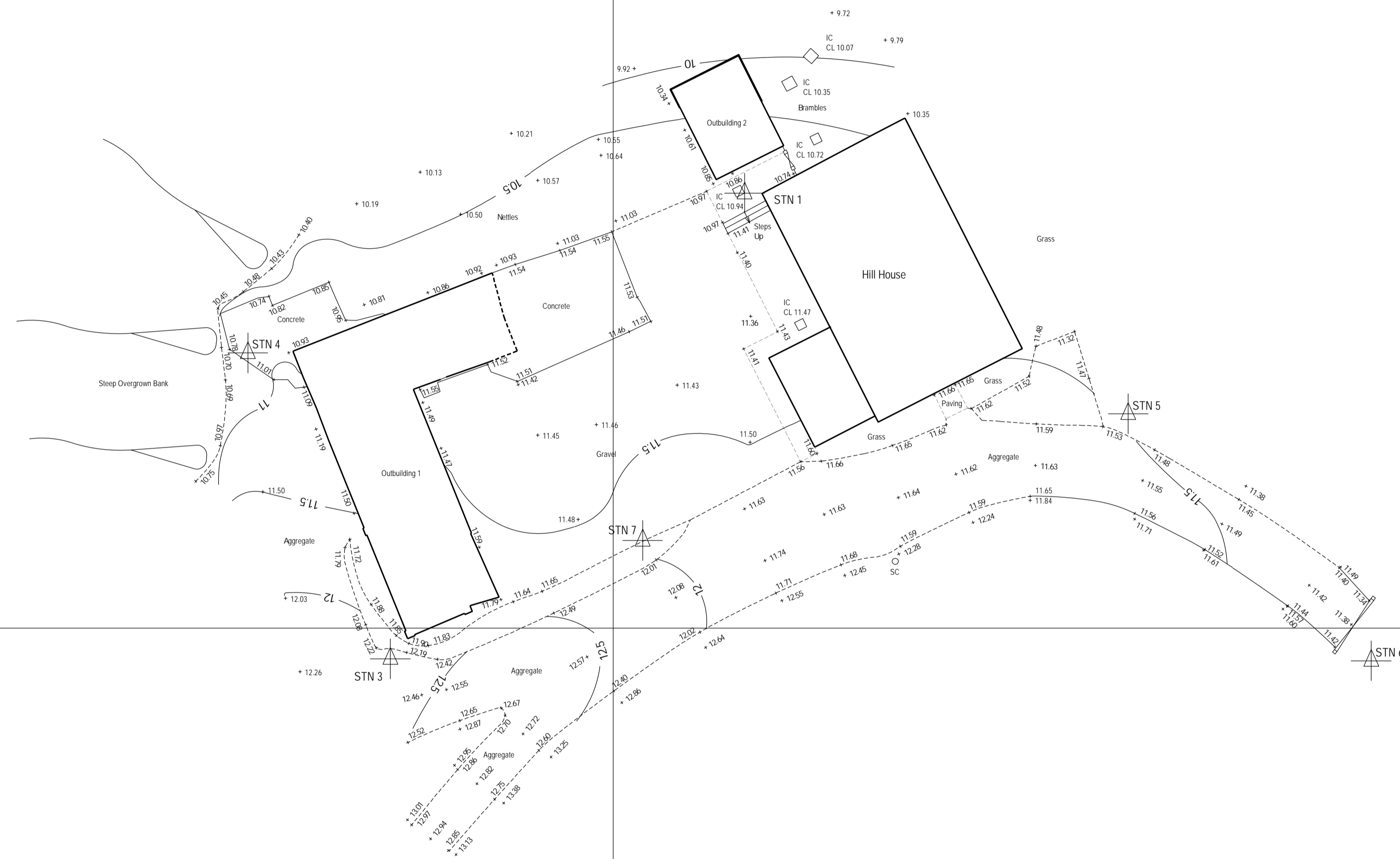

Control Schedule			
Stn No.	Easting	Northing	Level
1	611657.811	218025.876	10.931
3	611636.741	217998.182	12.219
4	611628.263	218016.379	10.901
5	611680.635	218012.753	11.504
6	611695.091	217998.066	11.397
7	611651.749	218005.224	11.650

Station 7 has O.S. National Grid co-ordinates based on the National GPS network using static GPS observations. All other stations are based on a plane grid with an origin at Station 7 and preserving the O.S. National Grid rotation but with O.S. scale factor removed.

CONTROL DATA
 Survey stations: STN
 Boundary posts: BP

LEVEL DATA
 Spot levels: +43.62
 Contours: 43
 Steep slopes: (Symbol)

TREES
 1.4.7 Girth (Circumference), spread (radius), height
 Cmp Clump
 Trees shown on this drawing have been identified to the best of the surveyor's ability. Where guaranteed identification of tree species may become important in the project design we would strongly recommend that the services of a specialist arboriculturist be employed. It should be noted that Randall Surveys LLP are not specialists in the field of tree identification.
 Datum used: Newlyn. All units are metric.

FEATURES
 Fences shown thus: (Symbol)
 Walls shown thus: (Symbol)
 Hedges shown thus: (Symbol)
 Undefined Boundary: (Symbol)
 Gates: (Symbol)

OVERHEAD CABLES
 British Telecom: (Symbol)
 Electric: (Symbol)

FENCE TYPES
 BMW Barbed wire
 CB Chain linked
 CI Chain link
 CP Chestnut paling
 CW Chicken wire
 IR Iron railing
 PIF Picket fence
 PIR Post and rail
 PW Post and wire
 WPF Wooden fence

ABBREVIATIONS

BB Bekeisha beacon	CNT Could not trace	G Gully	PM Parking meter	SVP Soil vent pipe
BD Back drop	CPL Casing level	GV Gas valve	PS Paving slab	TCP Telephone call box
BH Borehole	DC Drainage Channel	IC Inspection cover	RC Rising cable	TCP Tactile paving
Bo Bollard	DK Drop kerb	IL Invert level	RE Rodding eye	TL Traffic light
BT British Telecom cover	EJB Elec. Junction box	JB Junction box	RI Retaining	TP Telegraph pole
BTJB BT Junction box	ER End of record	KO Kerb outlet	RS Road sign	TPL Top of pipe level
CATV Cable TV cover	EOT End of trace	LP Lamp post	RWP Rain water pipe	TS Traffic signal
CDP Cable draw pit	EP Electricity pole	MH Manhole	SC Stopcock	VP Vent pipe
CL Cover level	ER Earth rod	MZ Marker	SL Sump level	WL Water level
CM Cable marker	FB Flower bed	NB Name board	SP Sign post	WO Washout
CNF Could not find	FI Fire hydrant	OF Outfall	ST Stand pipe	WM Water meter
CNL Could not lift	FL Floodlight	PB Post box	SV Stop valve	WSC Water stopcock

IMPORTANT NOTES

The details and information shown hereon relating to underground drains, cables etc. are as obtained by normal field survey observations. Cover and manhole details shown on this drawing have been obtained by observation and measurement from the surface and as such cannot be guaranteed. Where precise sewer details will be critical to the project design we would recommend that entry into the chamber be undertaken using a specialist team, appropriately qualified for confined space entry. These teams can be supplied upon request.

The pipe and cable routes shown on this drawing have been located using electronic surface detection equipment and/or ground penetrating radar, no trial holes have been dug in order to confirm their presence and position. Whilst the information presented is believed to be correct at the time of the survey due care must be taken when any excavation is undertaken on the site. Trace depths are quoted in metres.

The portrayal of a service on this drawing may indicate the presence of multiple cables/pipes. The exact number will only be indicated where this could be accurately determined.

Hatching denotes an area containing possible services which could not be traced electronically or by GPR, where used, but have been extracted from service drawings.

Where the precise location and/or depth of a service is critical to design and/or construction, trial holes are recommended to confirm the details provided on this drawing.

This drawing should be read in conjunction with any record drawings available from the statutory authorities.

NOTES

- Station 7 has O.S. National Grid co-ordinates based on the National GPS network using static GPS observations. All other stations are based on a plane grid with an origin at Station 7 and preserving the O.S. National Grid rotation but with O.S. scale factor removed.
- Levels are related to the O.S. National GPS network.
- Refer to Drawing No. 17396/TM2 for the Elevations.

PLAN PRODUCTION BY

RANDALL SURVEYS LLP

SURVEY & DESIGN CENTRE
 HIGH STREET, BURES, SUFFOLK CO8 5HZ

Land and Hydrographic Surveyors
 Architectural Building Surveyors
 Underground Services Location



PROJECT NAME

HILL HOUSE, FLAG HILL

GREAT BENTLEY CO7 8RE

DRAWING TITLE

EXISTING SITE LAYOUT

SCALE	1/200	DRAWN	TJM	PAPER SIZE	A1
DATE	August 2023	CHECKED	JKW	REVISION	
Dwg No. 17396/TM/1					