

CDM 2015  
 © Crown copyright and database rights 2018.  
 The Construction (Design and Management) Regulations 2015 (CDM 2015) makes a distinction between domestic and commercial clients and outlines the duties you, as client, have under Health and Safety Law (HSE).  
 These duties can be found at:  
<http://www.hse.gov.uk/construction/cdm/2015/responsibilities.htm>  
 It is your responsibility as client to make yourself aware of your role within CDM 2015 and act accordingly.

Do not scale from this drawing electronically or manually, use written dimensions only.  
 All dimensions are in millimeters unless stated otherwise.  
 This drawing is produced for use in this project only and may not be used for any other purpose. LA Robinson Architectural Services Ltd accept no liability for the use of this drawing other than the purpose for which it was intended in connection with this project.  
 This drawing may not be reproduced in any form without prior written agreement from LA Robinson Architectural Services Ltd. All dimensions are to be checked on site and L A Robinson Ltd informed of any discrepancies.

Registered in England and Wales Number: 11073088  
 Registered Office: 20 Southview, School Lane, Surlingham, Norwich NR14 7DH.

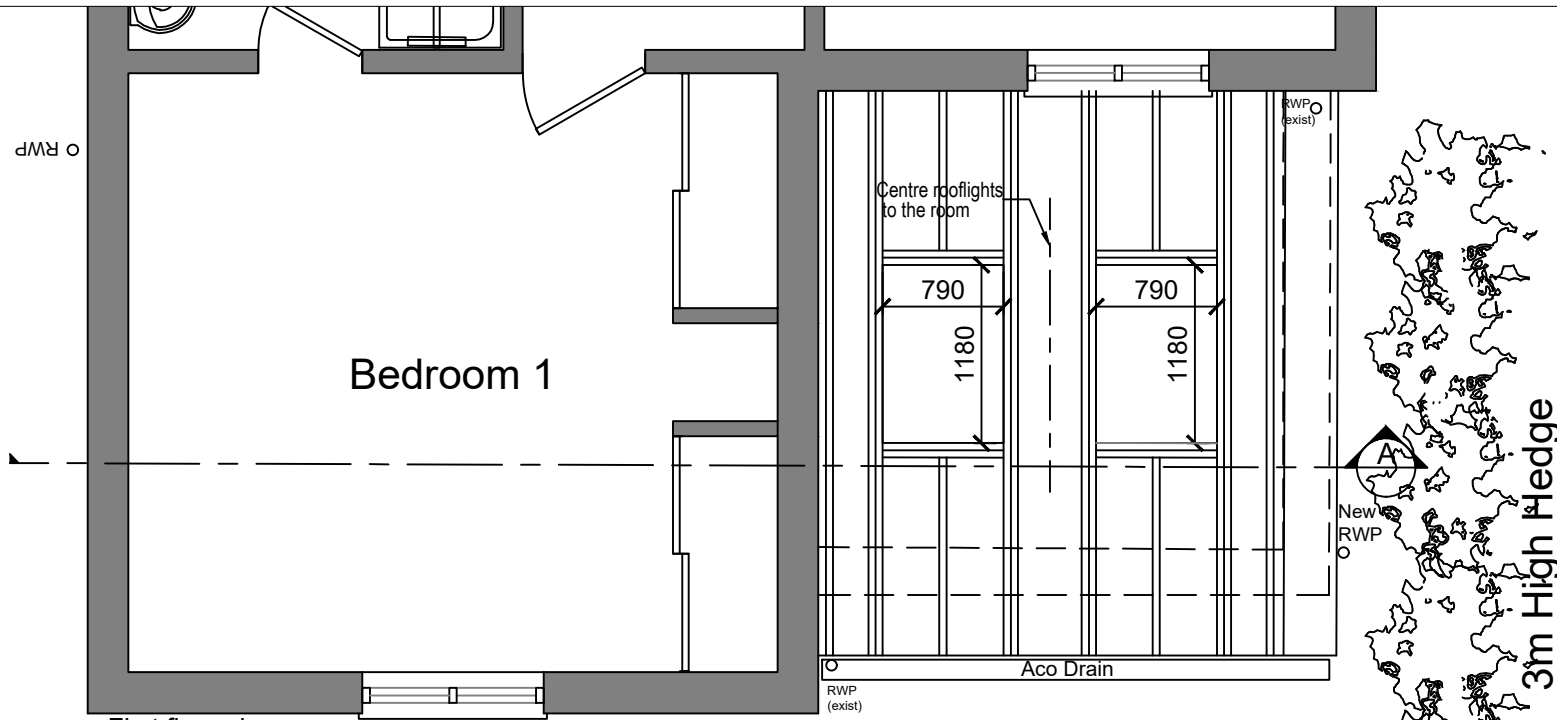

First floor plan  
 1:50

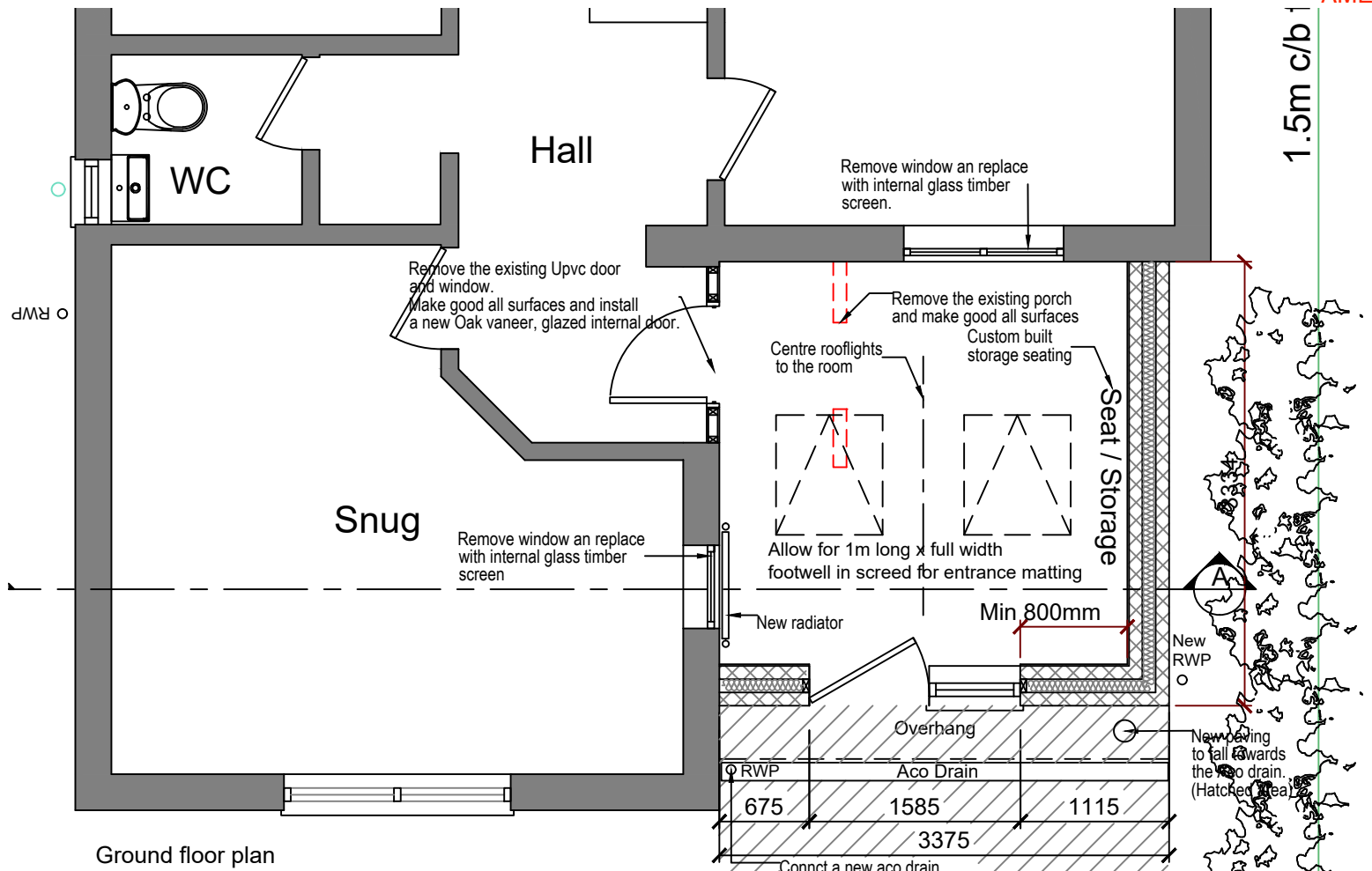
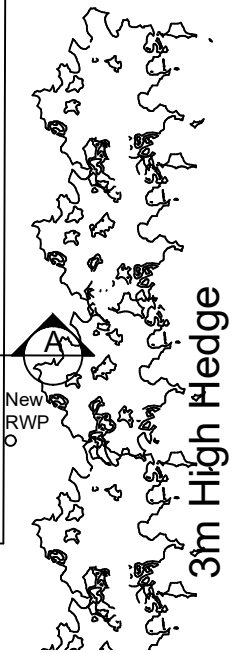

Ground floor plan  
 1:50

AMENDMENT: Roof tiles to be SLATE not matching existing



Roof:  
**To achieve a 'U' value of 0.15W/m2K**  
 100mm rigid PIR Insulation between and 50mm rigid insulation under the rafters.  
 Tiles to match existing over counter batten, batten and breather membrane.

NOTE:  
 Continues Insulation from wall to roof at eaves level.

External walls:  
**To achieve a U-Value 0.18W/m2K**  
 100mm blockwork  
 110mm cavity / or 150mm depends on insulation type  
 85mm Rigid insulation with clear cavity or fully fill mineral wool  
 100mm inner blockwork  
 Hardwall plaster finish

New Aco Drain connected to existing surface water drainage

Section A-A  
 1:50

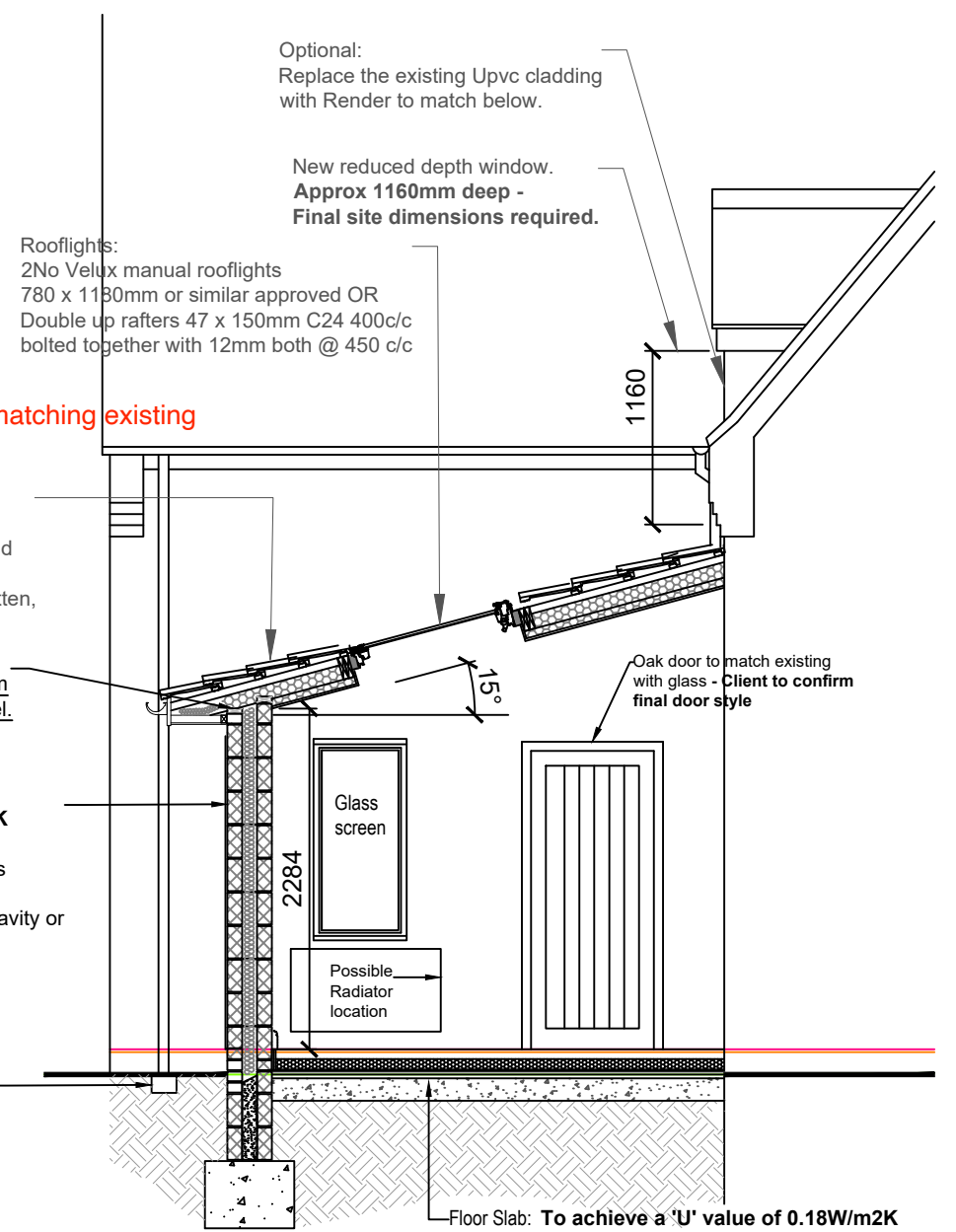

Floor Slab: **To achieve a 'U' value of 0.18W/m2K**  
 Floor finish to match existing F.F.L.  
 65mm Screed, 500g separating layer, 100mm rigid insulation & perimeter insulation, 1200g DPM over 150mm ground bearing slab with 25mm cover, 25mm sand blinding, over 150mm well compacted Type 1 hardc

**LA Robinson**  
 Architectural Services Ltd

20 Southview  
 School Lane  
 Surlingham  
 Norwich  
 Norfolk  
 NR14 7DH  
 louise@larobinson.co.uk



Address: Bay Tree House  
 Mill Road  
 Surlingham  
 Norwich  
 NR14 7AF

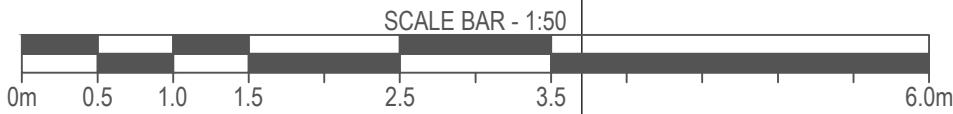

A3

Client:	Tony & Frances Goswell		
Project:	Front entrance extension		
Title:	Proposed floor plans, roof plan & Section		
Job No:	249	Drg No:	
SCALE	1:50		
DATE	August 2023		
		010	Rev: