

READ THIS FIRST

Note for Contractors

This drawing should be considered along with the risk information contained in the CDM Pre Construction Information. This information will include details of the SIGNIFICANT risks which LDA Design has identified which may arise from constructing their designs shown on this drawing. A Competent Contractor should be aware of the typical risks associated with doing this work.

Note for Workers

DO NOT START YOUR WORK unless you know the Risks and Controls relating to the work on this drawing (including SAFE SEQUENCES OF WORK and EQUIPMENT).

Do not issue copies of parts of this drawing without the above Note for Workers (unless you are sure that the Workers can undertake the work safely).

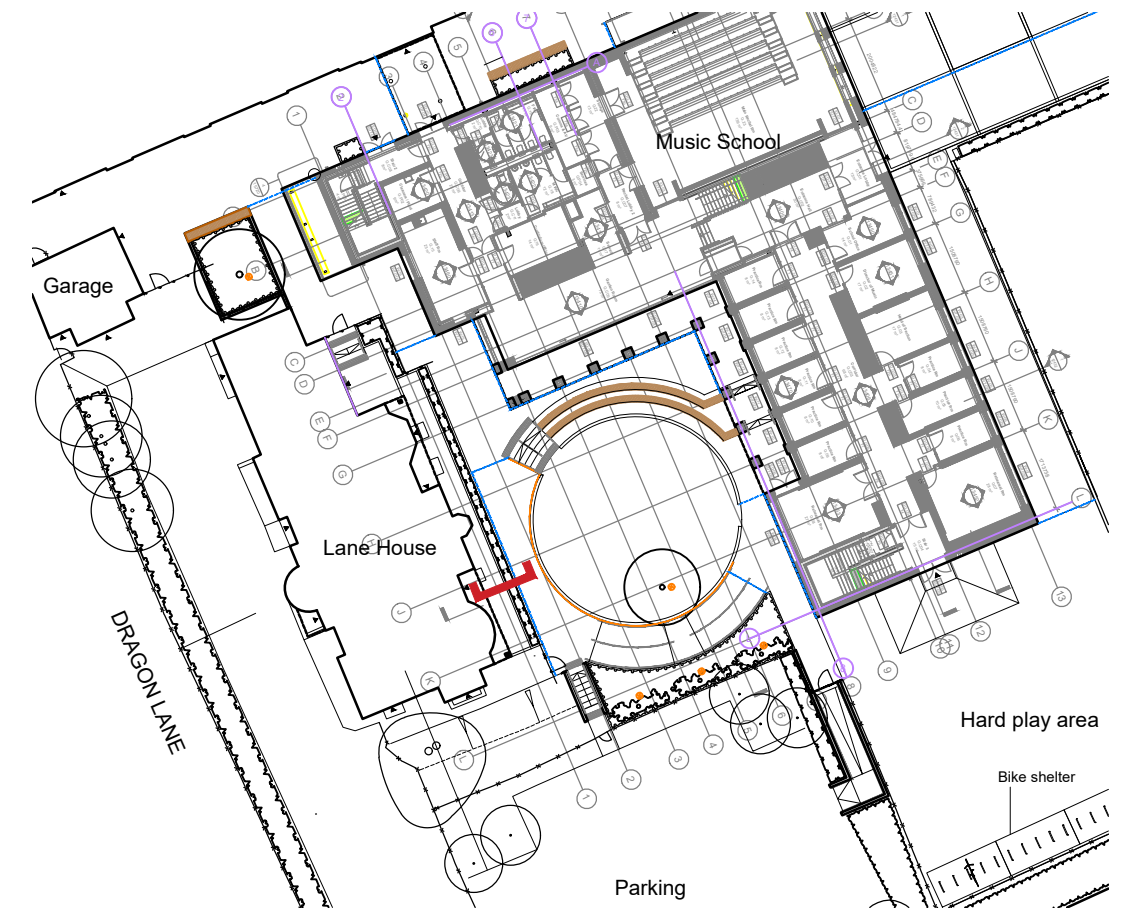

02 KEY PLAN
315

SCALE 1: 500

REV.	DESCRIPTION	APP.	DATE
E	Paving spec to Lane House	DW	12.09.2023
D	Updated fence details	DW	05.06.2023
C	Lane House path levels as existing; construction issue	DW	23.04.2023
B	Levels and drainage	DW	15.12.2022
A	Railing specification	DW	11.08.2020

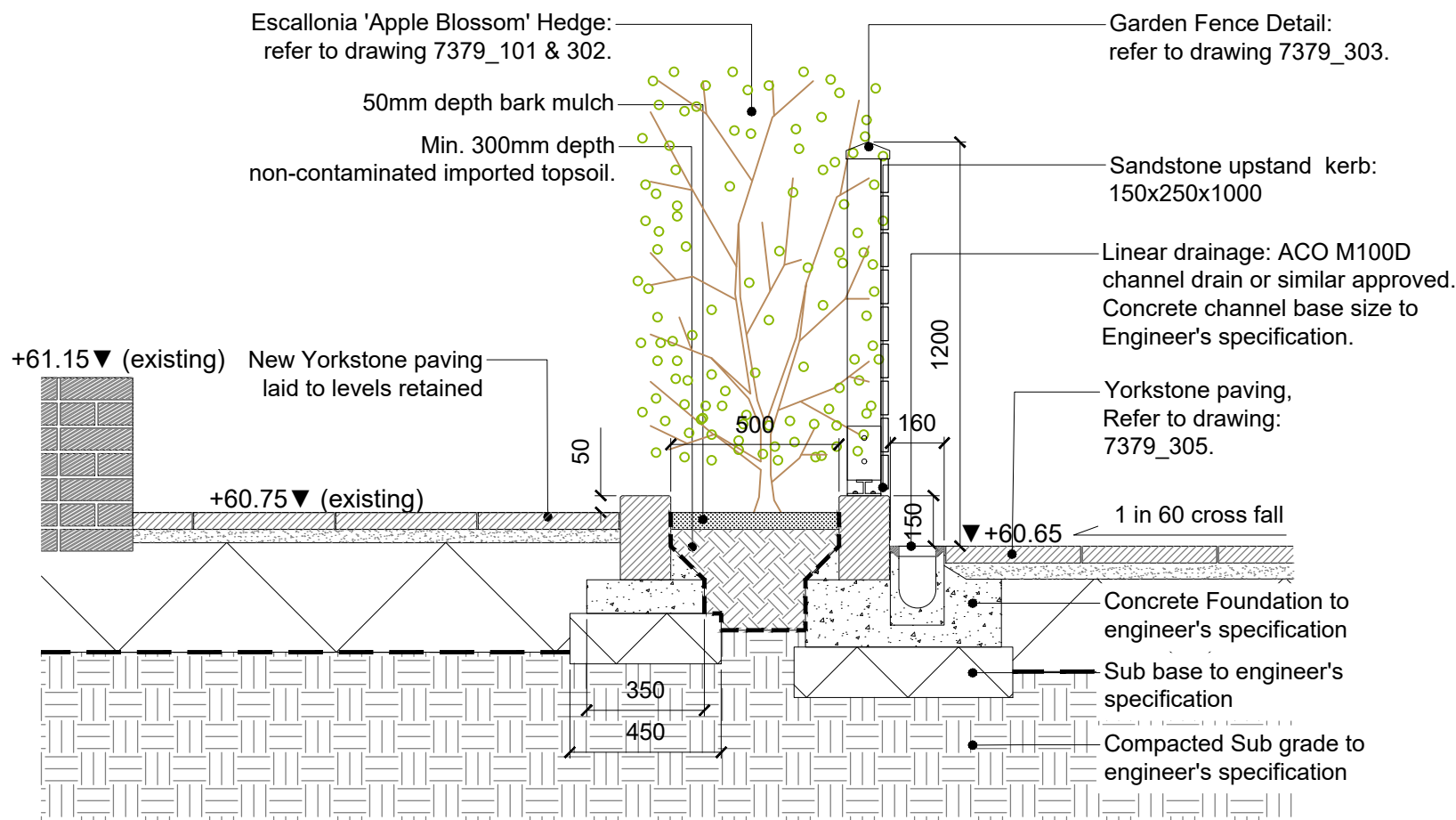

01 LANE HOUSE EASTERN EDGE TREATMENT DETAIL
315 SECTION SCALE 1: 20

LDĀDESIGN

PROJECT TITLE
DRAGON SCHOOL

DRAWING TITLE
Typical Details
Lane House Eastern Edge Treatment Detail

ISSUED BY	Oxford	T: 01865 887 050
DATE	June 2020	DRAWN KM
SCALE@A3	1:20	CHECKED NT
STATUS	Construction	APPROVED DW

DWG. NO 7379_315 E

No dimensions are to be scaled from this drawing. All dimensions are to be checked on site. Area measurements for indicative purposes only.

© LDA Design Consulting Ltd. Quality Assured to BS EN ISO 9001 : 2015
Sources Ordnance Survey

