

2. All sizes to be checked on site prior to construction.
 3. This drawing is the copyright of the author.

- Key:**
- Proposed Resin Bound Driveways
 - Existing stone paving to be retained
 - Planter

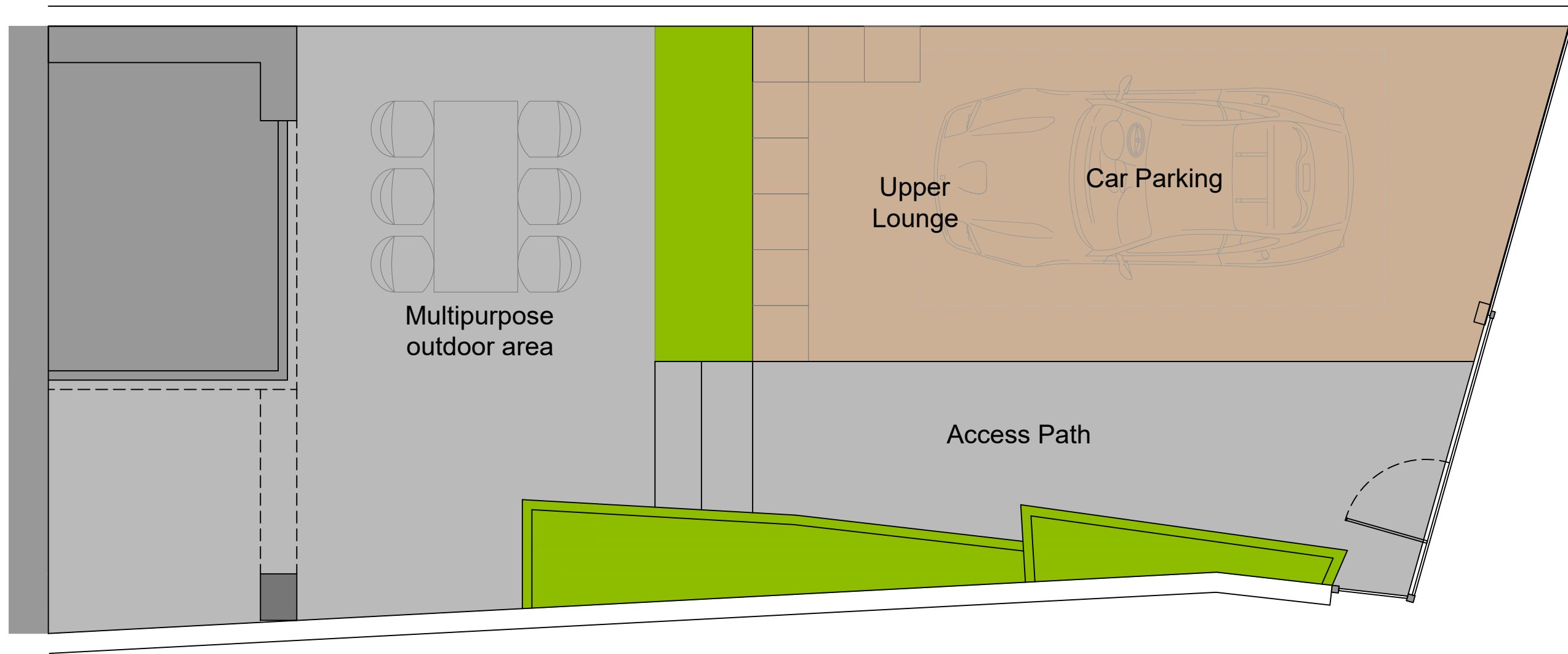

1 26.08.2023 PLANNING ISSUE KL

LEE STUDIO shooloong@me.com

28 Salmons Street, Glasgow, G22 5NZ. 07766 163 130

drawing 16 WESTBOURNE GARDENS original size A3
 Proposed Surface Finishes Plan

scale 1:50 drawn KL

date 26.08.2023 checked -

status PLANNING passed -

job no.	drawing no.	revision
2023-05	AL(0)007	1

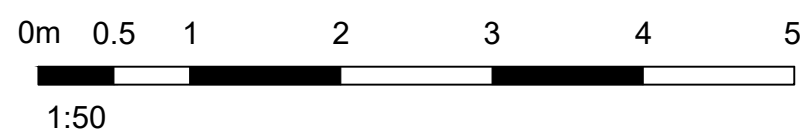
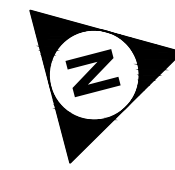

PROPOSED SURFACE FINISHES PLAN