

Proposed Plot Plan @ 1-200

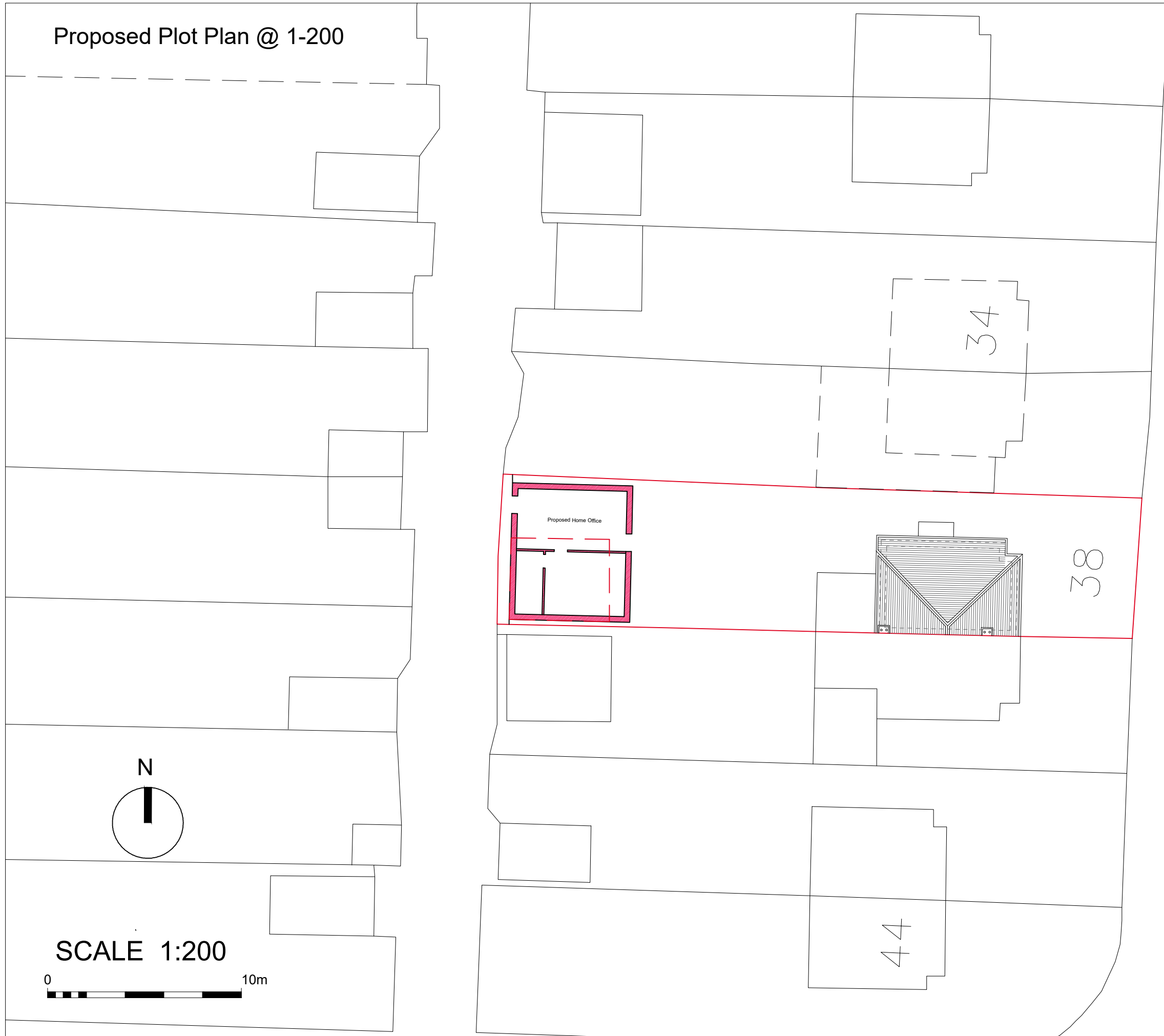

Copyright: This product is protected by the provision of the Copyright, Design and Patents Act 1988

NOTES.

CONTRACTORS MUST VERIFY ALL DIMENSIONS AT THE SITE BEFORE COMMENCING ANY WORK.



NO CONSTRUCTION WORK BEFORE LOCAL AUTHORITY CONSENT, PLANNING PERMISSION, BUILDING CONTROL APPROVAL AND STRUCTURAL ENGINEER CONFIRMATION.

ALL STRUCTURAL ELEMENTS INC. JOISTS, BEAMS AND COLUMNS TO BE CONFIRMED BY STRUCTURAL ENGINEER

ANY DISCREPANCIES TO BE REPORTED TO SEZ ASSOCIATES.

ALL DRAWINGS ARE TO BE READ IN CONJUNCTION WITH ALL RELEVANT DRAWINGS AND SPECIFICATIONS.

REVISIONS	BY	DATE
REV A		21/08/23

-  EXISTING WALL AND PARTITION
-  PROPOSED WALL AND PARTITION
-  BOUNDARY LINE

SEZ ASSOCIATES

5, MARYGOLD HOUSE, TAYLOR CLOSE, TW3 4BZ, HOUNSLOW
 Mob: + 44 (0) 7989697333 E-mail: svetlazana@yahoo.co.uk

CLIENT
ALTIN LLESHI

PROJECT
38 OAKCROFT ROAD KT9 1RH

TITLE

PROPOSED PLOT PLAN.		
FIRST ISSUE	DRAWN	CHECKED
20.07.2023	SB	SB
SCALE @ A1	SCALE @ A3	STAGE
	1:200	PLANNING
JOB NO	DRAWING NO	REVISION
KT38	PL-003	REV-A

Proposed Plot Plan
 Scale 1:200 @ A3

38 Oakcroft Road

Drawn by: DP
 Date: December 2020

Mary Hackett & Associates Ltd.

Creek Studio, 39 Creek Road, Hampton Court, East Molesey, KT8 9BE
 Tel: 020 8979 3660 Fax: 020 8979 3106

03

SCALE 1:200

