

APPLICATION NO: 20/03300/HOU  
 GRANTED 16TH FEBRUARY 2021

Copyright: This product is protected by the provision of the Copyright, Design and Patents Act 1988

NOTES:

CONTRACTORS MUST VERIFY ALL DIMENSIONS AT THE SITE BEFORE COMMENCING ANY WORK.

NO CONSTRUCTION WORK BEFORE LOCAL AUTHORITY CONSENT, PLANNING PERMISSION, BUILDING CONTROL APPROVAL AND STRUCTURAL ENGINEER CONFIRMATION.

ALL STRUCTURAL ELEMENTS INC. JOISTS, BEAMS AND COLUMNS TO BE CONFIRMED BY STRUCTURAL ENGINEER

ANY DISCREPANCIES TO BE REPORTED TO SEZ ASSOCIATES.

ALL DRAWINGS ARE TO BE READ IN CONJUNCTION WITH ALL RELEVANT DRAWINGS AND SPECIFICATIONS.

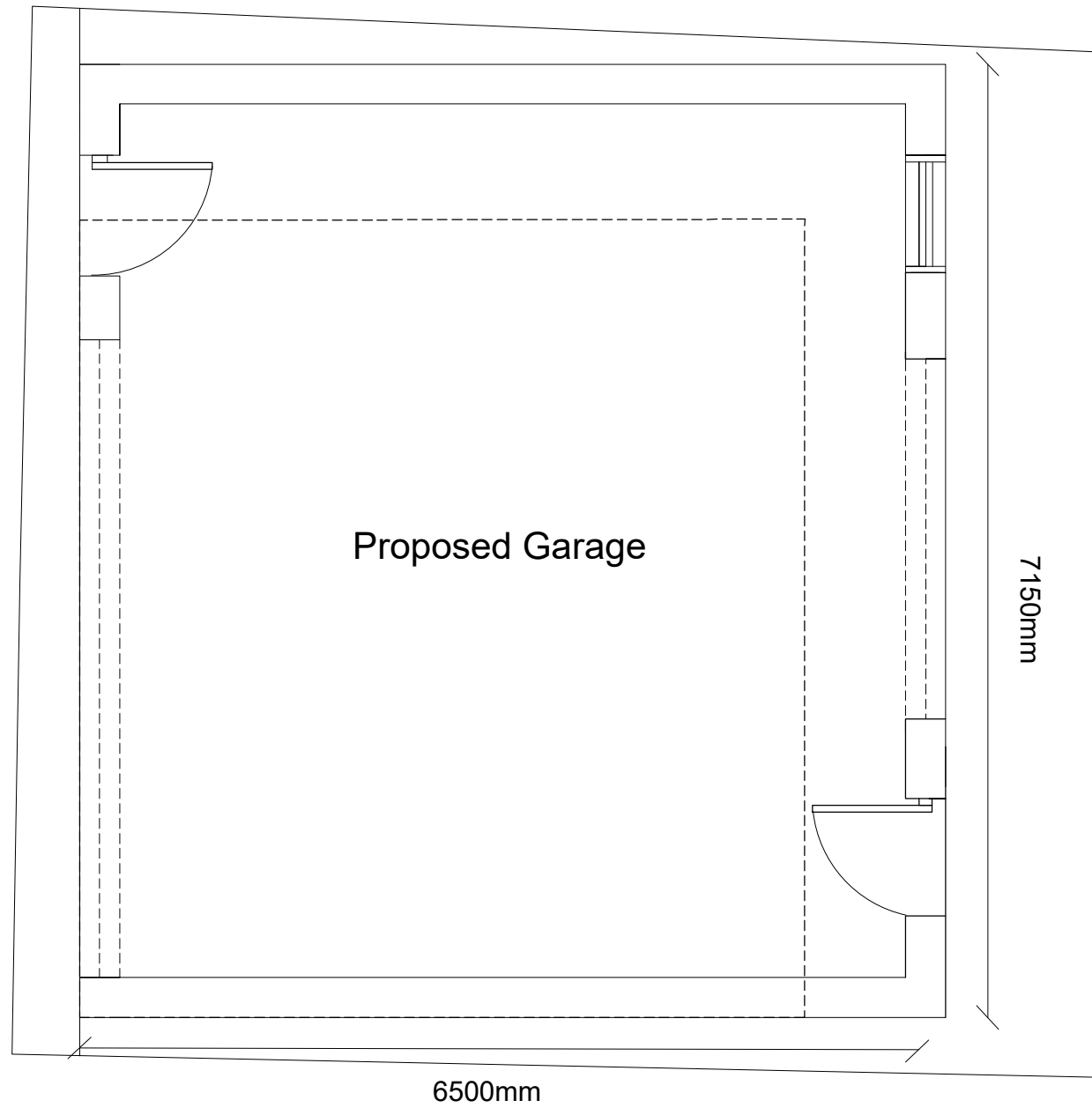

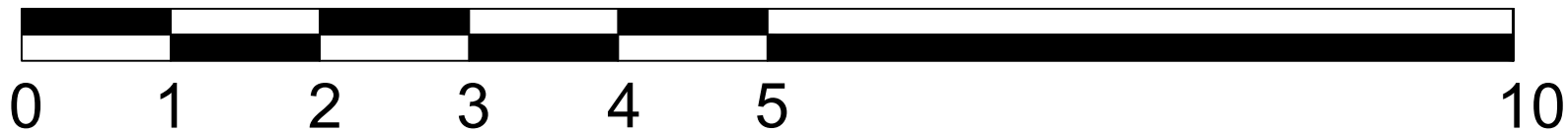
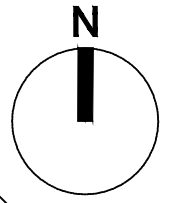
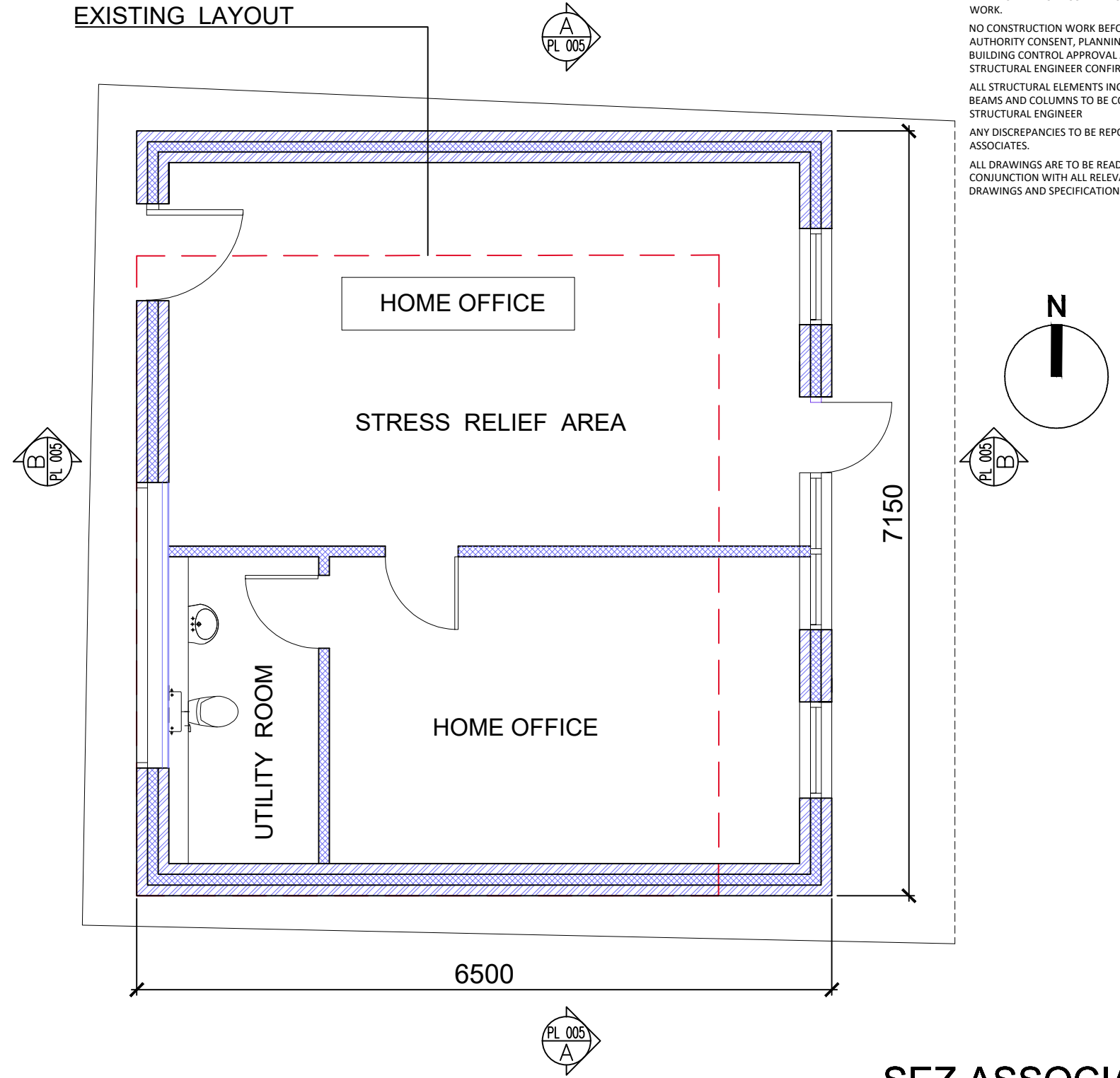

PROPOSED

EXISTING LAYOUT

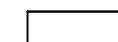

SCALE BAR 1:50

-  EXISTING WALL AND PARTITION
-  PROPOSED WALL AND PARTITION
-  EXISTING LAYOUT

REVISIONS	BY	DATE
REV	A	21/08/23

**SEZ ASSOCIATES**

5, MARYGOLD HOUSE, TAYLOR CLOSE, TW3 4BZ, HOUNSLOW  
 Mob: + 44 (0) 7989697333 E-mail: svetlazana@yahoo.co.uk

CLIENT

ALTIN LLESHI

PROJECT

38 OAKCROFT ROAD KT9 1RH

TITLE

APPROVED FLOOR PLAN.  
 PROPOSED FLOOR PLAN.

FIRST ISSUE	DRAWN	CHECKED
20.07.2023	SB	SB
SCALE @ A1	SCALE @ A3	STAGE
	1:50	PLANNING
JOB NO	DRAWING NO	REVISION
KT38	PL-007	REV-A