

**Circled Numbers:**

1. Attenuation basin on adjacent site.
2. Line of existing culvert.
3. Line of recently constructed 300Ø surface water sewer, installed within highway to bypass existing culvert.
4. Existing outfall into ditch (recently cleared).
5. Recently constructed inspection chamber for surface water sewer.
6. New sewage treatment plant for all plots, final size and location to be agreed with Building Control and specialist supplier.
7. Sample chamber.
8. Seasonal soakaway, slotted pipe in an infiltration trench for last 10m of the treated effluent discharge pipe with outfall into existing culvert.
9. Maintenance area for sewage treatment plant.
10. Protected orifice flow control chamber.
11. Attenuation cells.
12. Outfall to existing surface water drainage, upgraded if necessary, leading to ditch.

**LEGEND**

- FRL+52.800 FINISHED FLOOR LEVEL OF DWELLING
- FRL+51.800 FINISHED ROAD LEVEL
- 52.700 FINISHED GROUND LEVEL
- NEW FOUL DRAIN RUN
- NEW SURFACE WATER DRAIN RUN
- SEASONAL SOAKAWAY FOR LAST 10M OF TREATED EFFLUENT DISCHARGE PIPE
- NEW SEWAGE TREATMENT PLANT
- OUTFALL FROM SEWAGE TREATMENT PLANT
- EXISTING SURFACE WATER DRAIN RUN
- - - EXISTING DITCH
- - - EXISTING CULVERT
- PROTECTED ORIFICE FLOW CONTROL CHAMBER
- FULLY TANKED AND VENTED OFF-LINE ATTENUATION CELLS

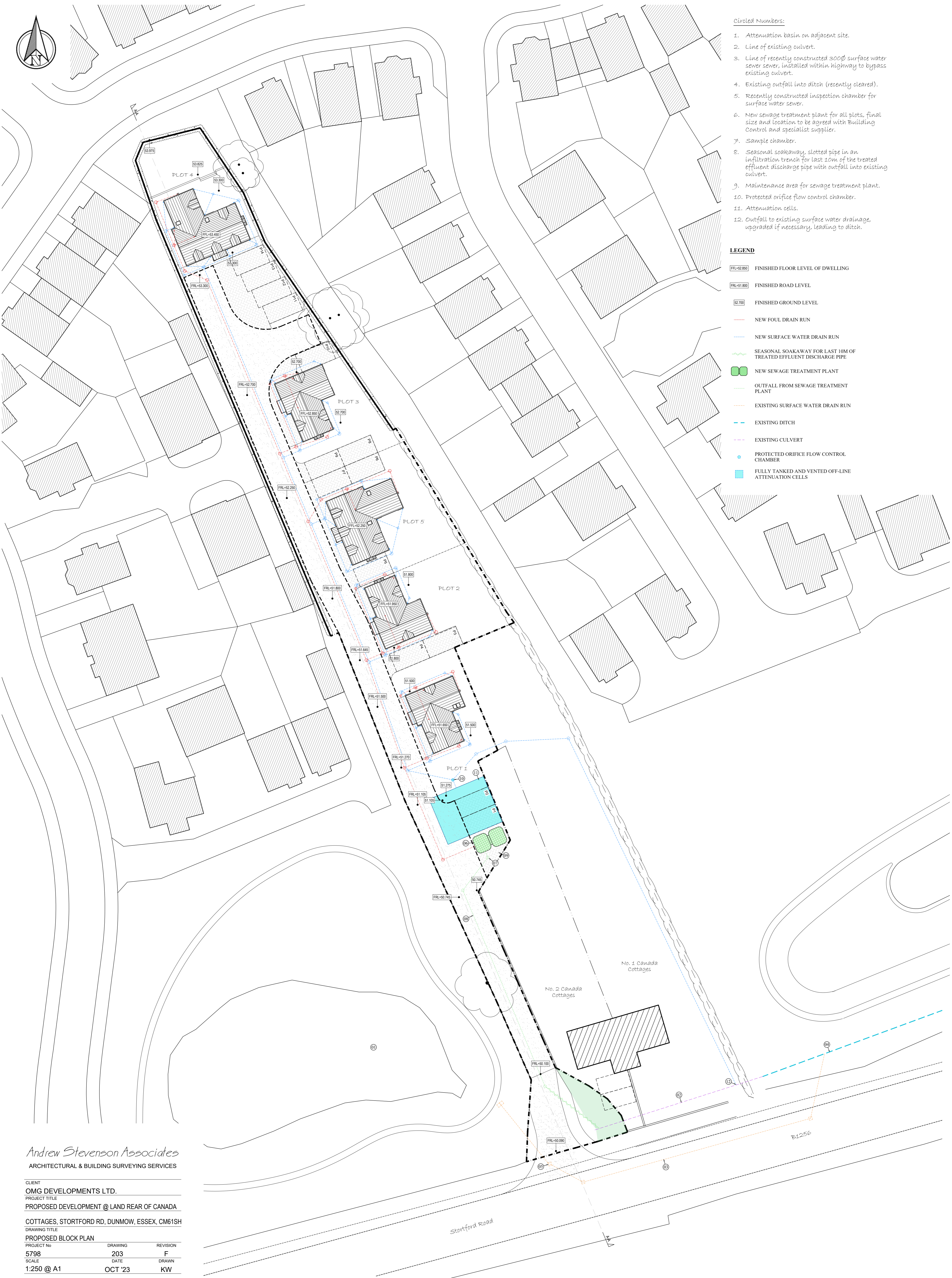

*Andrew Stevenson Associates*  
ARCHITECTURAL & BUILDING SURVEYING SERVICES

CLIENT  
OMG DEVELOPMENTS LTD.  
PROJECT TITLE  
PROPOSED DEVELOPMENT @ LAND REAR OF CANADA  
COTTAGES, STORTFORD RD, DUNMOW, ESSEX, CM61SH  
DRAWING TITLE  
PROPOSED BLOCK PLAN  
PROJECT No. 5798  
SCALE 1:250 @ A1  
DRAWING DATE 203  
REVISION F  
DRAWN BY KW  
DATE OCT '23

BIGODS HALL, BIGODS LANE, GREAT DUNMOW, ESSEX, CM6 3BE  
TEL: 01371 874807 EMAIL: design@asarics.co.uk

Scale @ 1:250 0 5m 10m 15m 20m