

No dimensions to be scaled from drawing.  
All dimensions to be checked on site.  
Any discrepancy to be notified immediately.



1:50 EXISTING SOUTH ELEVATION



1:50 PROPOSED SOUTH ELEVATION

New Svp to be installed alongside the existing cast iron rainwater pipe.  
Existing external wall light to be repositioned minimally to allow fitting of new cast iron Svp.  
New 100mm diam traditional cast iron soil vent pipe installed to side of building. Base of the Svp connected into the underground drainage at side of building. Svp to extend up to above door lintel level and turned in through the wall, all formed using traditional cast iron pipework and brackets. Full extent of the Svp to be painted black.

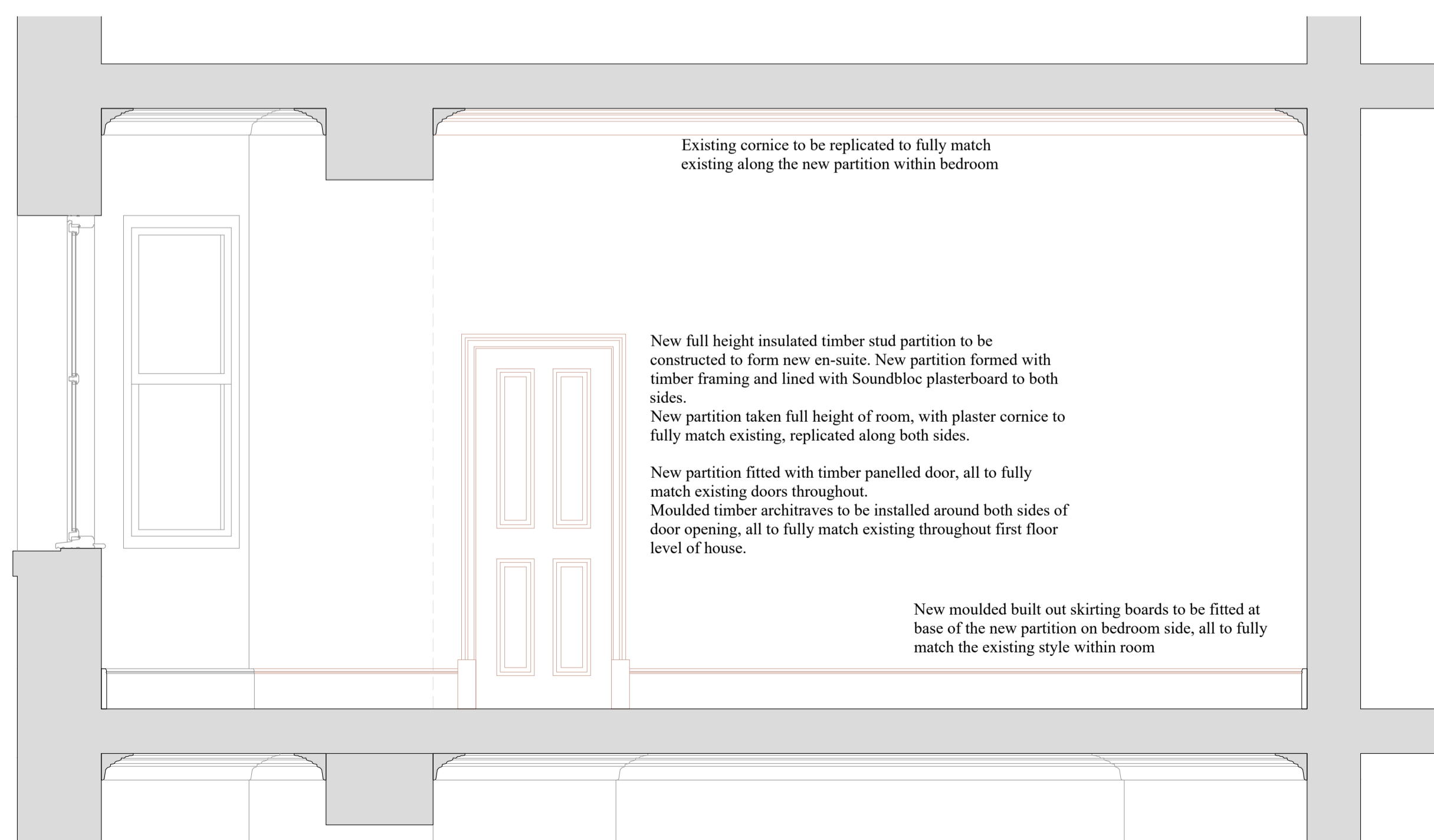

1:25 PROPOSED INTERNAL ELEVATION OF NEW PARTITION FROM BEDROOM

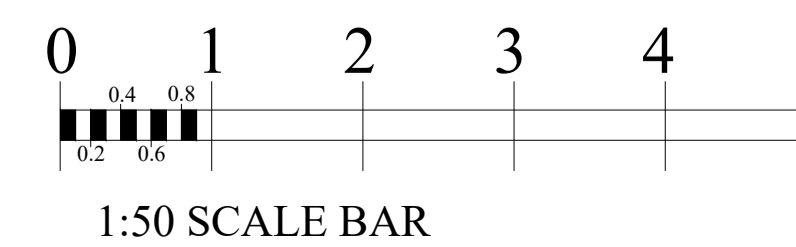

Proposed Alterations to Dwelling at  
1 Abbeylands, High Street  
Dunbar, East Lothian, EH42 1EH  
Elevations and Internal Elevation  
1:50 1:25  
Oct 23

**ARCTEC  
BUILD LTD**

4 The Maltings  
Haddington  
EAST LOTHIAN  
EH41 4EF

Mob. 07715 049752  
Andrew.dodds1@btopenworld.com

25623 - 03